



Spindle moulder tooling

quality & service - direct to you



tel: 01580 890500
fax: 01580 890222
www.wealdentool.com
sales@wealdentool.com

catalogue f007 2021/22



Quality products - quality service

PROFESSIONAL RANGE SPINDLE MOULDER TOOLING

This catalogue lists our stock range of cutterheads, profile knives, limitors and other blocks. All of the profile knives are shown full size and have dimensional details where appropriate.

CARDS ACCEPTED:



CONTACT DETAILS

PHONE **01580 890500**
FAX **01580 890222**
POST Wealden Tool Co. Ltd.,
2 Clinton Business Centre,
Lodge Road,
Staplehurst,
Kent
TN12 0QF (registered address)

ORDERING

All prices for items in this catalogue are listed in page number order on a separate price list, a copy of which is included with this catalogue. The price list is also available on our web site. **Please note that a small order charge of £2.00 will be added to orders under £15 in value to help towards the high cost of invoicing and delivery.**

U.K. CUSTOMERS:

Prices shown on the enclosed U.K. price list include VAT at the current rate. Postage on router cutters and drills is free to U.K. addresses.

Terms are payment with order, unless otherwise agreed. Cheques should be made payable to *WEALDEN TOOL COMPANY LIMITED* and crossed. Credit & debit card holders may telephone our credit card orderline. Orders received by 3.30pm will be despatched the same day. Trade accounts may be opened: see below. Goods will be supplied against Government, school or local authority orders, which must be posted, faxed or emailed to us.

EEC CUSTOMERS:

Please use VAT inclusive price list and add postage as detailed in the EEC postal charges leaflet which will be supplied on request. Customers who are VAT registered should request a VAT exclusive price list and must send or fax an order on company notepaper showing the VAT registration number when ordering. Goods will then be supplied without U.K. VAT being charged.

EXPORT CUSTOMERS:

Please use VAT exclusive price list, which will have been enclosed if the catalogue was obtained direct from us. Postage costs are included for orders despatched to the Channel Islands. All other destinations are subject to an additional carriage and insurance charge, as per the postal charges leaflet available on request. Payment should be made in pounds sterling by banker's cheque (draft) or bank transfer to our account - please ask for our bank details. Alternatively you may phone with your card details.

GUARANTEE:

All products are guaranteed against manufacturing defects, subject to fair and proper usage. If for any reason cutters ordered are not to your complete satisfaction, they may be returned *unused* and in all original packaging for exchange or refund.

RETURNS: In the unlikely event that you experience a problem, please contact us to obtain a returns number, before returning any goods. PLEASE NOTE that we cannot accept special or modified cutters or sawblades for return or refund.

DELIVERY & CARRIAGE CHARGES:

Goods will be despatched upon receipt of your order. You will be notified of any items which are not in stock. If you have received neither goods nor an acknowledgment within 14 days, you should contact us immediately.

UK MAINLAND EXCLUDING SCOTTISH HIGHLANDS:

Carriage is free to UK mainland destinations except the Scottish Highlands. Small orders will be sent by first class post, and larger items by 2-3 day carrier or parcel post. Please note: most orders despatched by first class post arrive the next day, although a percentage of deliveries can take 3-4 days or more. If you need next working day delivery, this can be arranged for an additional charge - ask for details.

HIGHLANDS, OFFSHORE ISLES & NORTHERN IRELAND:

Small orders up to 2Kg. will be sent carriage free by post. Larger heavy items such as steel blocks etc. will be sent by carrier on a 3-4 day service - contact us for the additional carriage cost.

EUROPE:

Carriage cost depends on weight and varies between £3.00 and £25.00. Contact us with your order details and we will quote you.

TRADE ACCOUNTS:

Net monthly trade accounts may be opened subject to satisfactory references being obtained. Please contact us for an account application form. Accounts may be paid by cheque or BACS transfer. Our bank details are available on request.

SPECIFICATION:

Wealden Tool Company Limited reserves the right to alter without notice the specification or prices of any products described in this catalogue.

GENERAL:

Every effort is made to ensure the accuracy of information contained in this catalogue. Any errors which affect function or performance will be advised at time of ordering. E & OE. We cannot be held liable for consequential loss. Goods remain the property of WEALDEN TOOL COMPANY LIMITED until payment has been effected in cleared funds. Place of payment is 2 Clinton Business Centre, Lodge Road, Staplehurst, Kent, TN12 0QF.

SAFETY STANDARD EN 847-1/2 for Spindle Moulder Tooling

In 1997 a Europe-wide standard EN 847 was adopted by all EU countries, replacing all the individual countries' safety standards and detailing technical safety requirements of machine tools for wood processing, including limited cutter projection tooling (suitable for hand feed).

All the tooling in this catalogue is manufactured in accordance with EN 847 and is marked either MAN or MEC, along with other information on speeds etc.

MAN - Hand Feed Regulations

Hand feed is regarded as the holding and guiding of work pieces by hand. The term also applies to the use of demountable power feed units or a hand-operated carriage on which the work-piece is placed manually or clamped. Hand feed tools have

the following characteristics: chip thickness limitation of maximum 1.1mm knife projection for non-circular tools and 3mm for circular tools; limited tooth gullet space and mainly circular form. Tools conforming to this standard are marked MAN or carry the hand feed logo.



MEC - Mechanical Feed Regulations

Mechanical feed is the feeding of the material work-piece by mechanical means, with the exception of machines where the power feed unit can be removed. Tools conform to general safety standards, but are not subject to standards concerning knife projection or tooth gullet width.

PRODUCT *index*

Part number index is on page 52

Adjustable Tenon/groover TC disposable inserts ··· 43	Grooving cutters 140mm ········· 44
Adjustable chamfer block ········· 36	Grooving cutters fixed tip 120mm ········· 44
Beading & bullnose block ········· 48	Guide rings ········· 47
Ball bearing guide rings ········· 47	Limiter plates
Cabinet door profile block ········· 37	40mm wide x 4mm ········· 4 - 15
Chamfer blocks ········· 36	50mm wide x 4mm ········· 16 - 23
Cove radius block with TC disposable inserts ···· 50	50mm wide x 5.5mm ········· 25 - 33
Cutter blanks	Lock mitre jointer ········· 41
40mm wide x 4mm ········· 3	Panel raising blocks
50mm wide x 4mm ········· 16	Multi profile ········· 39
50mm wide x 5.5mm ········· 25	Traditional taper ········· 39
Cutter blanks & spares - 40mm x 4mm ······· 3	Panel raising tool steel knives ········· 39 - 40
Cutter knife profiles	Profile knives
40mm wide x 4mm ········· 4 - 15	40mm wide x 4mm ········· 4 - 15
50mm wide x 4mm ········· 16 - 23	50mm wide x 4mm ········· 16 - 23
50mm wide x 5.5mm ········· 25 - 33	50mm wide x 5.5mm ········· 25 - 33
Cutterheads for 40mm x 4mm knives	Profile/counter profile block ········· 38
hand feed ········· 2	Radius profile block ········· 49
mechanical feed ········· 2	Rebate blocks ········· 34
Cutterheads for 50mm x 5.5mm knives	Rebate knives ········· 3
hand feed ········· 24	Reducer bushes ········· 47
mechanical feed ········· 24	Sanding drum ········· 42
Espagnolette groove block ········· 51	Spacer rings ········· 51
Glue finger jointing block with disposable inserts · 42	Spiral planer/rebate cutterhead ········· 35
Glue joint	Stackable planer cutterheads ········· 35
Mitre lock ········· 41	Tenon/groover ········· 43
Vee type ········· 41	
Groovers - disposable tip	
Adjustable with shims ········· 46	
Adjustable with threaded bush ······· 46	
Non adjustable ········· 45	

Cutterheads for 4mm thick profile knives

A range of spindle blocks in either high grade lightweight aluminium alloy or steel, with two pin location of the knives and limitors. Two ranges are available: mechanical feed for use on spindle moulding machines with permanently fitted power feed, and hand feed for all machines without a permanently fitted power feed.

The location pin system on these blocks not only ensures a safe system with the profile knives positively held in the block, but also provides quick and easy change over of profiles, as no setting up or alignment of the knives is required.

A range of 40mm x 4mm thickness alloy steel profile knives for use with these cutterheads is illustrated on pages 4 to 15.

Cutterheads for mechanical feed

The mechanical feed cutter heads have locators and clamping for pairs of 4mm thickness x 40mm wide profile knives as listed on pages 4 to . These heads do not have any form of chip limiting action and are therefore **NOT** suitable for hand feeding. These heads, when fitted with the alloy steel (SP) profile knives, are suitable for jointing, rebating and profile work in un-bonded natural timbers. The blocks are supplied with SP rebate knives fitted.

Part number	Size			Body material	Cutting dia. with rebate knives	Maximum RPM
	dia.	height	bore			
F210800	78	40	30	Aluminium	88mm	9,000
F211000	100	40	30	Steel	113mm	8,400



Mechanical feed head

Cutterheads for hand feed

The hand feed cutter heads have locators and clamping for a pair of 4mm thickness profile knives and a pair of chip limitors. The heads are supplied with a pair of rebate knives and limitors. Manufactured to EN847-1/2 - suitable for **HAND FEEDING**.

Cutter heads are available in a range of sizes, with the 78mm head being particularly suitable for use on small spindles and universals where the clearance on the guard would prevent a larger block being used.

The heads marked 40/50 height will accept both the 40mm knives and the 50mm x 4 mm knives and limitors listed on pages 16 to .

NB A set of profiles for these blocks consists of 1 pair of profile knives and 1 pair of limitors.



Hand feed head – F221150



Part number	Size			Body material	Cutting dia. with rebate knives	Maximum RPM
	dia.	height	bore			
F221110	100	40/50	30	Steel	110	10,000
F221200	120	40	30	Steel	132	7,900
F221150	116	40/50	30	Steel	120	8,000
F221153	114	40/50	1¼"	Steel	120	8,000
F221480	150	40	30	Aluminium	164	6,000



Hand feed head – F221480

Profile knives, limitors & blanks – 40mm x 4mm range

A range of SP alloy steel profile knives is illustrated full size on pages 4 to . The knives are 40mm wide by 4mm thickness and will fit the heads listed on page 2 as well as most other heads using the two pin location system. *SP grade steel profile knives are suitable for cutting soft and hard woods but are NOT suitable for man made boards e.g. MDF.*

ORDERING INFORMATION: Order using the part numbers shown against the profile knife illustrations on the following pages.

N.B. Kn = knife part number & Li = limitor part number.

For the matching limitor, replace the "121" in the part number with "122"
(e.g. limitor part number for profile F121086 is F122086)

PRICES for knives, limitors and blanks are per pair.



Alloy Steel (SP) Profile Knives

Part number	Profiles	Pages
F121001 – F121034	001 – 034	4 – 6
F121035 – F121094	035 – 094	7 – 11
F121095 – F121133	095 – 133	12 – 15
F121100 – F121177	170 – 177	15

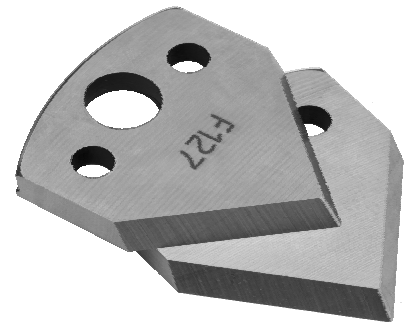

Limitor Plates

Part number	Limitors	Pages
F122001 – F122035	001 – 034	4 – 6
F122037 – F122095	035 – 094	7 – 11
F122096 – F122099	095 – 133	12 – 15
F122100 – F122177	170 – 177	15



Rebate Knives

Part number	Description	Page
F121191	Rebate knife (20mm)	4
F122191	Rebate limitor (20mm)	4

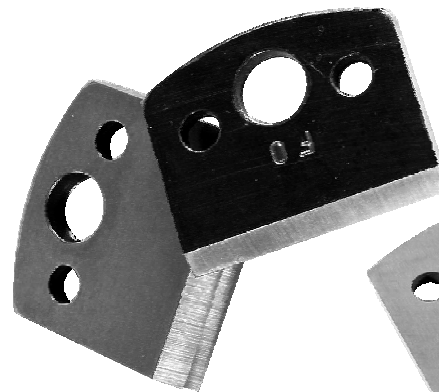

Blanks

Part number	Description	Page
F121193	Blank - SP (34mm)	4
F121195	Blank - HSS (34mm)	4
F122193	Limitor for blank (32mm)	4

Alloy steel (SP) profile knives
(40 x 4mm)

Profiles are shown full size
from the back of the knife

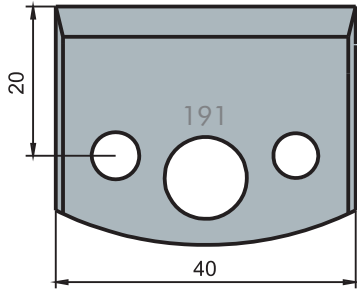

Kn F121191
Li F122191

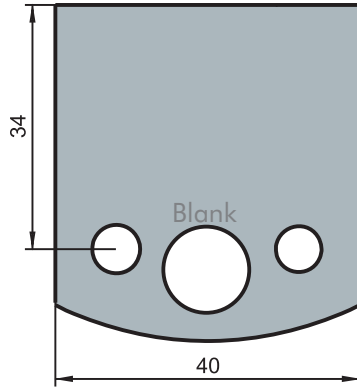

Kn F121193 HSS F121195
Li F122193

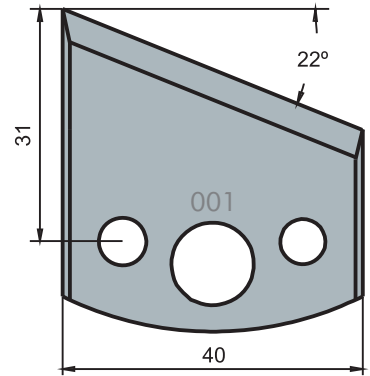

Kn F121001
Li F122001

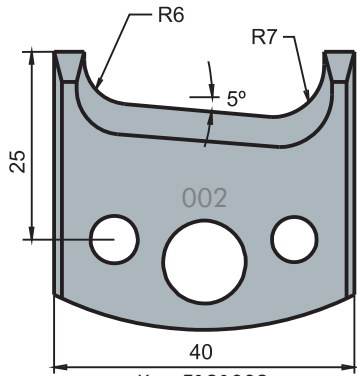

Kn F121002
Li F122002

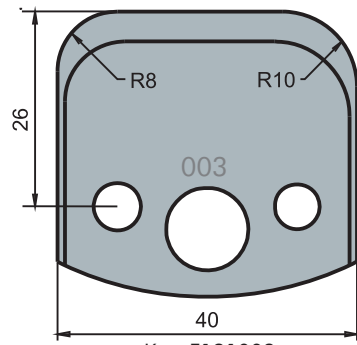

Kn F121003
Li F122003

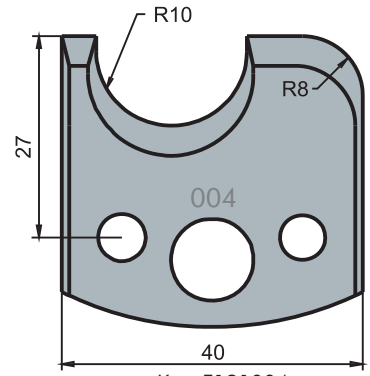

Kn F121004
Li F122004

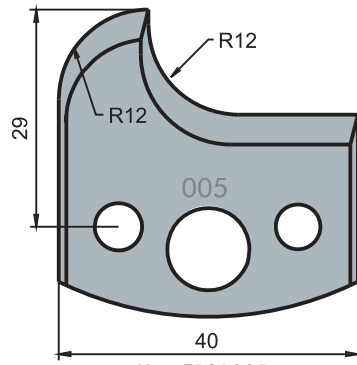

Kn F121005
Li F122005

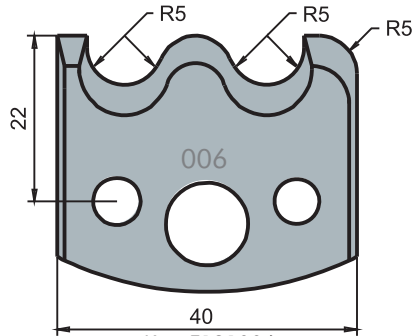

Kn F121006
Li F122006

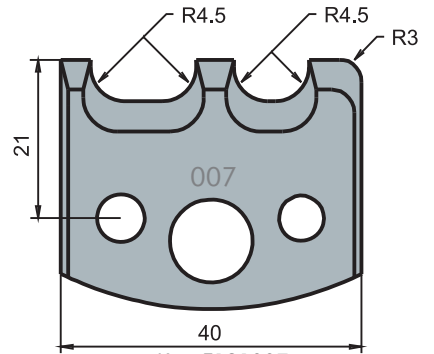

Kn F121007
Li F122007

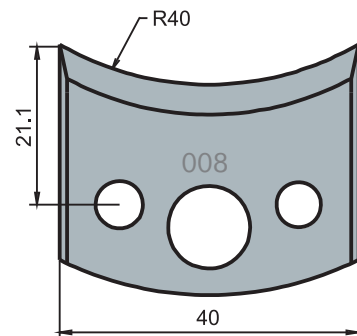

Kn F121008
Li F122008

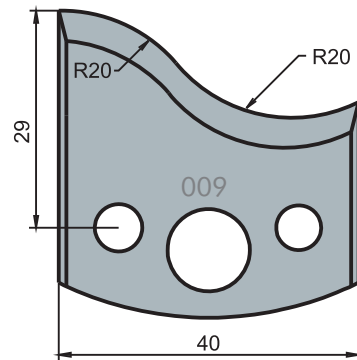

Kn F121009
Li F122009

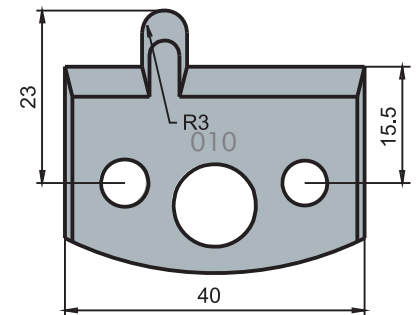

Kn F121010
Li F122010

Alloy steel (SP) profile knives
(40 x 4mm)

Profiles are shown full size
from the back of the knife

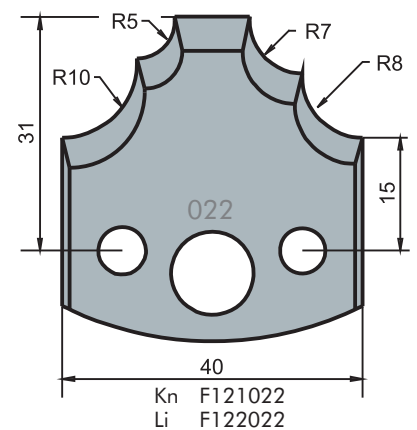
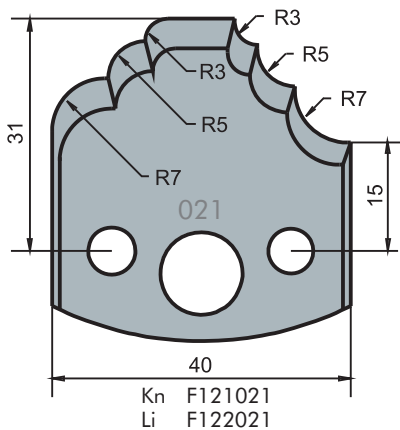
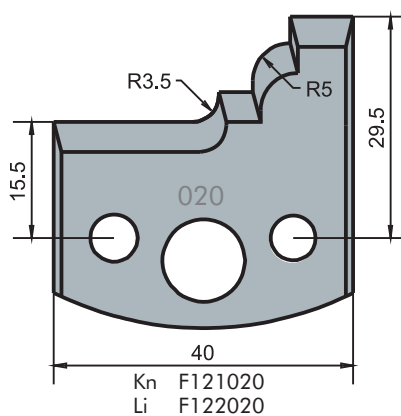
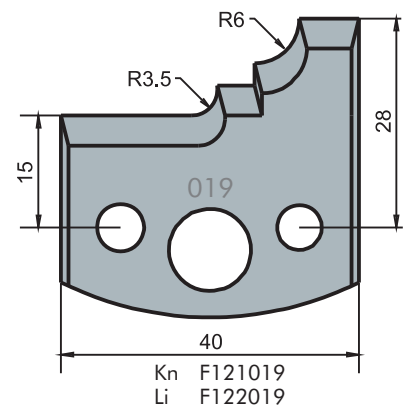
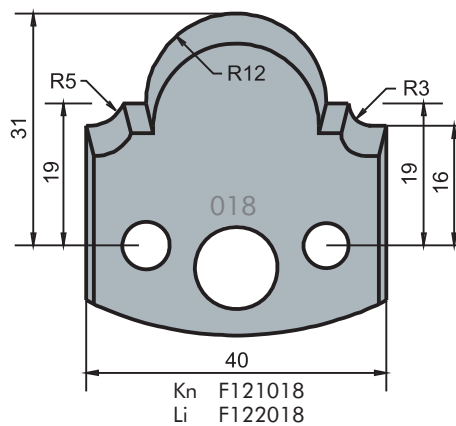
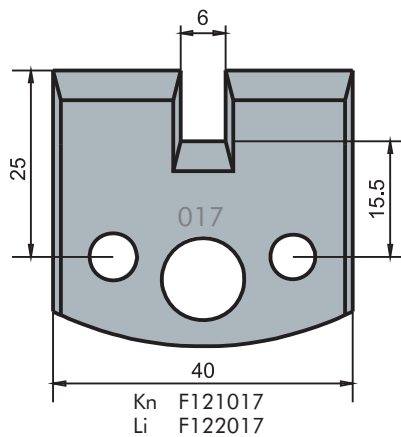
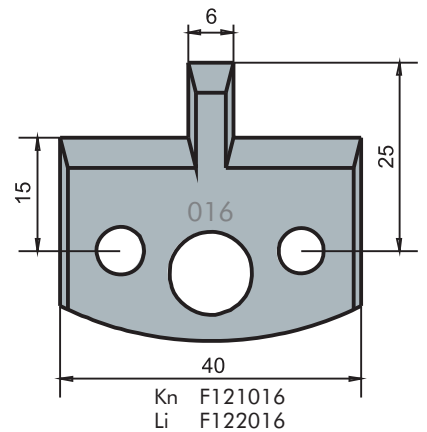
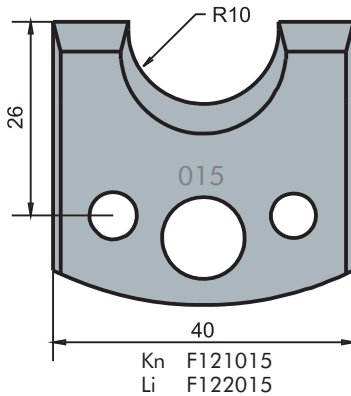
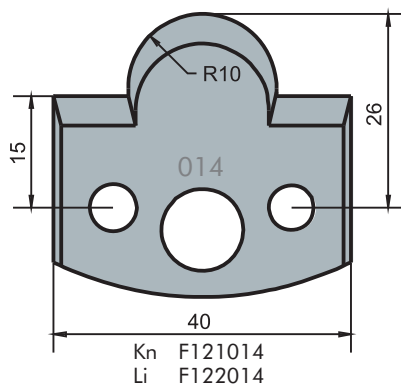
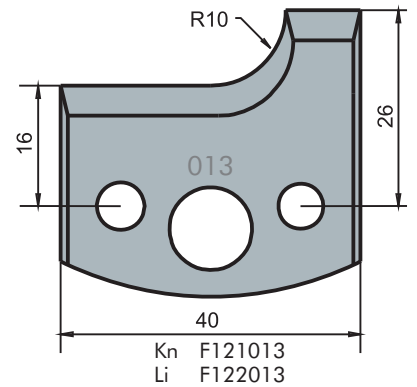
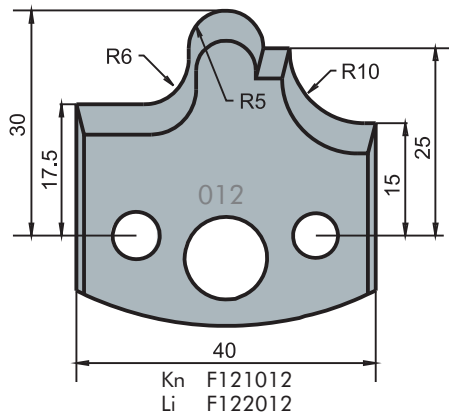
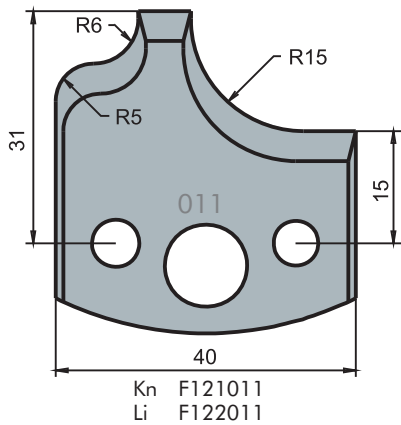

Alloy steel (SP) profile knives
(40 x 4mm)

Profiles are shown full size
from the back of the knife

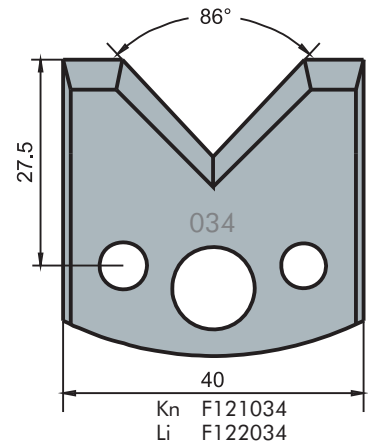
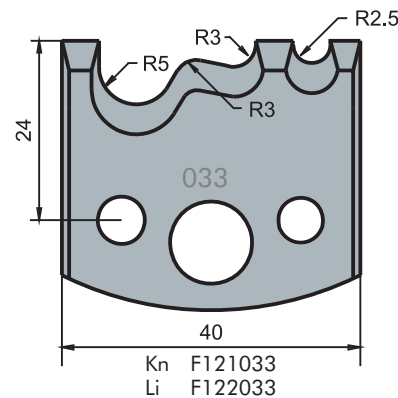
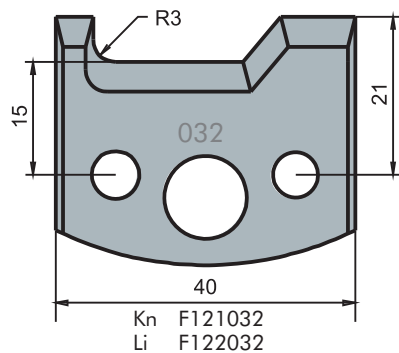
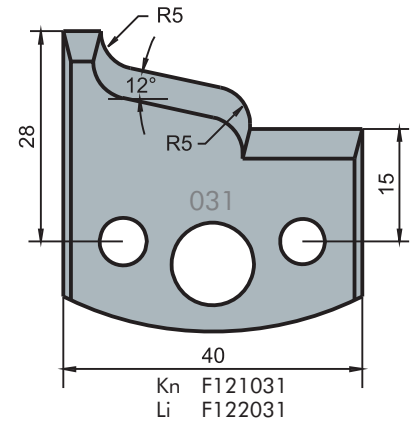
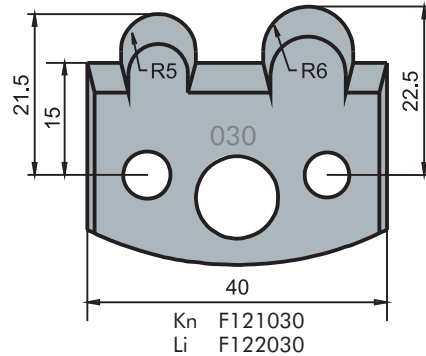
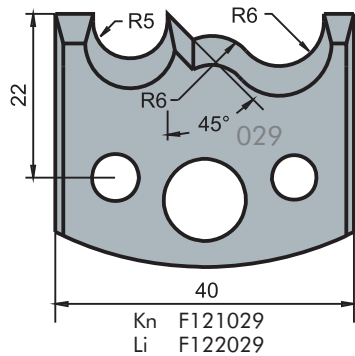
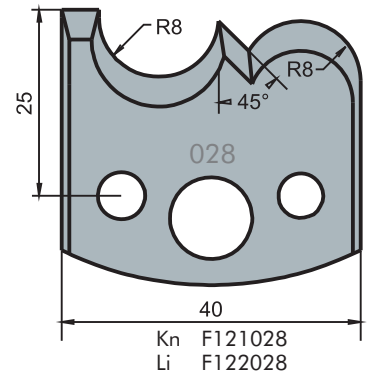
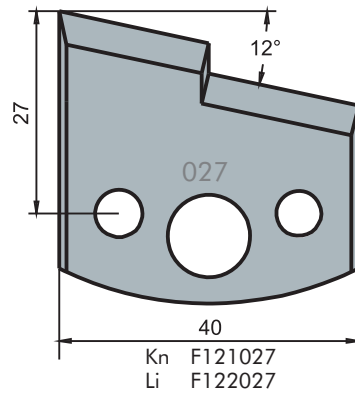
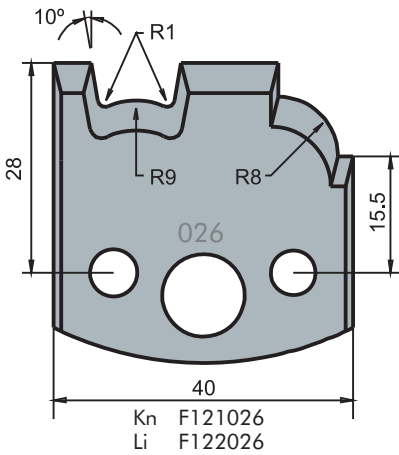
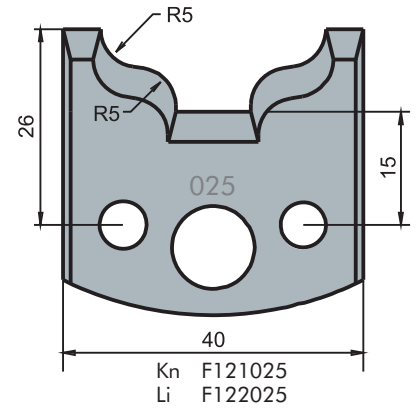
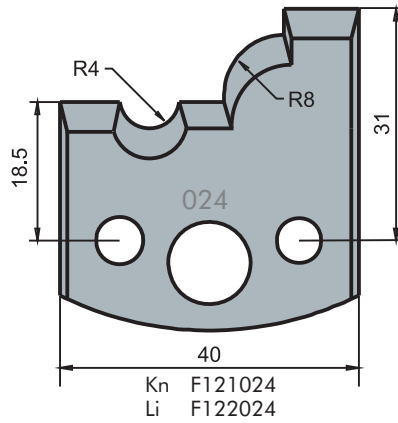
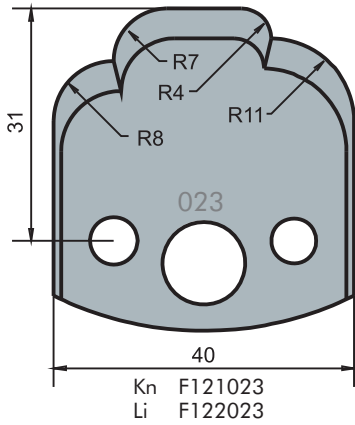

Alloy steel (SP) profile knives
(40 x 4mm)

Profiles are shown full size
from the back of the knife

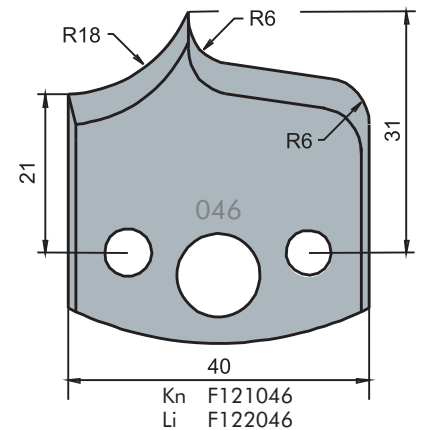
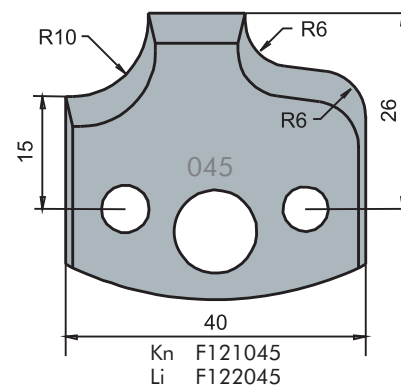
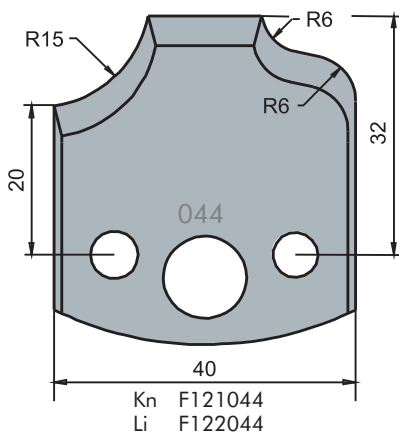
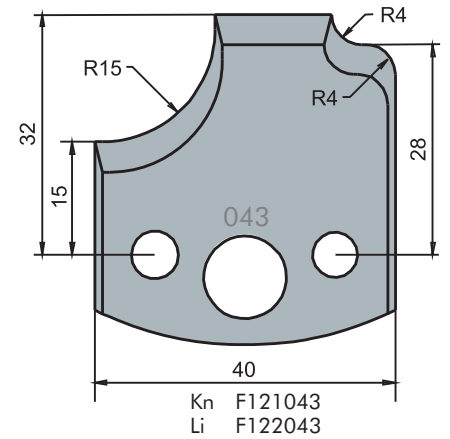
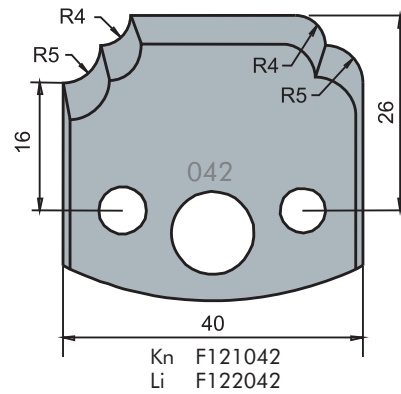
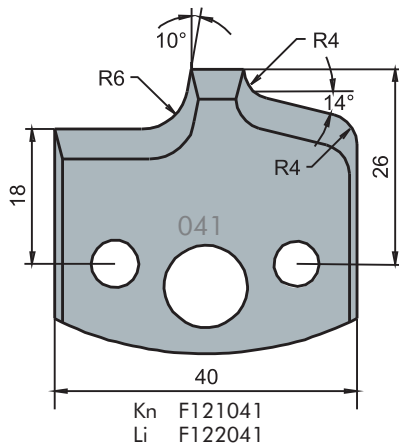
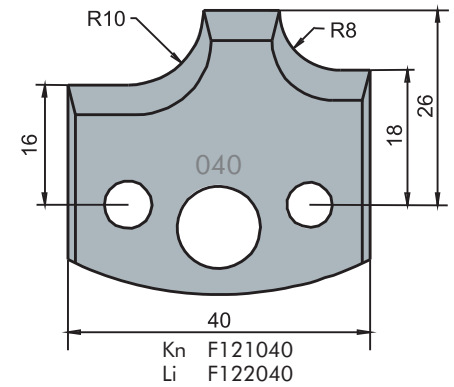
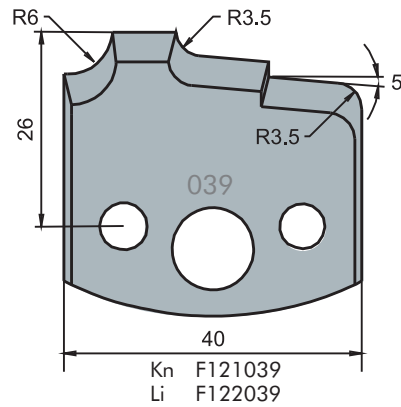
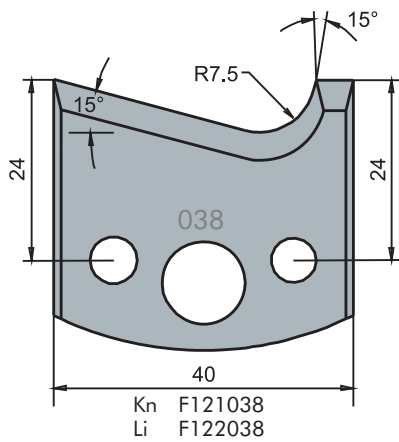
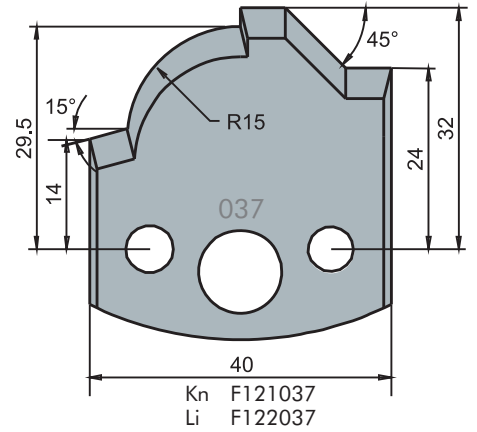
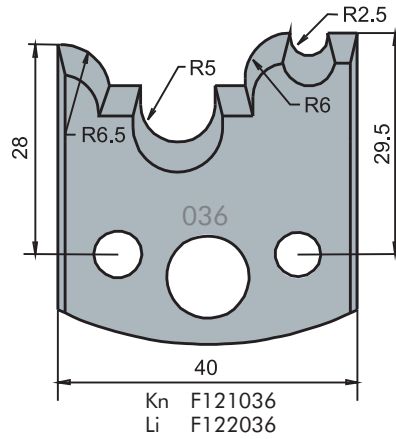
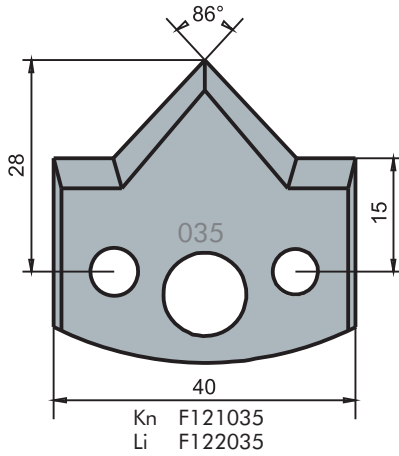

Alloy steel (SP) profile knives
(40 x 4mm)

Profiles are shown full size
from the back of the knife

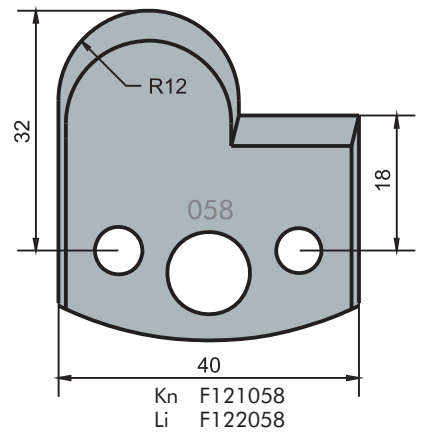
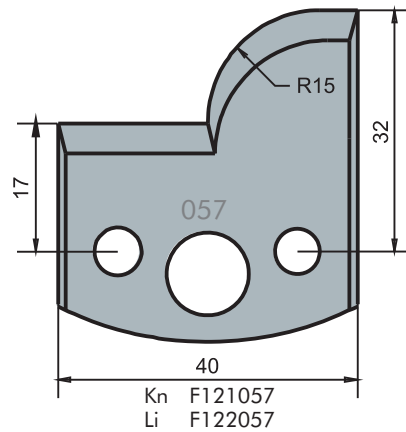
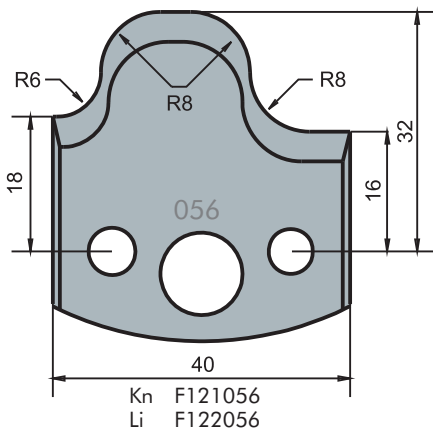
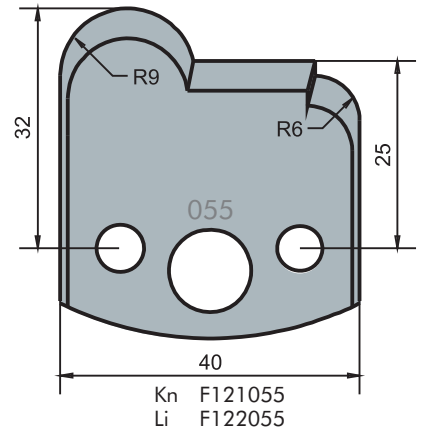
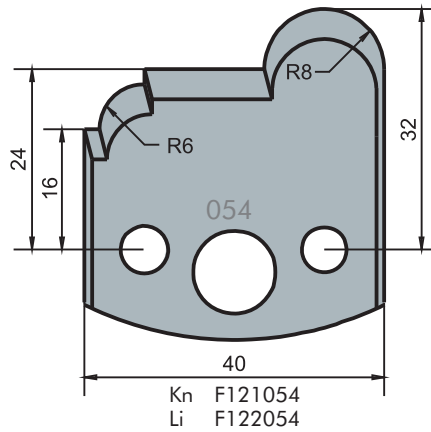
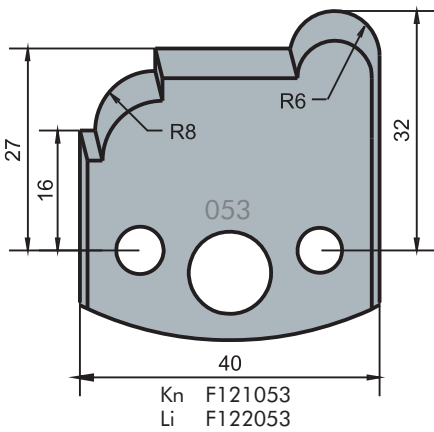
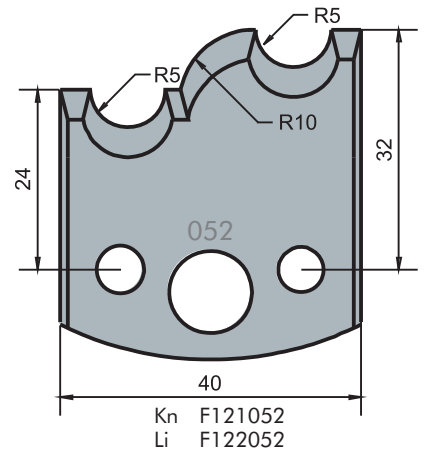
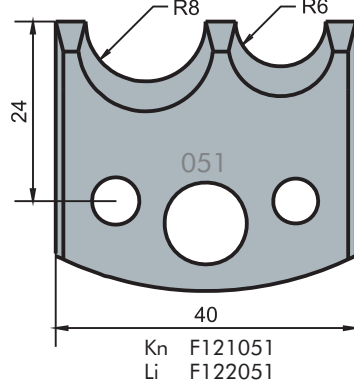
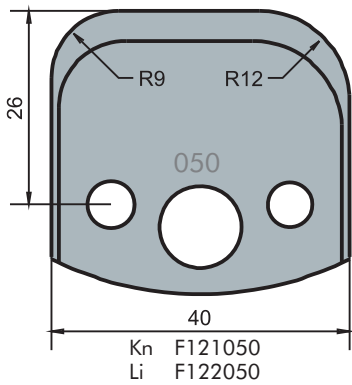
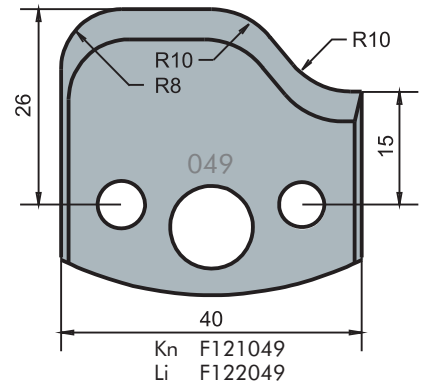
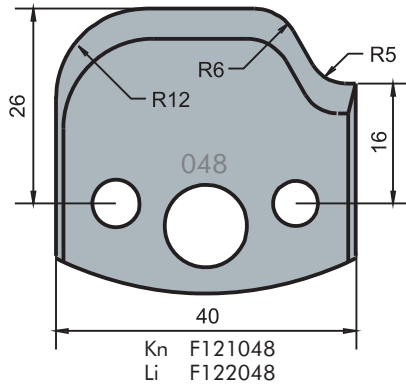
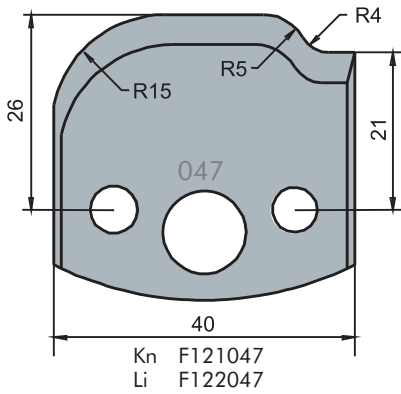

Alloy steel (SP) profile knives
(40 x 4mm)

Profiles are shown full size
from the back of the knife

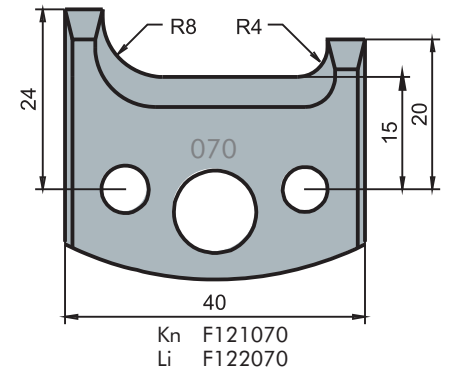
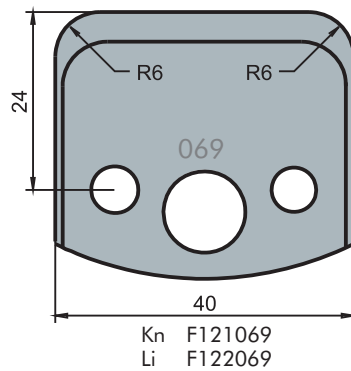
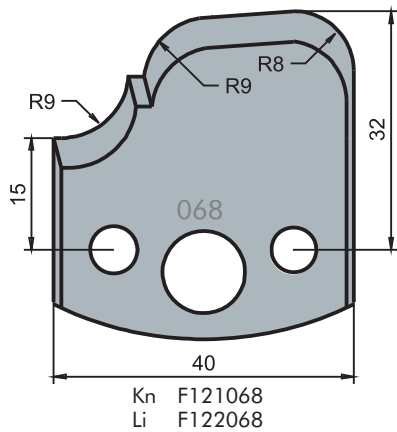
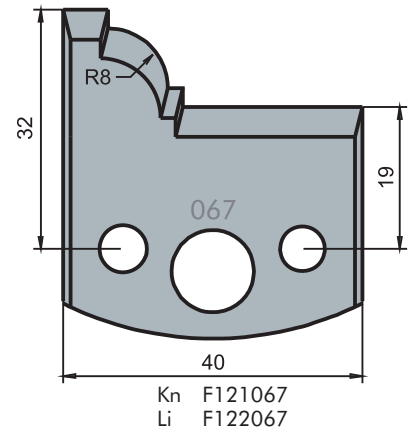
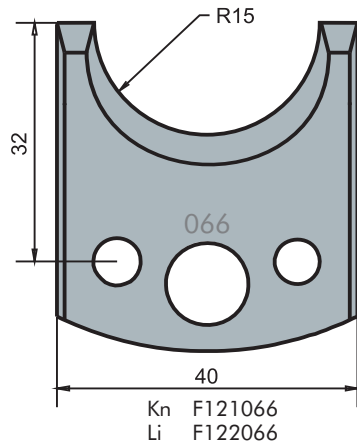
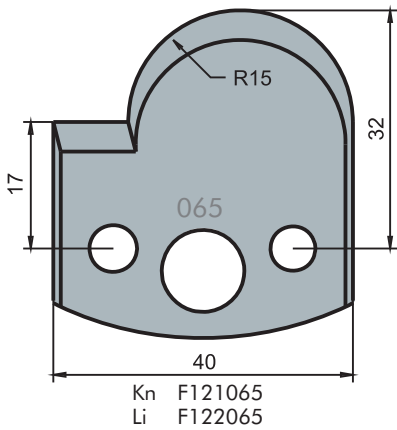
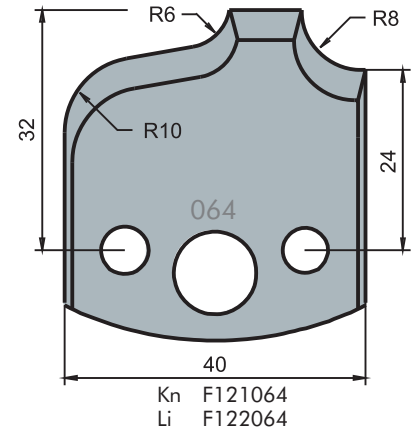
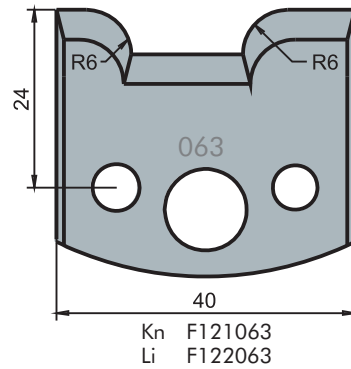
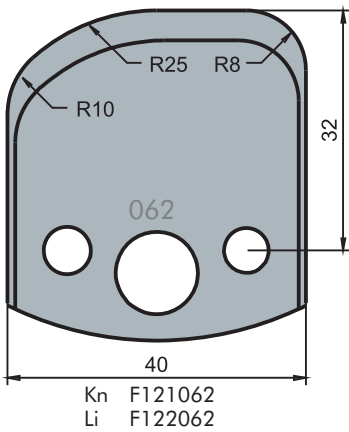
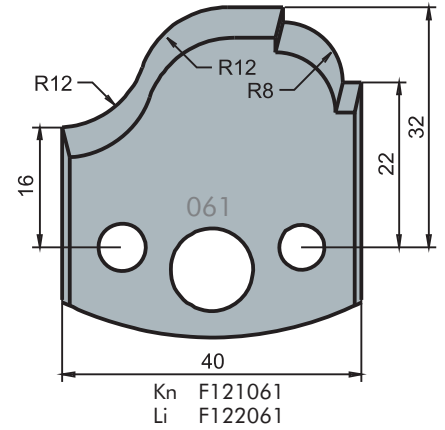
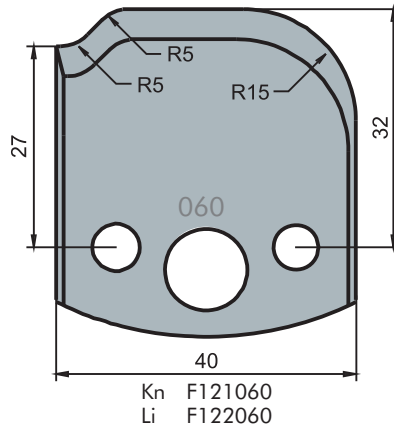
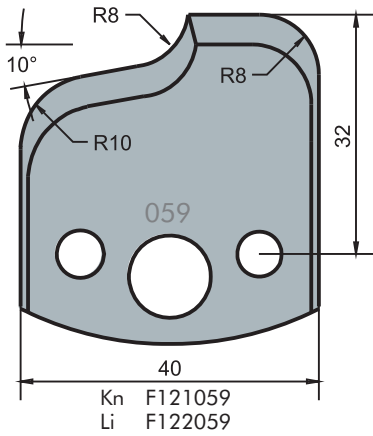

Alloy steel (SP) profile knives
(40 x 4mm)

Profiles are shown full size
from the back of the knife

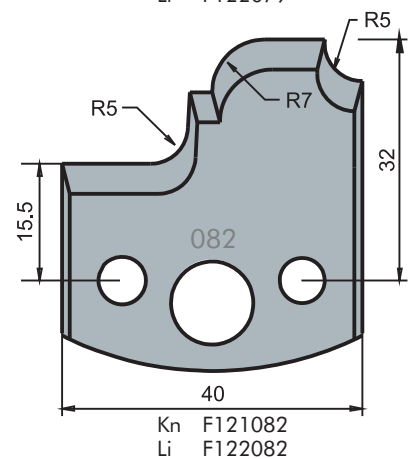
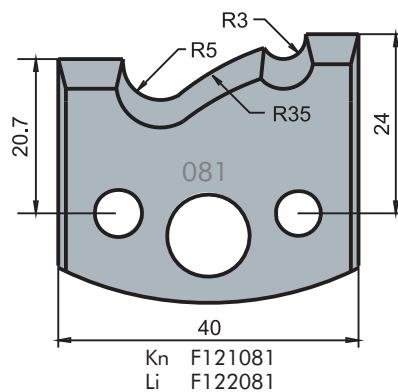
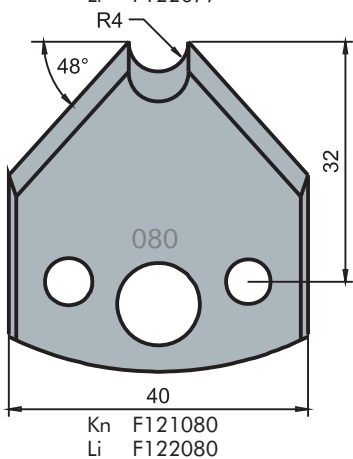
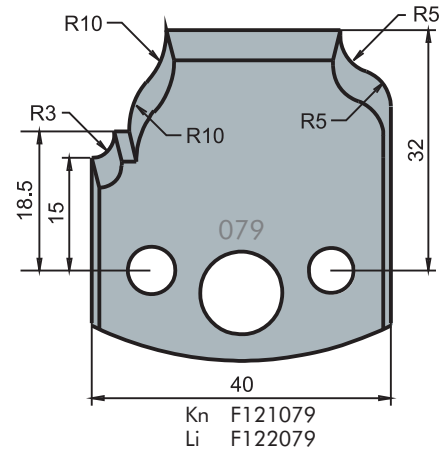
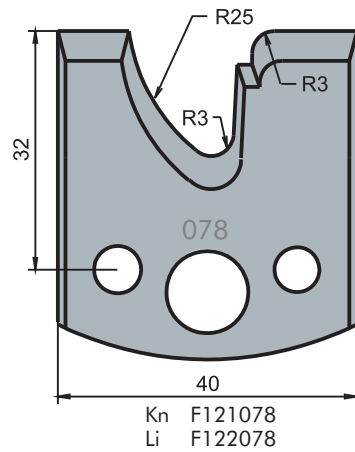
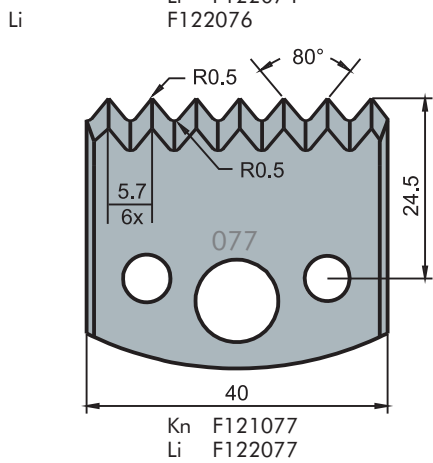
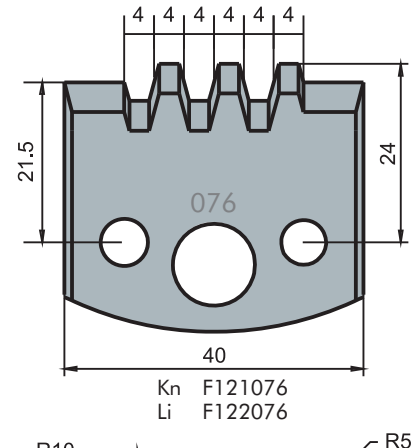
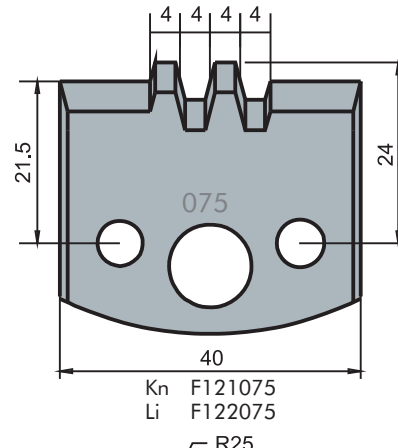
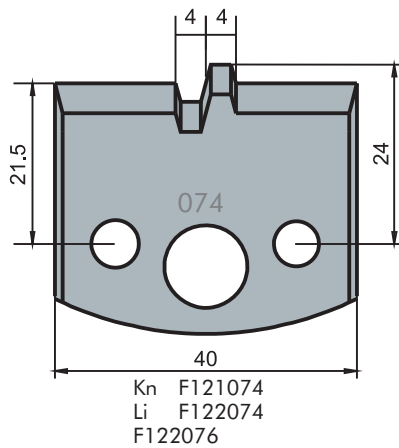
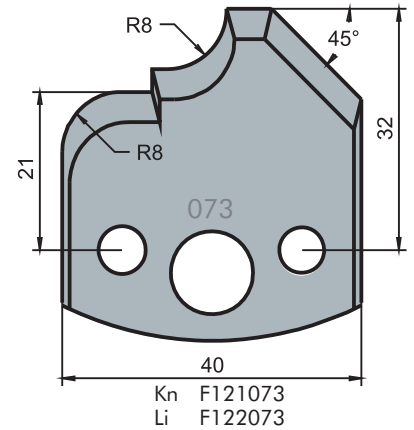
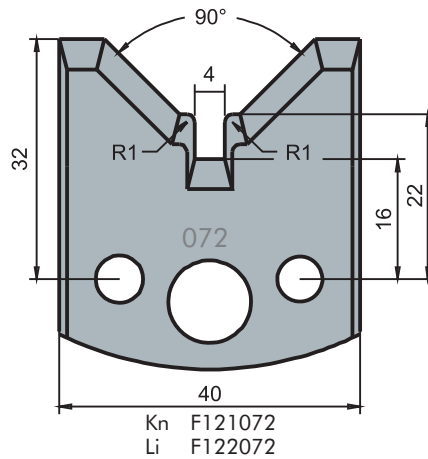
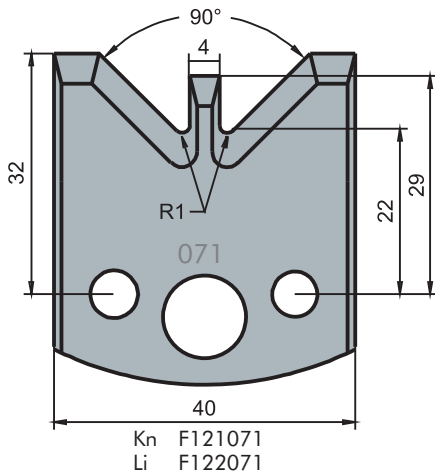

Alloy steel (SP) profile knives
(40 x 4mm)

Profiles are shown full size
from the back of the knife

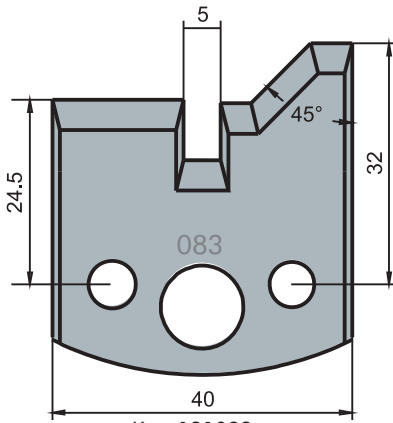

Kn 121083
Li 121084

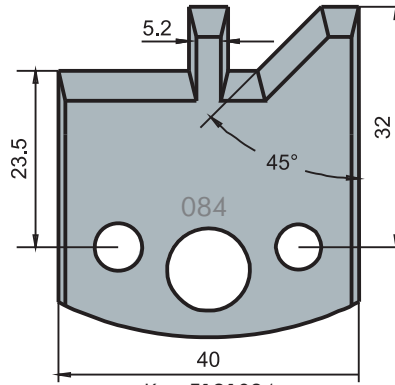

Kn F121084
Kn F122084

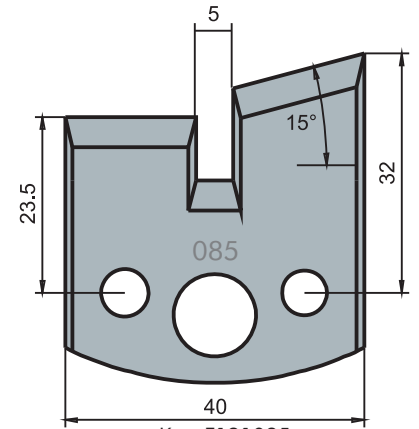

Kn F121085
Kn F122085

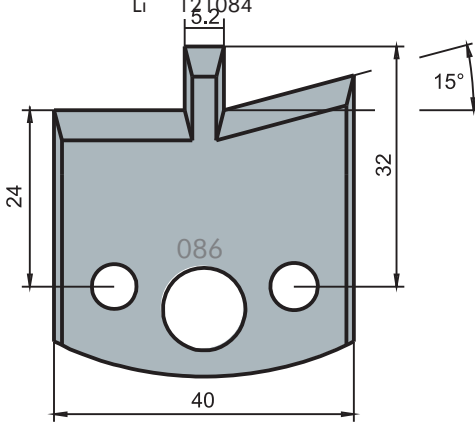

Kn F121086
Li F122086

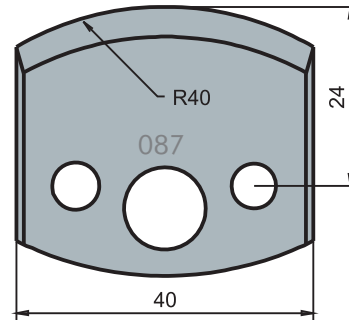

Kn F121087
Li F122087

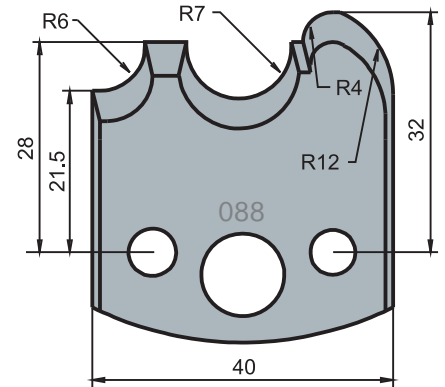

Kn F121088
Li F122088

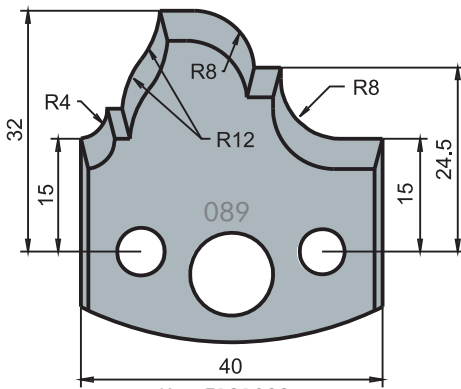

Kn F121089
Li F122089

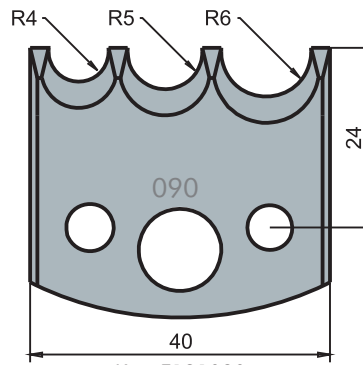

Kn F121090
Li F122090

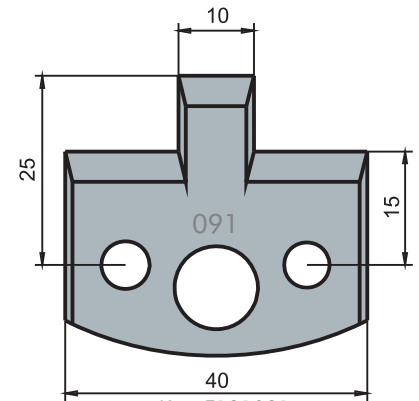

Kn F121091
Li F122091

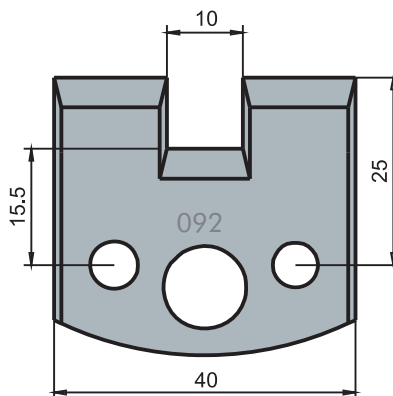

Kn F121092
Li F122092

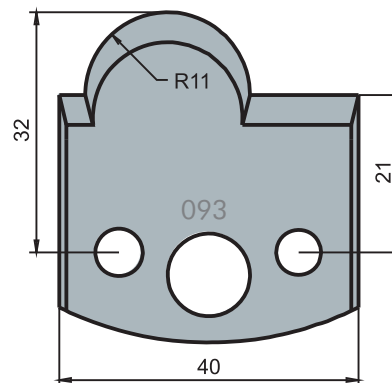

Kn F121093
Li F122093

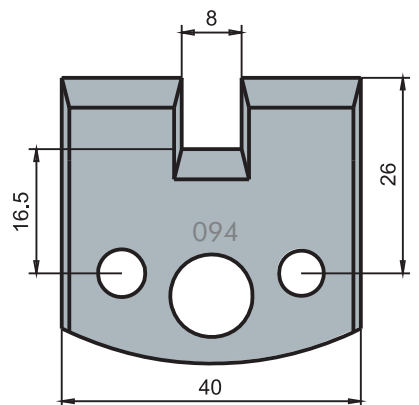

Kn F121094
Li F122094

Alloy steel (SP) profile knives
(40 x 4mm)

Profiles are shown full size
from the back of the knife

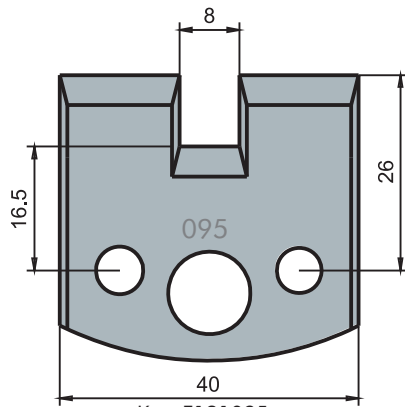

Kn F121095
Li F122095

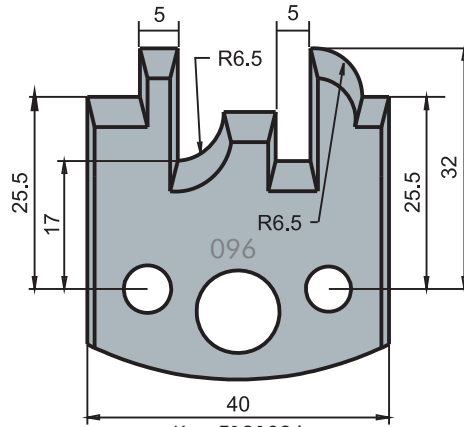

Kn F121096
Li F122096

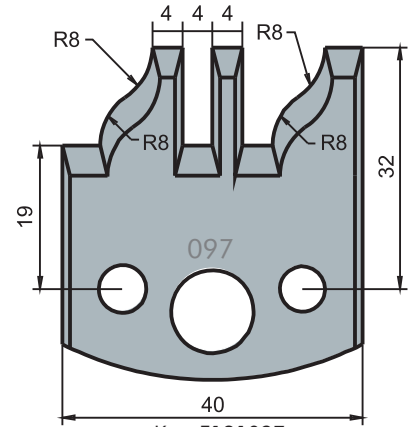

Kn F121097
Li F122097

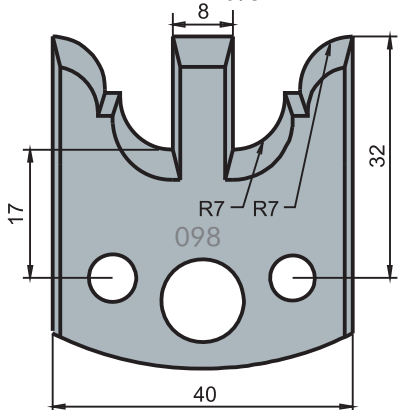

Kn F121098
Li F122098

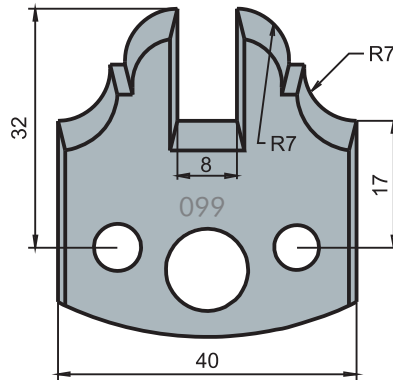

Kn F121099
Li F122099

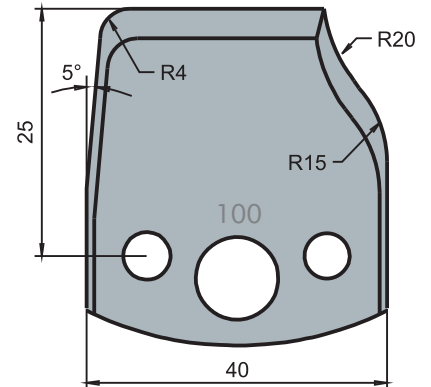

Kn F121100
Li F122100

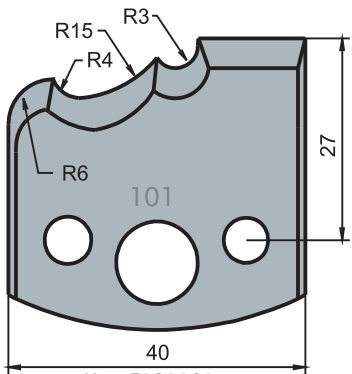

Kn F121101
Li F122101

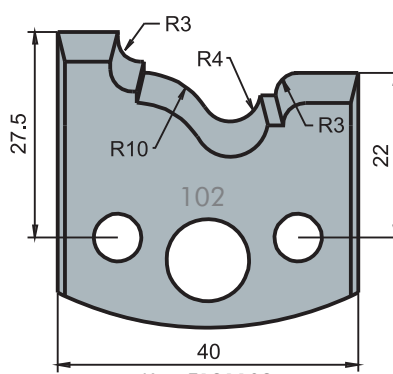

Kn F121102
Li F122102

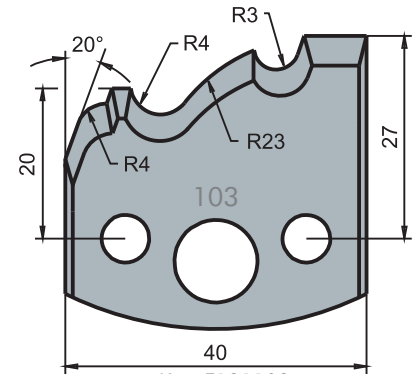

Kn F121103
Li F122103

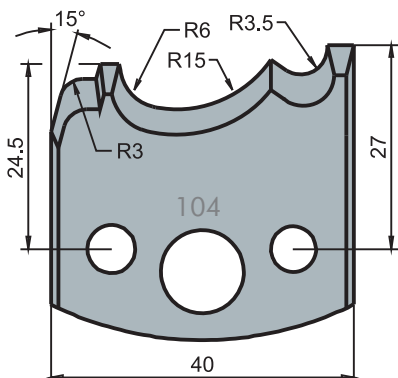

Kn F121104
Li F122104

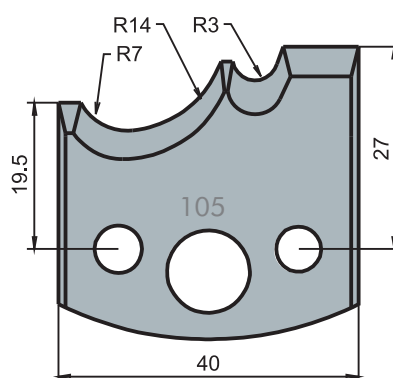

Kn F121105
Li F122105

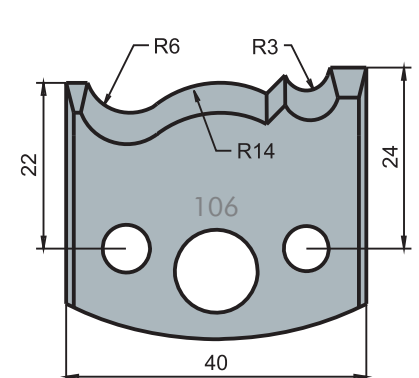

Kn F121106
Li F122106

Alloy steel (SP) profile knives
(40 x 4mm)

Profiles are shown full size
from the back of the knife

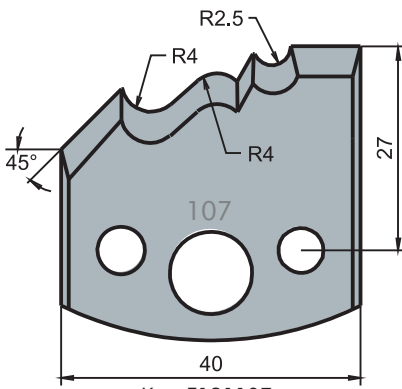

Kn F121107
Li F122107

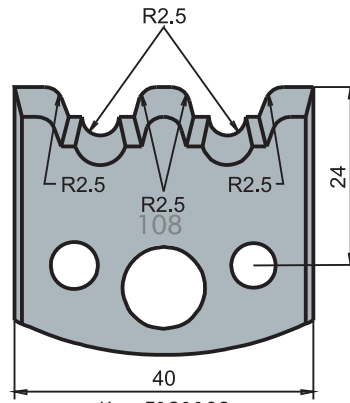

Kn F121108
Li F122108

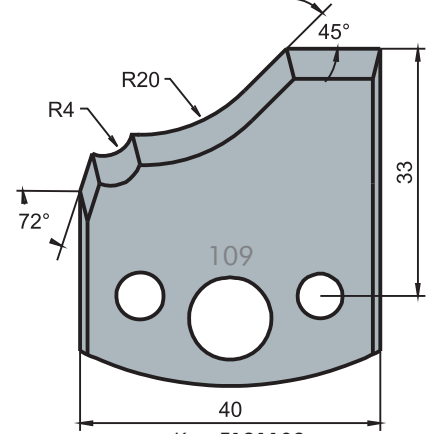

Kn F121109
Li F122109

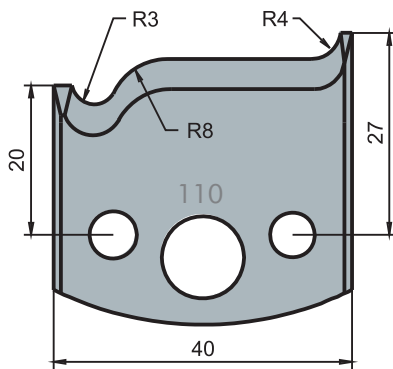

Kn F121110
Li F122110

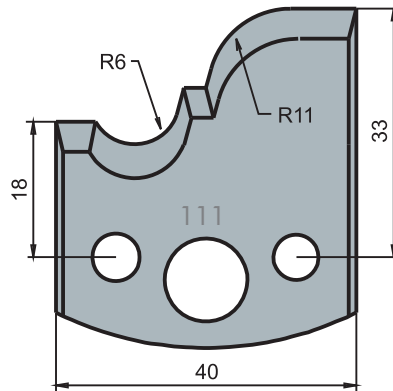

Kn F121111
Li F122111

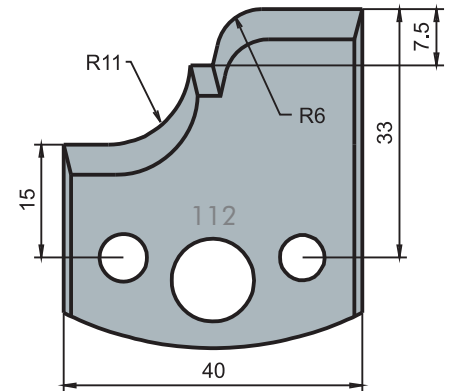

Kn F121112
Li F122112

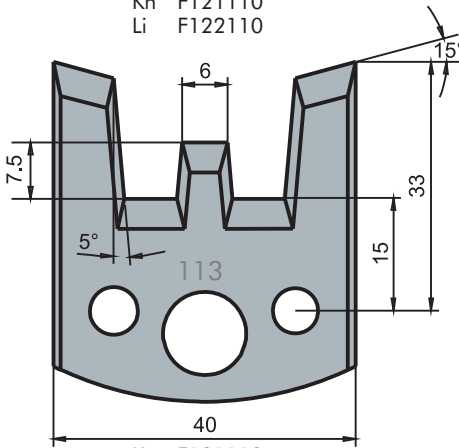

Kn F121113
Li F122113

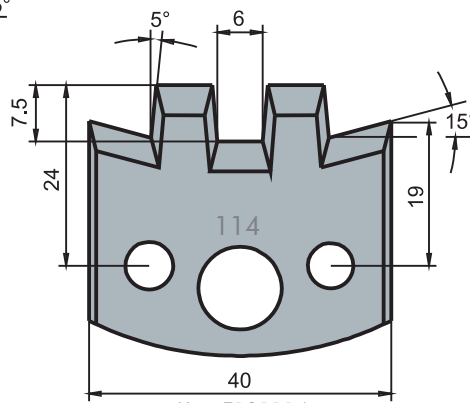

Kn F121114
Li F122114

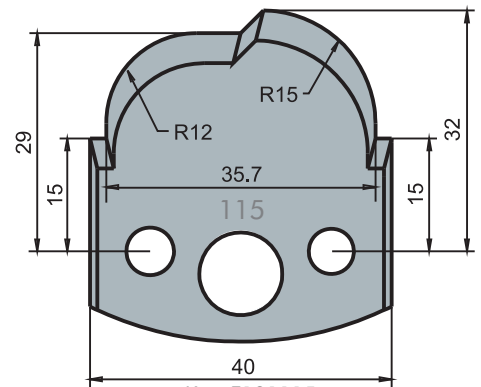

Kn F121115
Li F122115

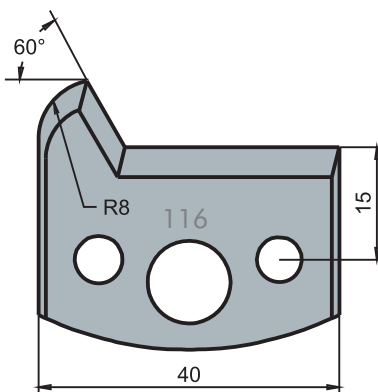

Kn F121116
Li F122116

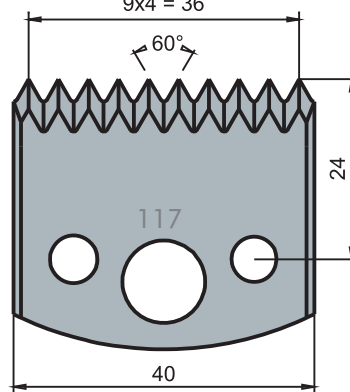

Kn F121117
Li F122117

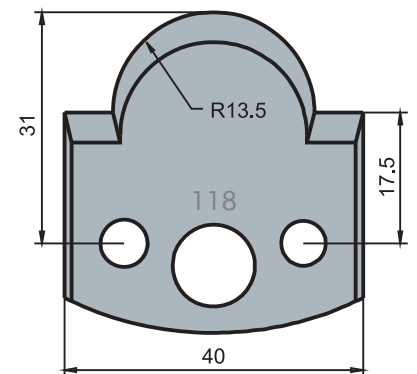

Kn F121118
Li F122118

Alloy steel (SP) profile knives
(40 x 4mm)

Profiles are shown full size
from the back of the knife

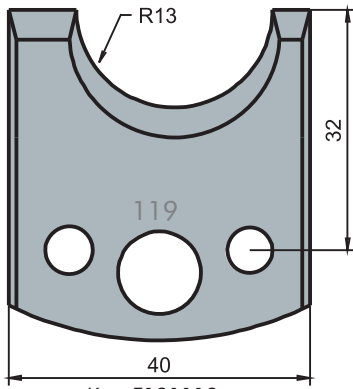

Kn F121119
Li F122119

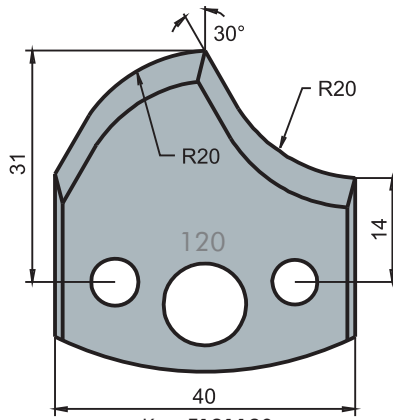

Kn F121120
Li F122120

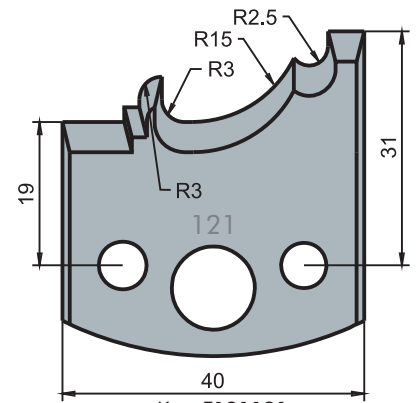

Kn F121121
Li F122121

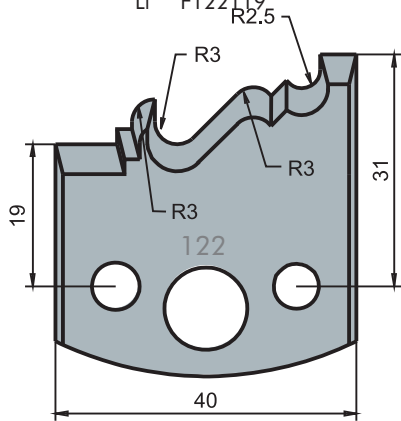

Kn F121122
Li F122122

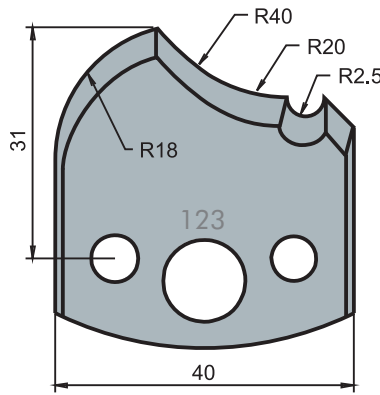

Kn F121123
Li F122123

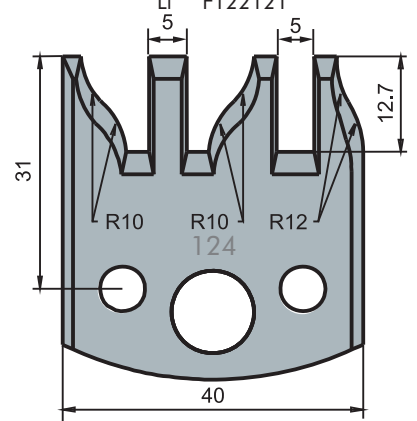

Kn F121124
Li F122124

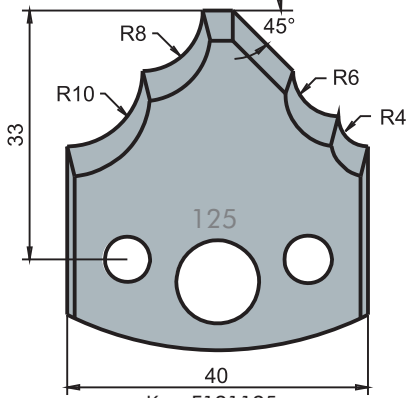

Kn F121125
Li F122125

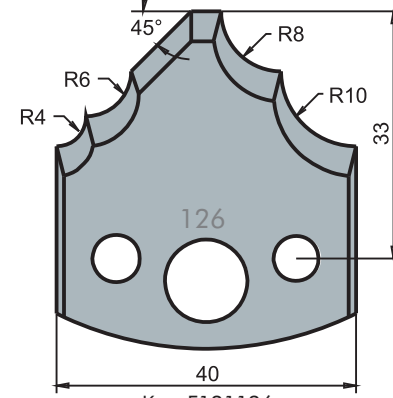

Kn F121126
Li F122126

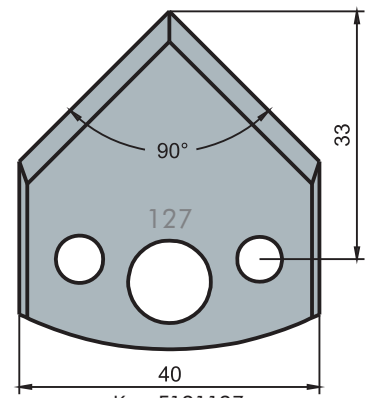

Kn F121127
Li F122127

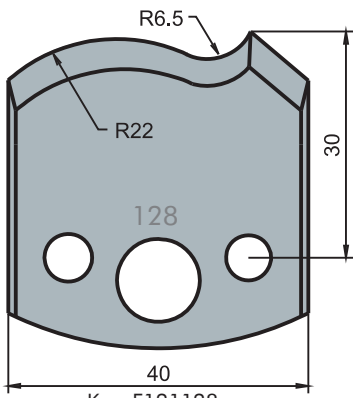

Kn F121128
Li F122128

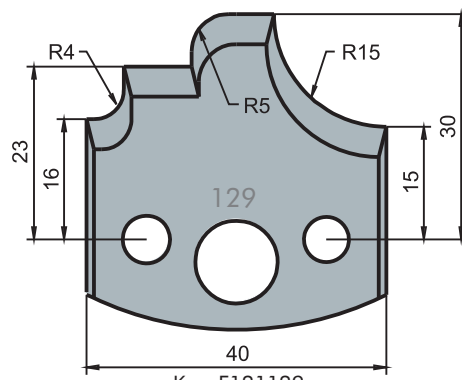

Kn F121129
Li F122129

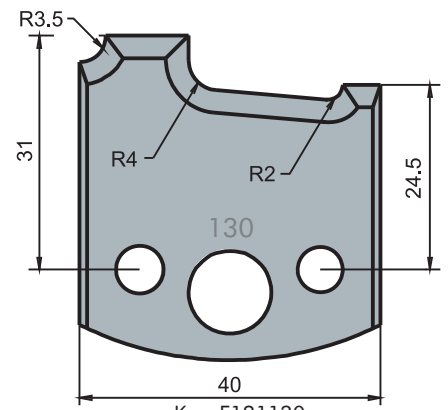

Kn F121130
Li F122130

SPINDLE TOOLING



Quality products - quality service

Alloy steel (SP) profile knives
(40 x 4mm)

Profiles are shown full size
from the back of the knife

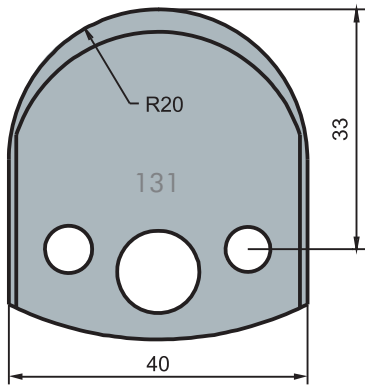

Kn F121131
Li F122131

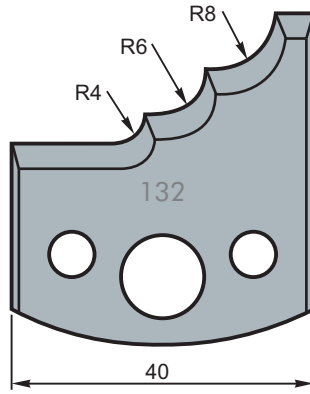

Kn F121132
Li F122132

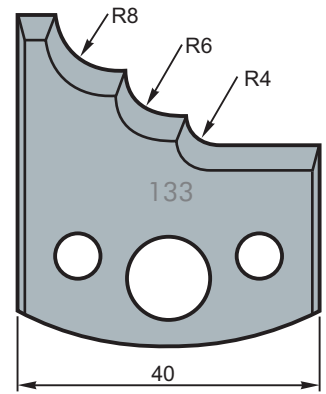

Kn F121133
Li F122133

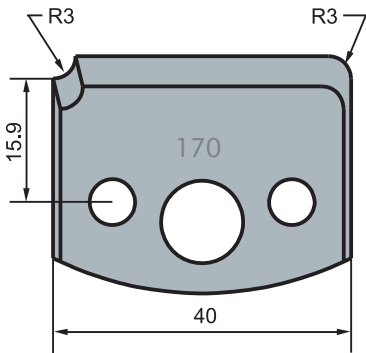

Kn F121170
Li F122170

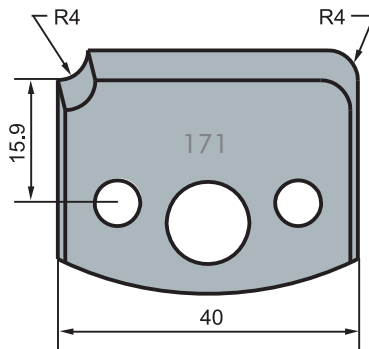

Kn F121171
Li F122171

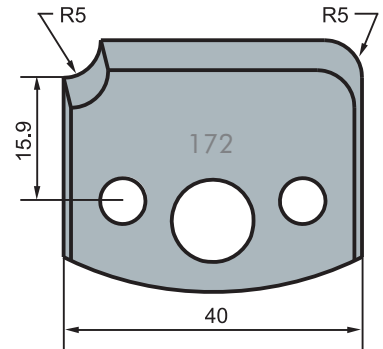

Kn F121172
Li F122172

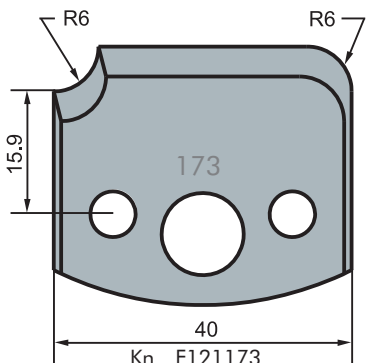

Kn F121173
Li F122173

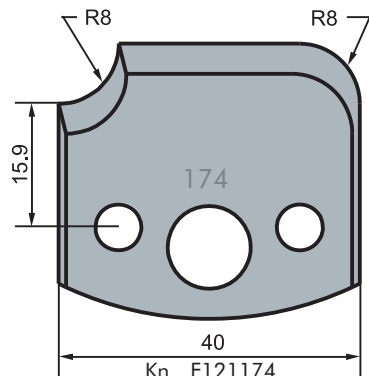

Kn F121174
Li F122174

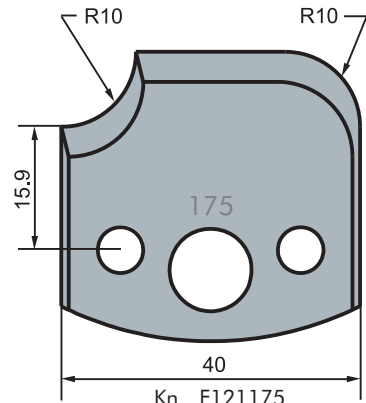

Kn F121175
Li F122175

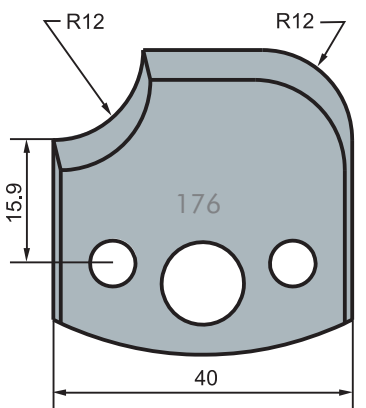

Kn F121176
Li F122176

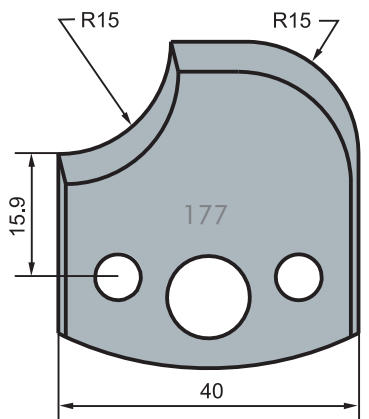

Kn F121177
Li F122177

Alloy steel (SP) profile knives
(50 x 4mm)

Profiles are shown full size
from the back of the knife

Profile knives, limitors & blanks – 50mm x 4mm range

A range of 50mm wide SP alloy steel profile knives, limitors and blanks. These profile knives have the same locator pin spacing as the 40mm wide (6mm pins on 24mm centres) and will fit the 40/50mm blocks F221140 and F221143 listed on page 2.

ORDERING INFORMATION: Order using the part numbers shown against the profile knife illustrations on the following pages. For the matching limitors, replace the "131" in the part number with "132" (e.g. limitors part number for profile F131020 is F132020).

N.B. Kn = knife part number & Li = limitor part number.

SP grade steel profile knives are suitable for cutting soft and hard woods but are **NOT** suitable for man made boards e.g. MDF.

PRICES for knives, limitors and blanks are per pair.



Blanks

Part number	Description
F131194	Blank -SP (34mm)
F131195	Blank - HSS
F132194	Limitor for blank

Alloy Steel (SP) Profile Knives (50mm)

Part number	Description	Pages
F131000 – F131024	Profiles 000 – 024	16 – 19
F131041 – F131080	Profiles 041 & 080	19 – 23

Limitor Plates (50mm)

Part number	Description	Pages
F132000 – F132024	Limitors 000 – 024	16 – 19
F132041 – F132080	Limitors 041 – 080	19 – 23

Alloy steel (SP) profile knives
(50 x 4mm)

Profiles are shown full size

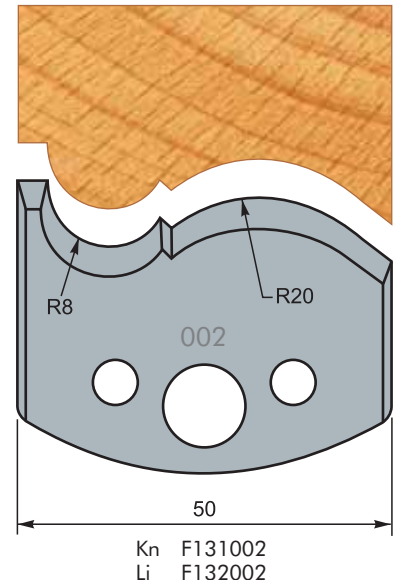
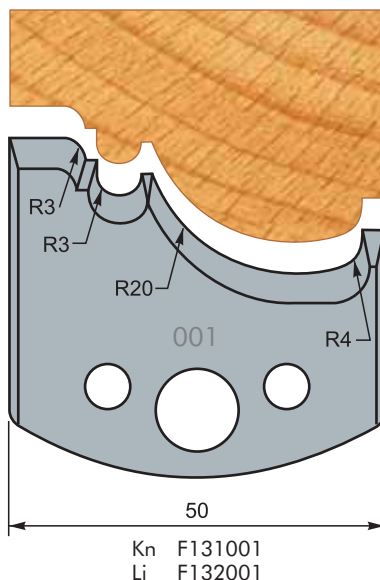
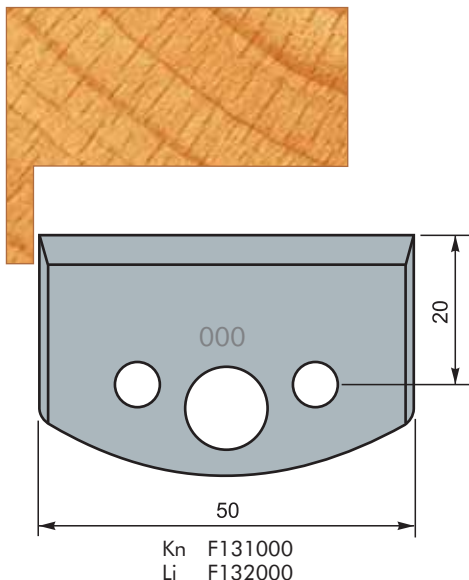

SPINDLE TOOLING



Quality products - quality service

Alloy steel (SP) profile knives
(50 x 4mm)

Profiles are shown full size
from the back of the knife

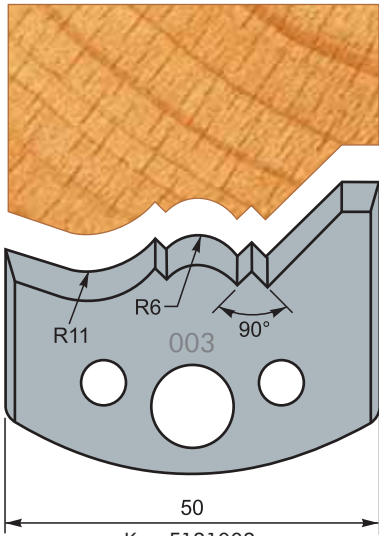

Kn F131003
Li F132003

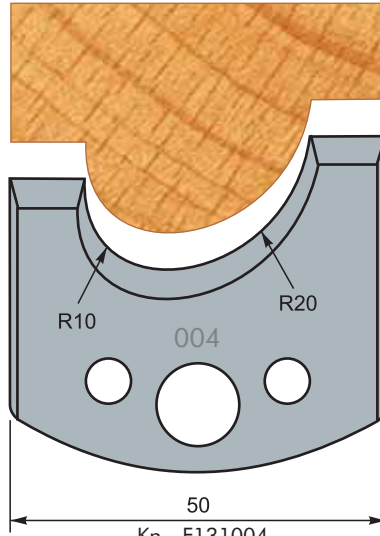

Kn F131004
Li F132004

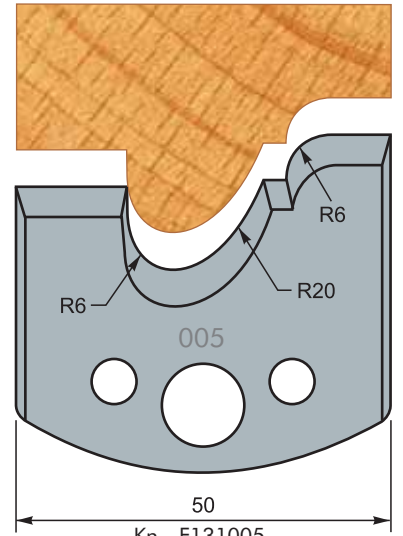

Kn F131005
Li F132005

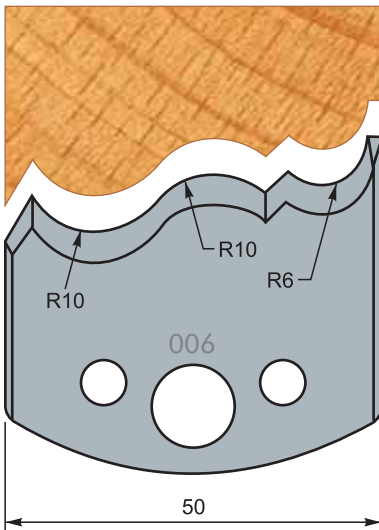

Kn F131006
Li F132006

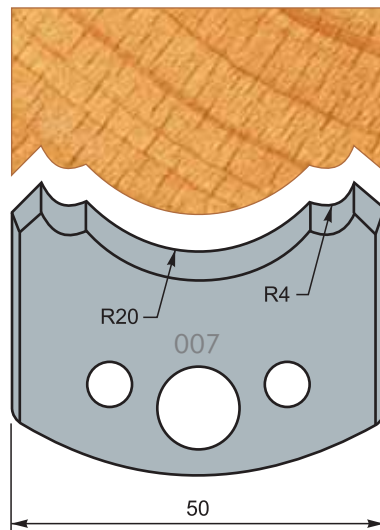

Kn F131007
Li F132007

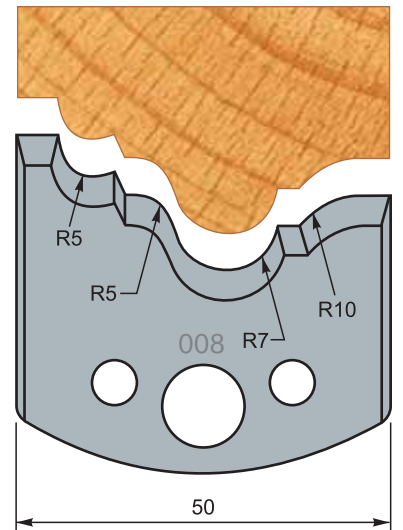

Kn F131008
Li F132008

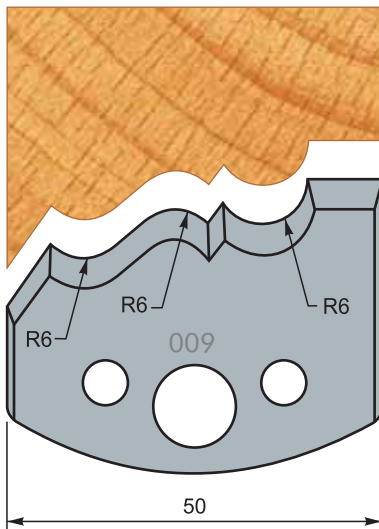

Kn F131009
Li F132009

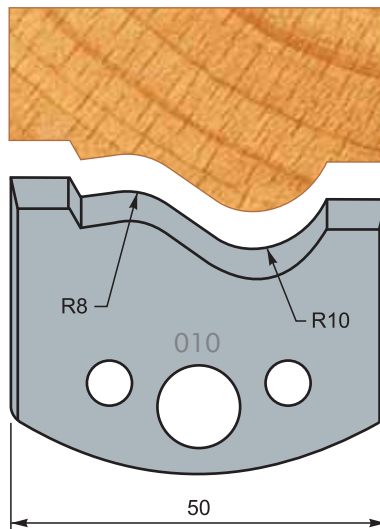

Kn F131010
Li F132010

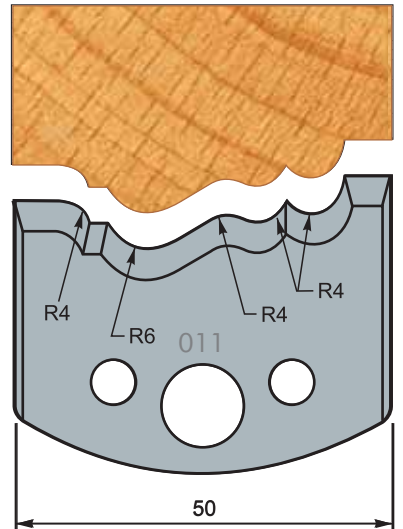

Kn F131011
Li F132011

Alloy steel (SP) profile knives
(50 x 4mm)

Profiles are shown full size
from the back of the knife

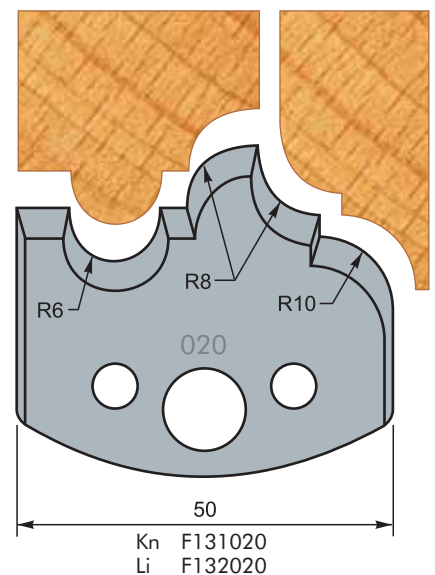
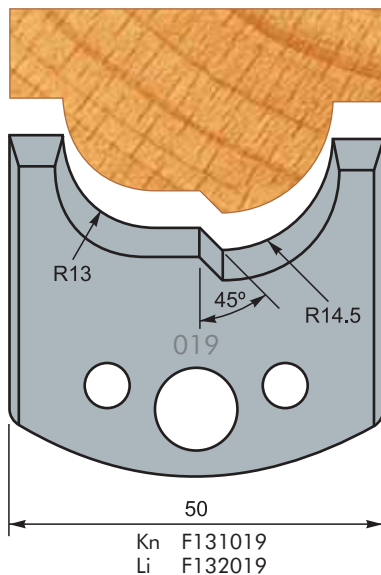
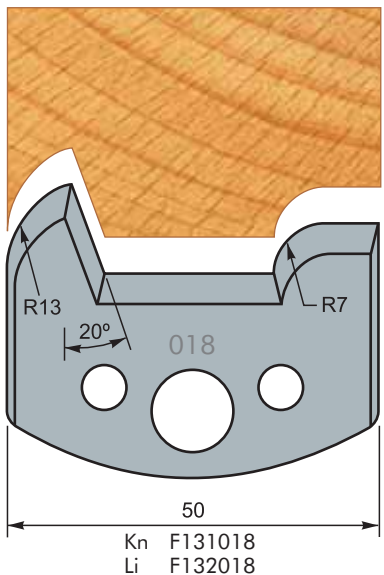
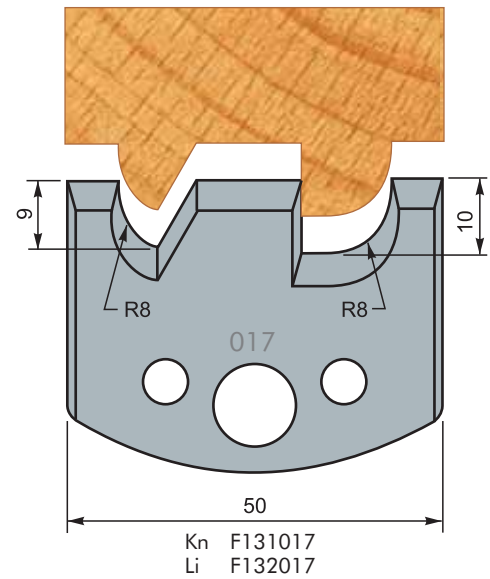
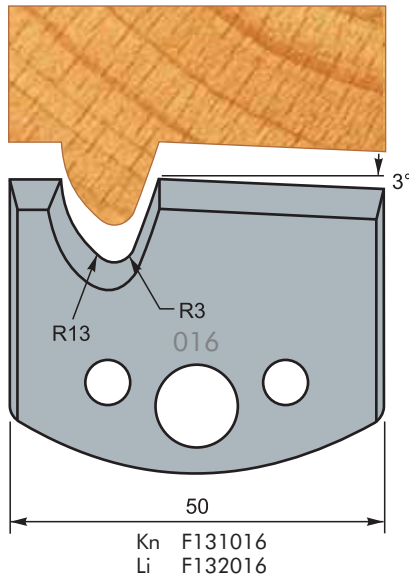
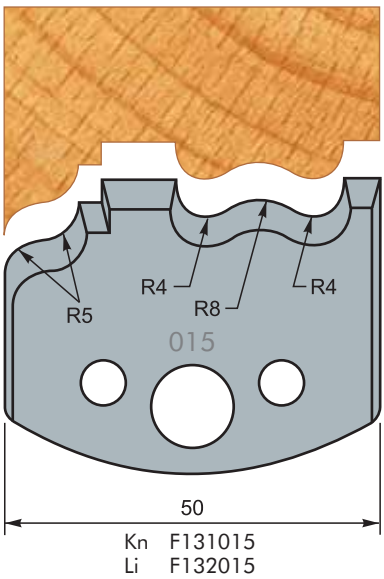
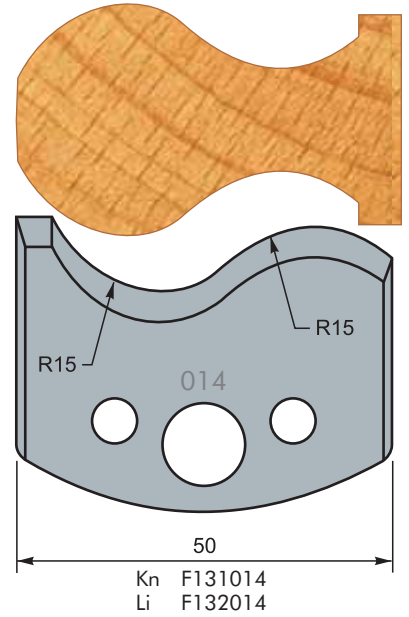
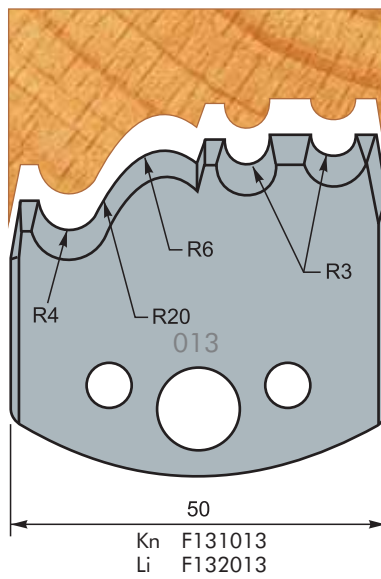
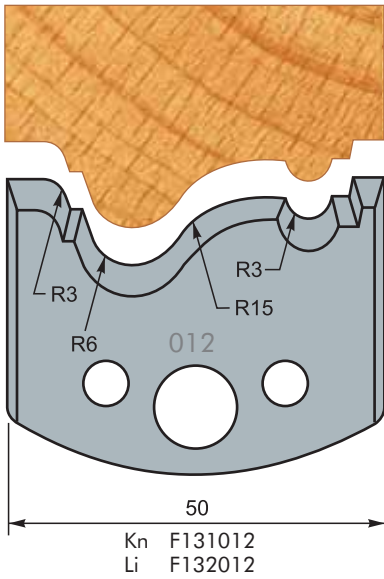

SPINDLE TOOLING



Quality products - quality service

Alloy steel (SP) profile knives
(50 x 4mm)

Profiles are shown full size
from the back of the knife

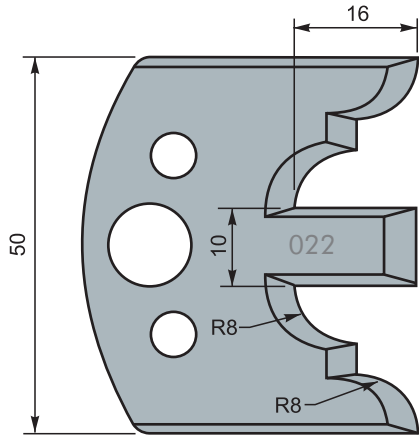

Kn F131022
Li F132022

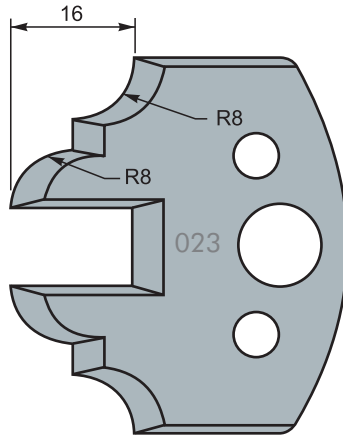

Kn F131023
Li F132023

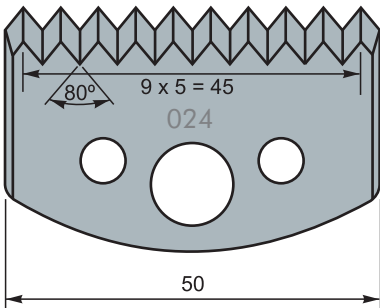
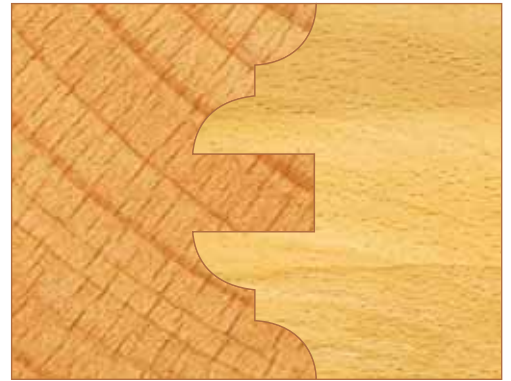

Kn F131024
Li F132024

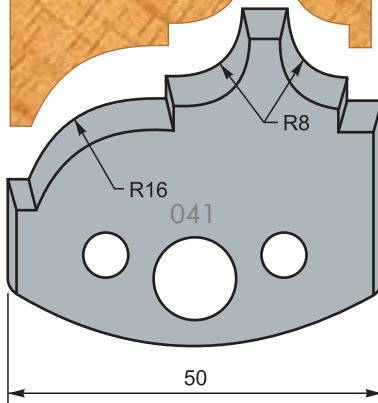
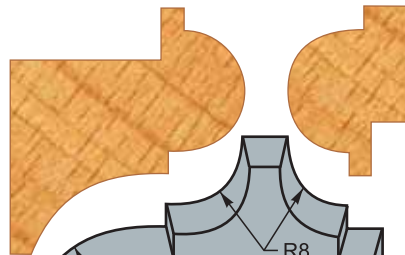

Kn F131041
Li F132041

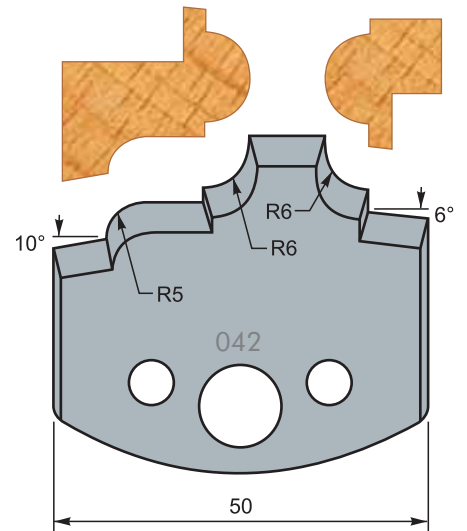

Kn F131042
Li F132042

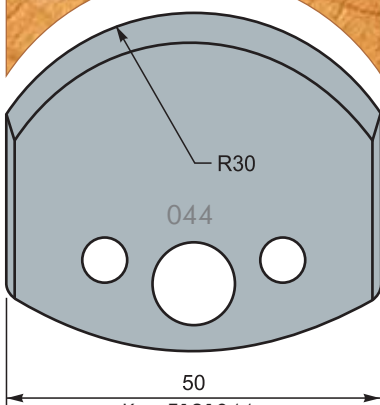
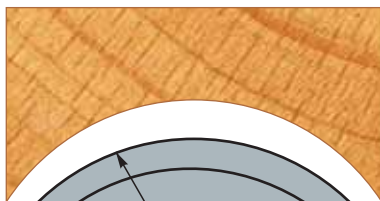

Kn F131044
Li F132044

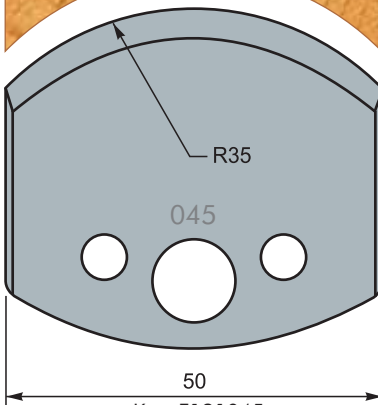

Kn F131045
Li F132045

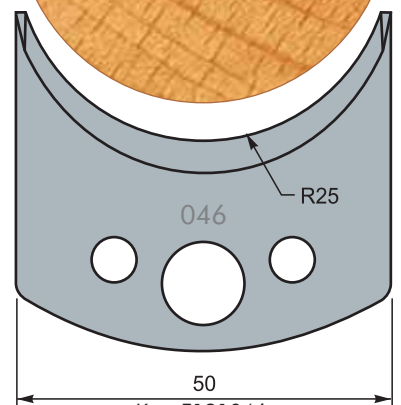
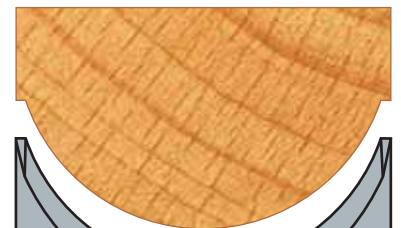

Kn F131046
Li F132046

Alloy steel (SP) profile knives
(50 x 4mm)

Profiles are shown full size
from the back of the knife

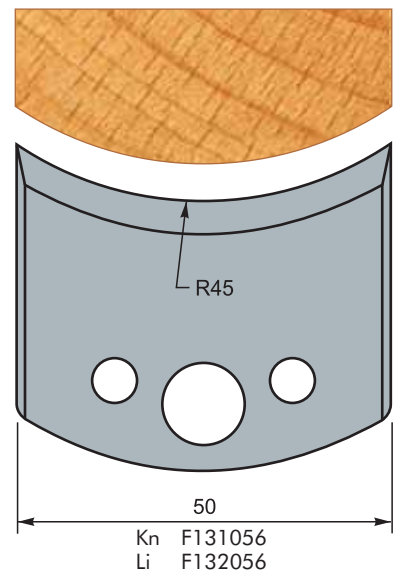
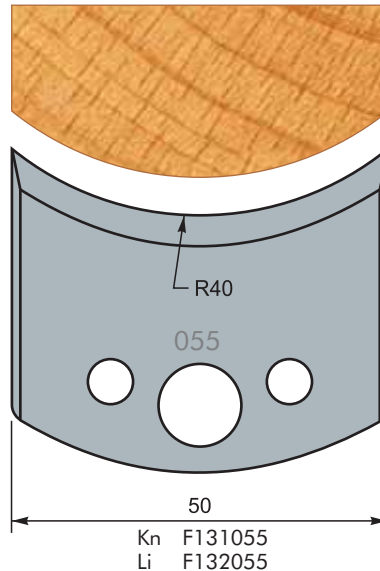
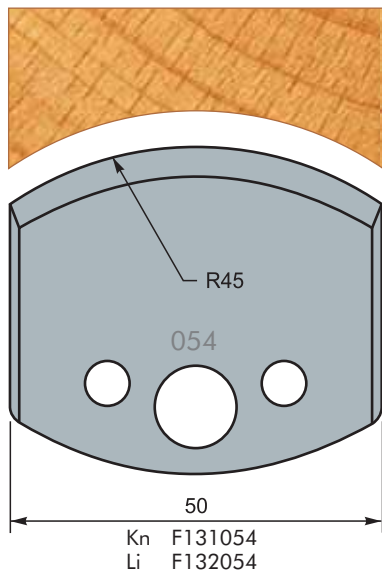
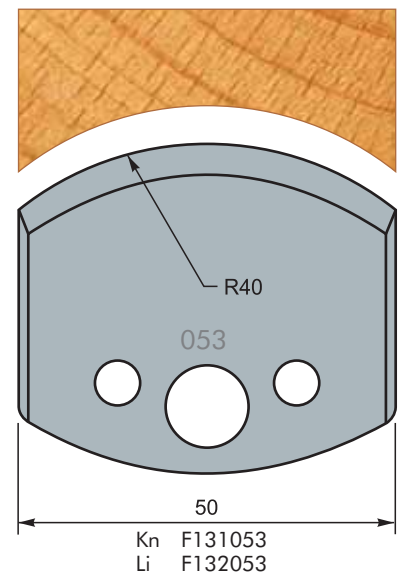
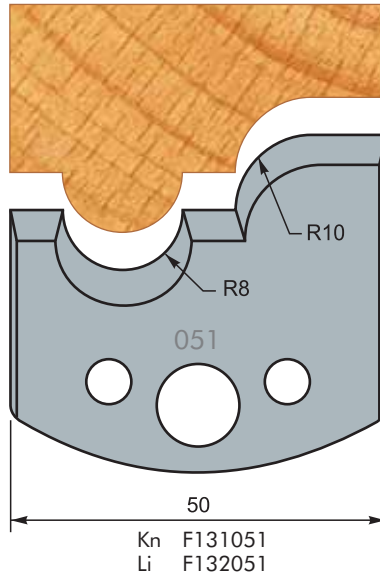
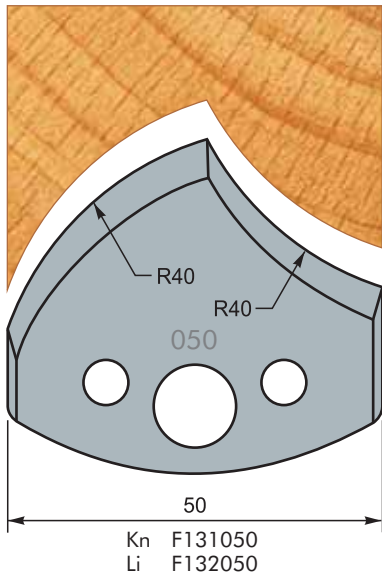
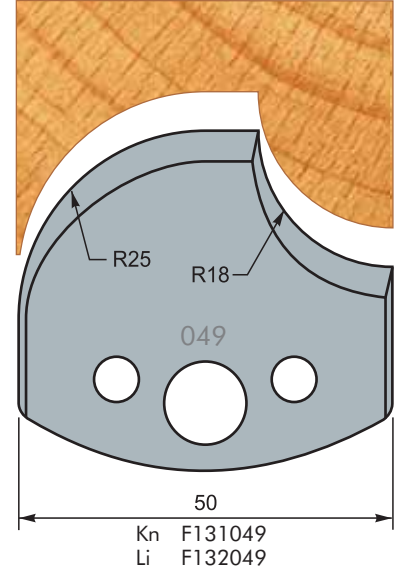
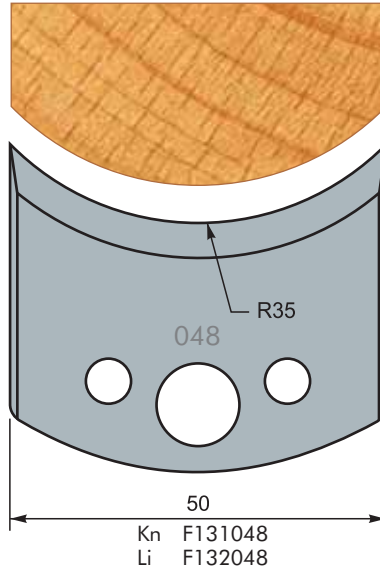
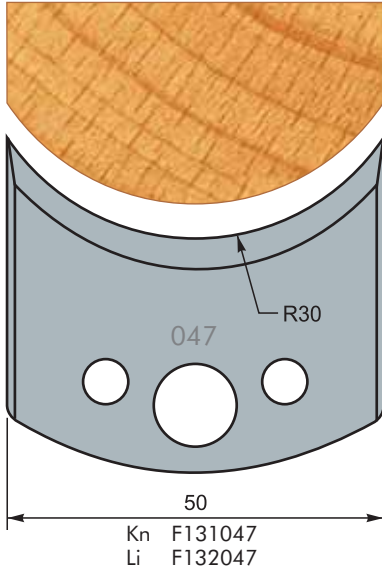

SPINDLE TOOLING



Quality products - quality service

Alloy steel (SP) profile knives
(50 x 4mm)

Profiles are shown full size
from the back of the knife

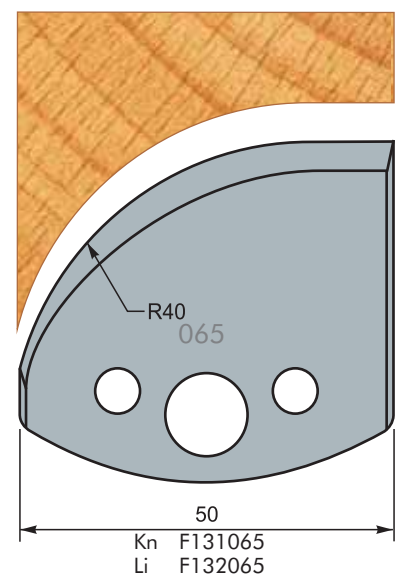
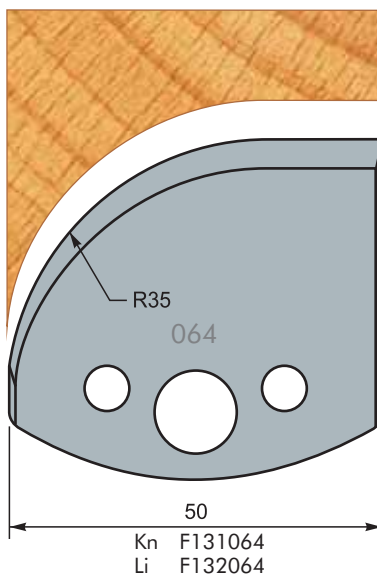
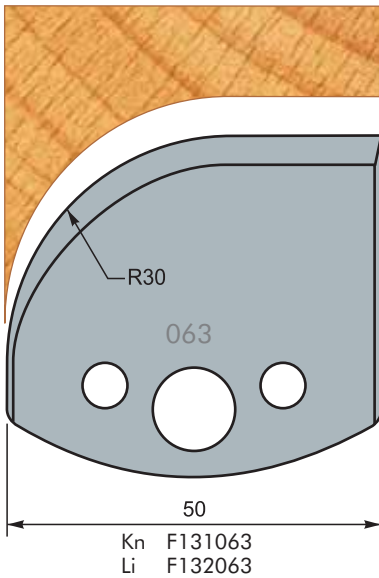
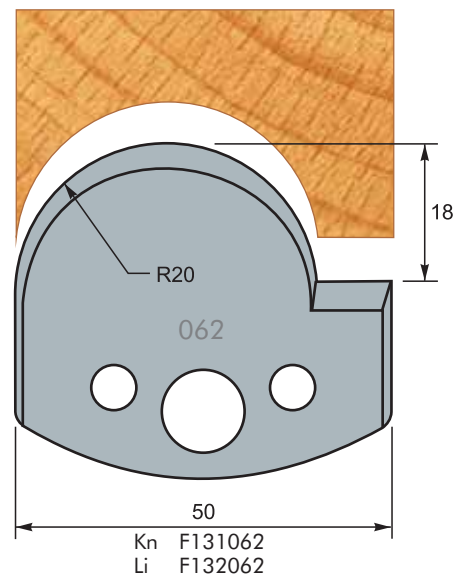
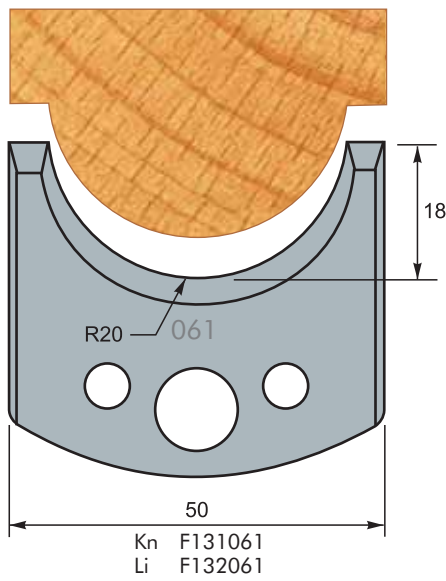
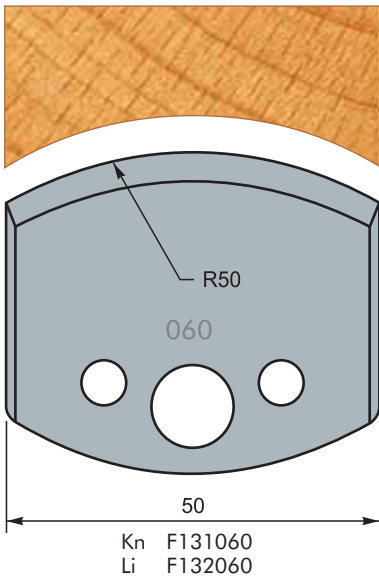
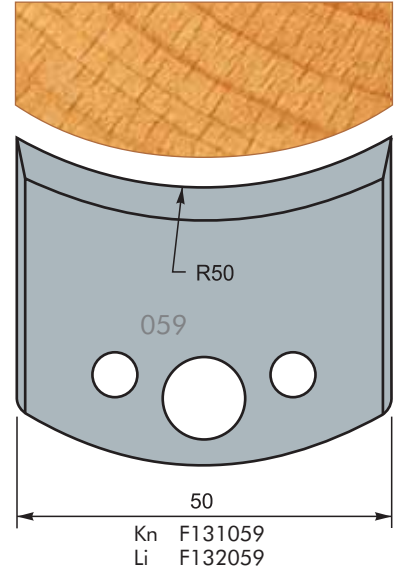
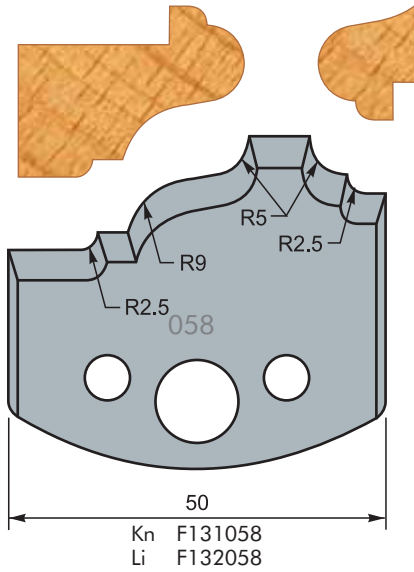
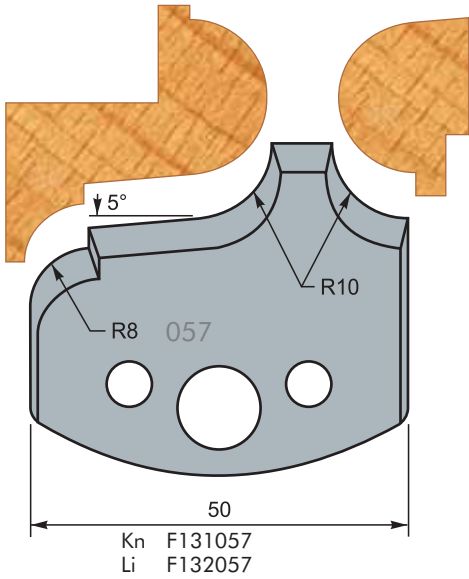

SPINDLE TOOLING



Quality products - quality service

Alloy steel (SP) profile knives
(50 x 4mm)

Profiles are shown full size
from the back of the knife

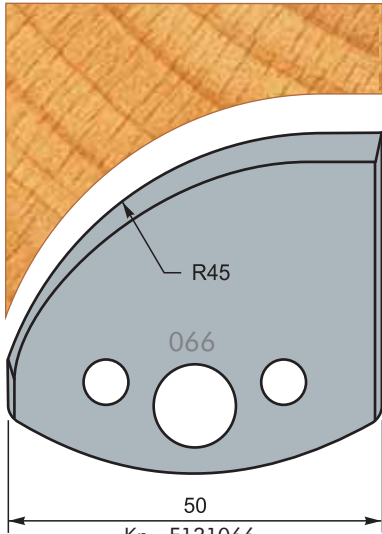

Kn F131066
Li F132066

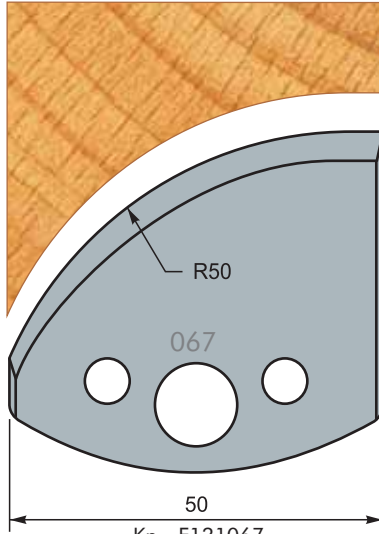

Kn F131067
Li F132067

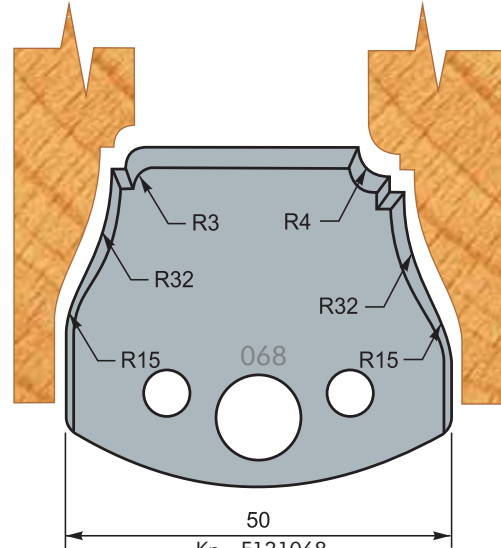

Kn F131068
Li F132068

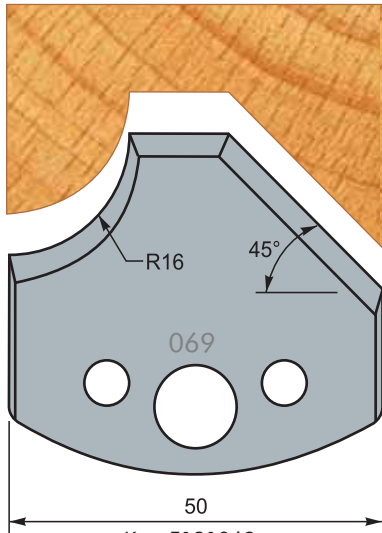

Kn F131069
Li F132069

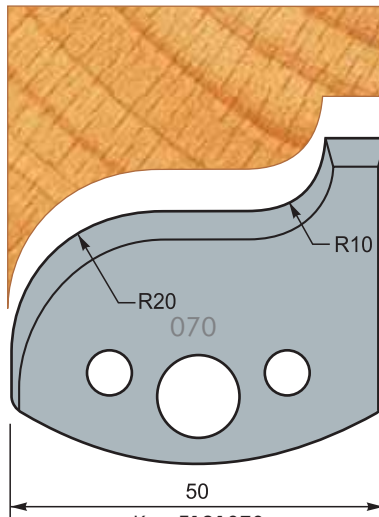

Kn F131070
Li F132070

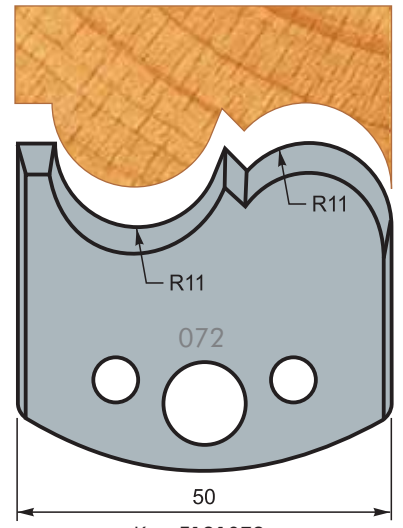

Kn F131072
Li F132072

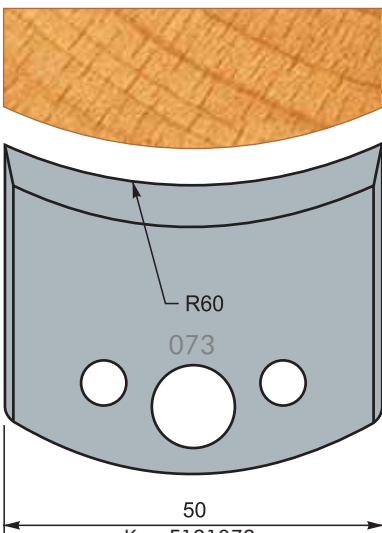

Kn F131073
Li F132073

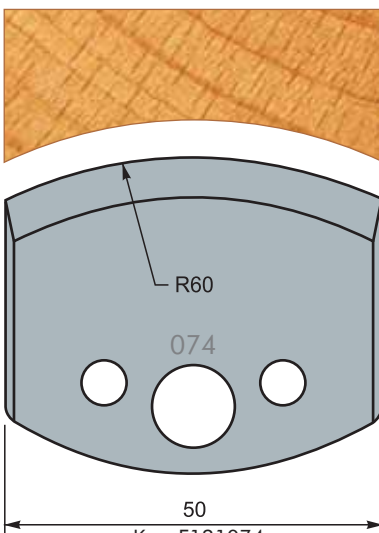

Kn F131074
Li F132074

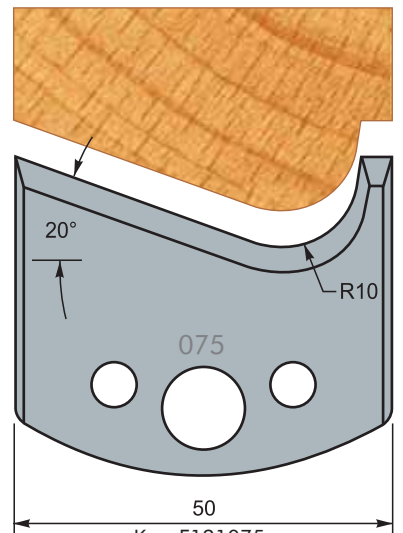

Kn F131075
Li F132075

SPINDLE TOOLING



Quality products - quality service

Alloy steel (SP) profile knives
(50 x 4mm)

Profiles are shown full size
from the back of the knife

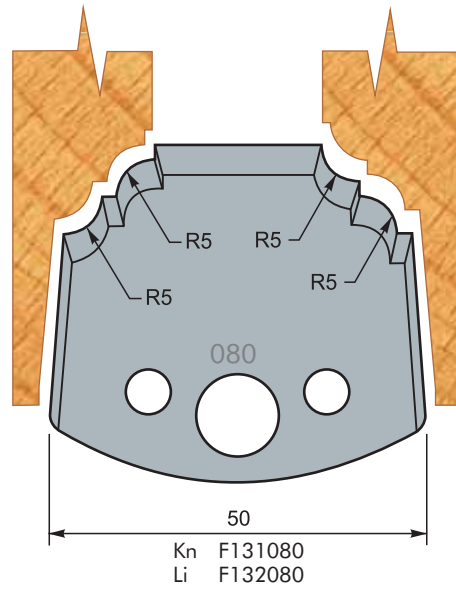
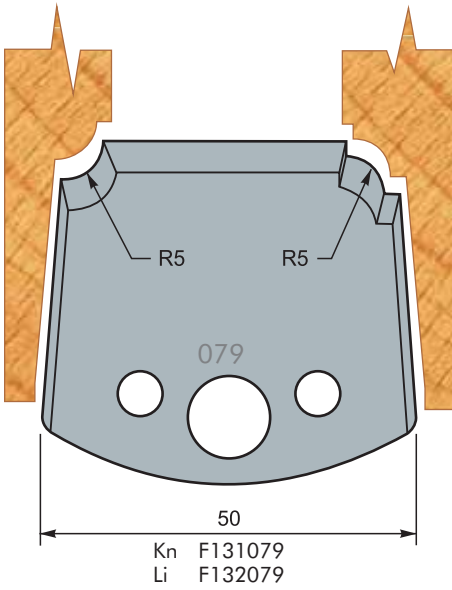
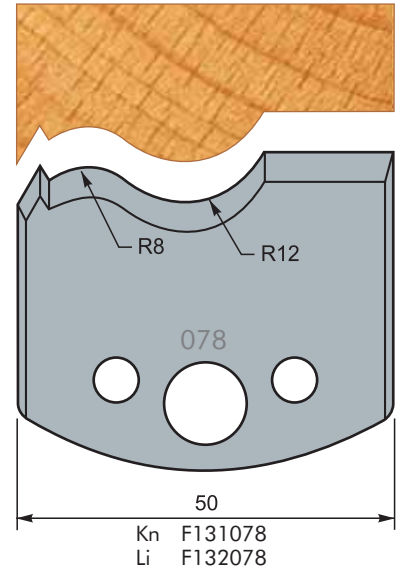
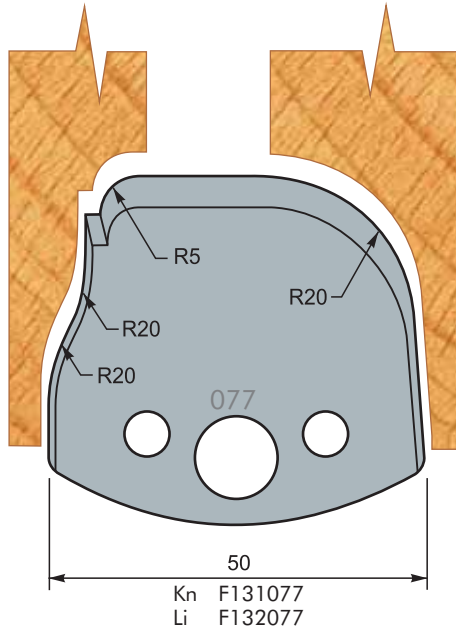
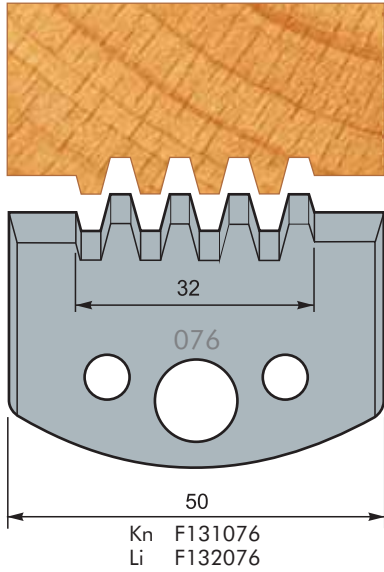

Cutterheads for 50mm x 5.5mm profile knives

Cutterheads for mechanical feed

The mechanical feed cutter heads have locators and clamping for pairs of 5.5mm thickness x 50mm wide profile knives as listed on pages 25 to 34. These heads do not have any form of chip limiting action and are therefore **NOT** suitable for hand feeding. These heads, when fitted with the alloy steel (SP) profile knives, are suitable for jointing, rebating and profile work in un-bonded natural timbers. The blocks are supplied fitted with SP rebate knives.



Please note: The 50mm x 4mm knives will not fit these blocks.

Part number	Size dia. height bore	Body material	Cutting dia. with rebate knives	Maximum RPM
F230100	100 50 30	Steel	115mm	7,100
F230103	100 50 1¼"	Steel	115mm	7,100

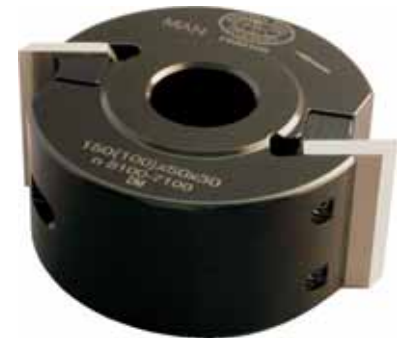

Mechanical feed head

Cutterheads for hand feed

These hand feed cutter heads have locators and clamping for pairs of 5.5mm thickness x 50mm wide profile knives and limitors as listed on pages 25 to 34. These heads are chip limited and are therefore suitable for use with hand feed spindle moulders. These heads, when fitted with the alloy steel (SP) profile knives and limitors, are suitable for jointing, rebating and profile work in un-bonded natural timbers. The blocks are supplied fitted with SP rebate knives and limitors.

Please note: The 50mm x 4mm knives will not fit these blocks.



Manufactured to EN847-1/2 - suitable for HAND FEEDING.

Part number	Size dia. height bore	Body material	Cutting dia. with mounted rebate knives	Maximum RPM
F240102	100 50 30	Steel	115mm	10,000
F240103	100 50 1¼"	Steel	115mm	10,000
F240120	120 50 30	Aluminium	135mm	6,600



Hand feed head – BG test

Alloy steel (SP) profile knives
(50 x 5.5mm)

Profiles are shown full size
from the back of the knife

Profile knives, limitors & blanks – 50mm x 5.5mm range

A range of 50mm wide SP alloy steel profile knives, limitors and blanks. These heavy duty profile knives and limitors have a thickness of 5.5mm and will fit any of the blocks listed on page 24 and F251550, F251553 on page 40. *SP grade steel profile knives are suitable for cutting soft and hard woods but are NOT suitable for man made boards e.g. MDF.*

These 5.5mm knives and limitors will **NOT** fit in blocks designed for 4mm thick knives.

ORDERING INFORMATION: Order using the part numbers shown against the profile knife illustrations on the following pages. For the matching limitors, replace the "141" in the part number with "142" (e.g. limitors part number for profile F141204 is F142204).

PRICES for knives, limitors and blanks are per pair.



Alloy Steel (SP) Profile Knives (50mm)

Part number	Description
F141200	Rebate knife
F141201 – F141274	Profiles 201 – 274



Limitor Plates (50mm)

Part number	Description
F142200	Rebate limitor
F142201 - F142274	Limitors 201 - 274

Blanks (50mm)

Part number	Description
F141292	Blank - SP (32mm)
F142292	Limitor blank (32mm)
F141293	Blank - SP (42mm)
F142293	Limitor blank (42mm)

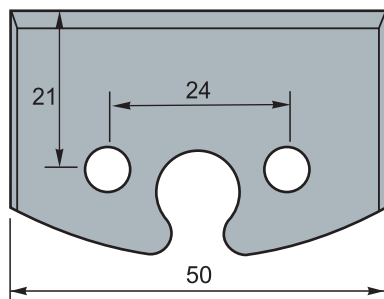

Rebate
Kn F141200
Li F142200

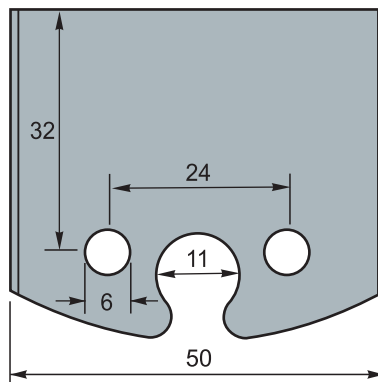

Blank
Kn F141292
Li F142292

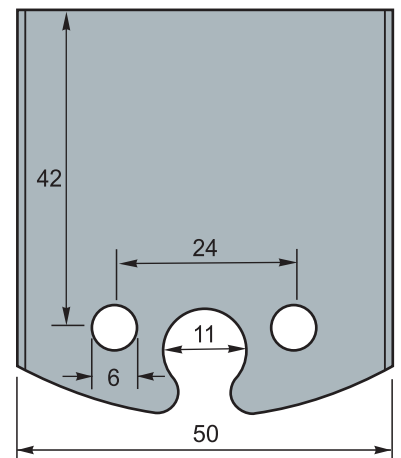

Blank
Kn F141293
Li F142293

SPINDLE TOOLING



Quality products - quality service

Alloy steel (SP) profile knives
(50 x 5.5mm)

Profiles are shown full size
from the back of the knife

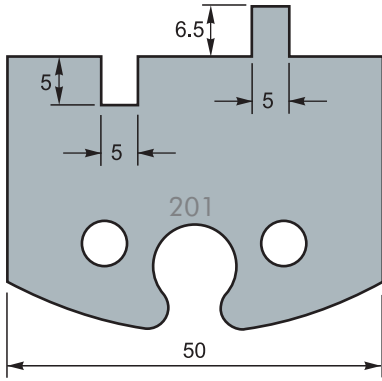

Kn F141201
Li F142201

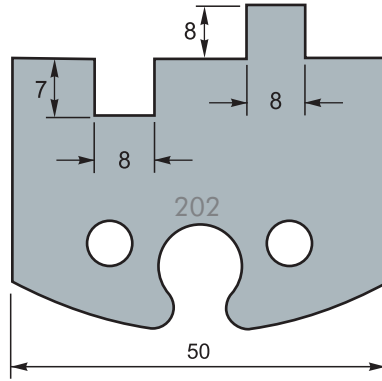

Kn F141202
Li F142202

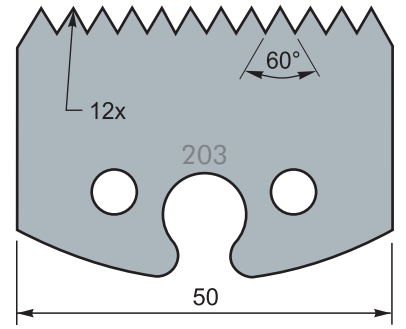

Kn F141203
Li F142203

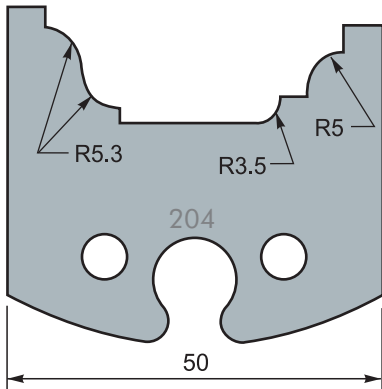

Kn F141204
Li F142204

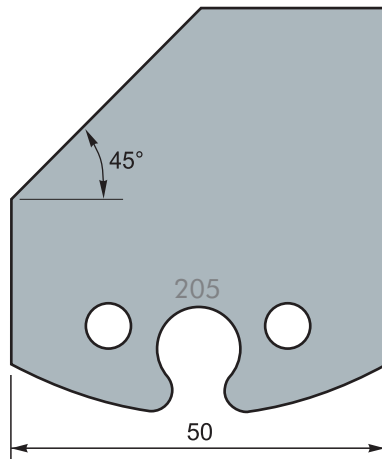

Kn F141205
Li F142205

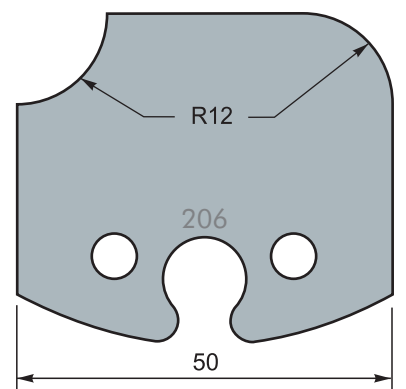

Kn F141206
Li F142206

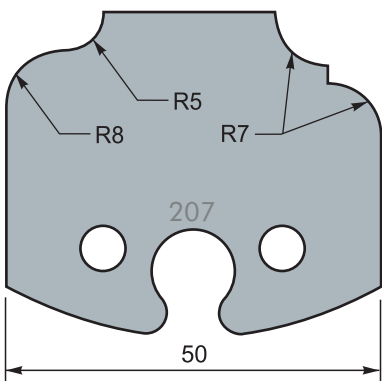

Kn F141207
Li F142207

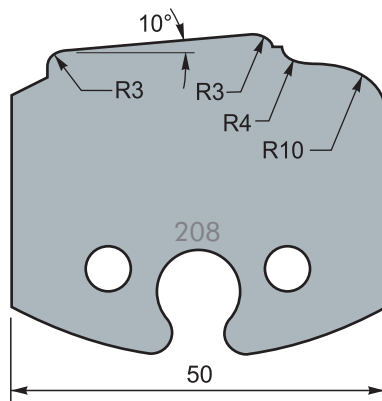

Kn F141208
Li F142208

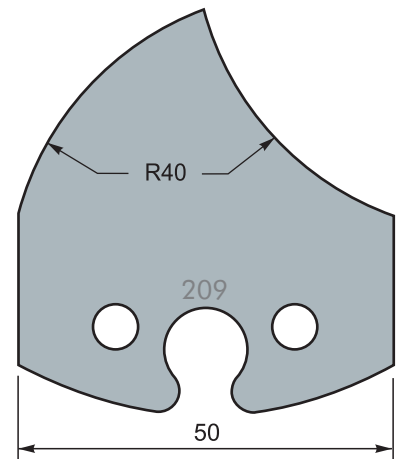

Kn F141209
Li F142209

SPINDLE TOOLING



Quality products - quality service

Alloy steel (SP) profile knives
(50 x 5.5mm)

Profiles are shown full size
from the back of the knife

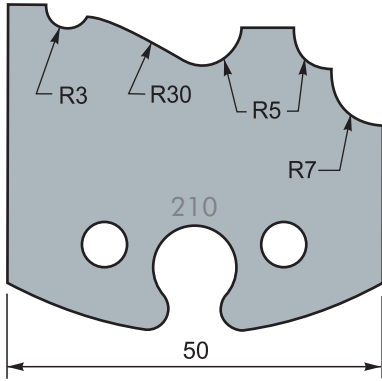

Kn F141210
Li F142210

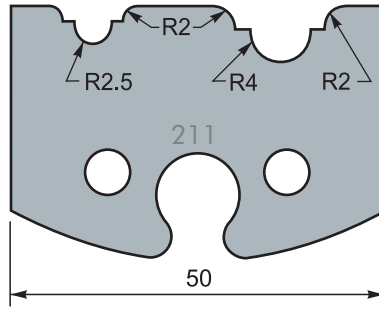

Kn F141211
Li F142211

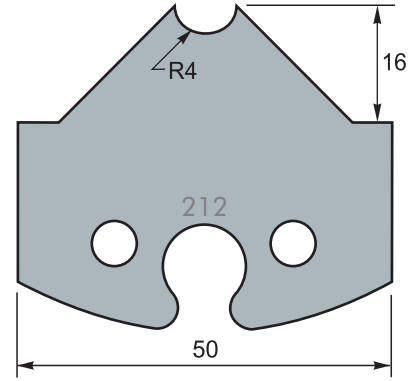

Kn F141212
Li F142212

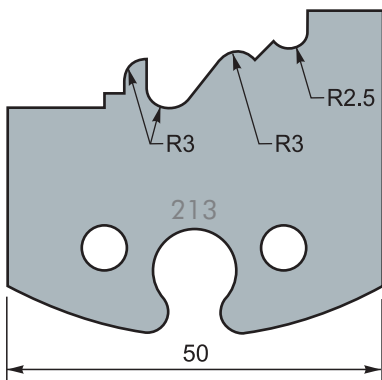

Kn F141213
Li F142213

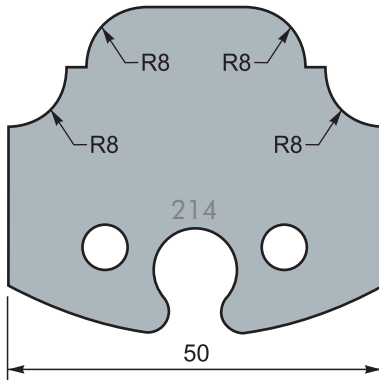

Kn F141214
Li F142214

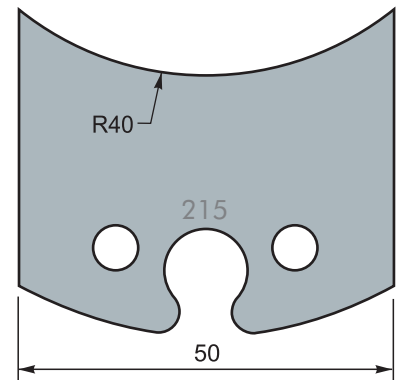

Kn F141215
Li F142215

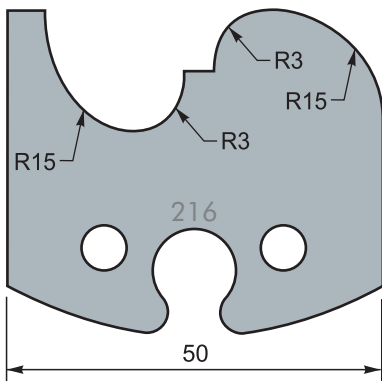

Kn F141216
Li F142216

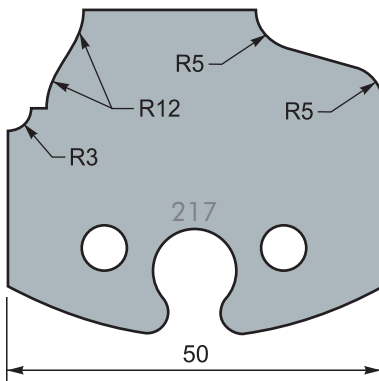

Kn F141217
Li F142217

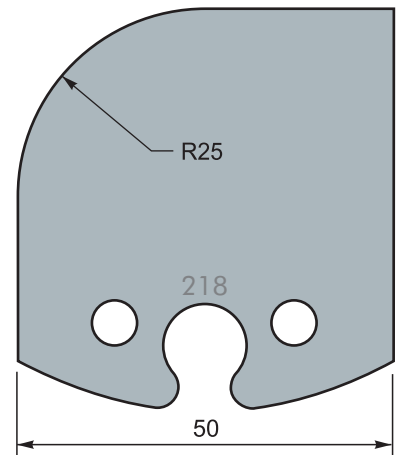

Kn F141218
Li F142218

SPINDLE TOOLING



Quality products - quality service

Alloy steel (SP) profile knives
(50 x 5.5mm)

Profiles are shown full size
from the back of the knife

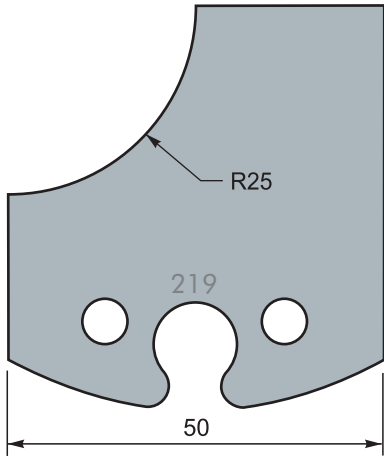

Kn F141219
Li F142219

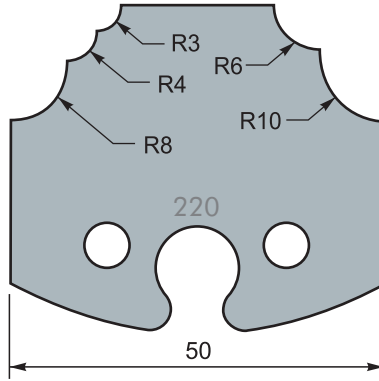

Kn F141220
Li F142220

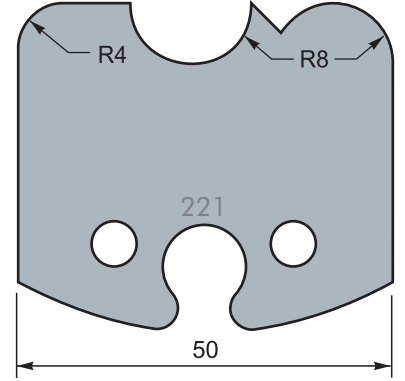

Kn F141221
Li F142221

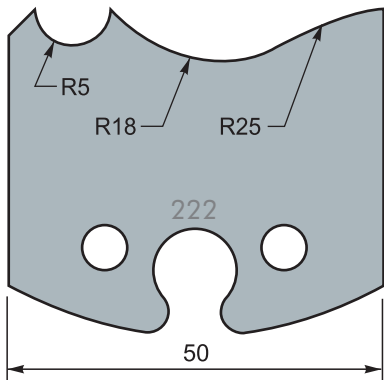

Kn F141222
Li F142222

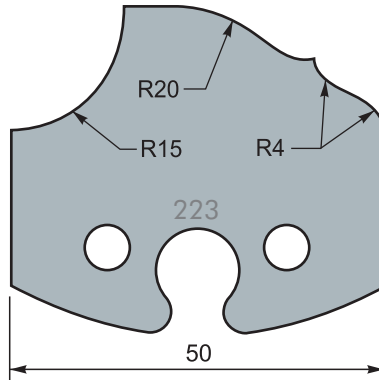

Kn F141223
Li F142223

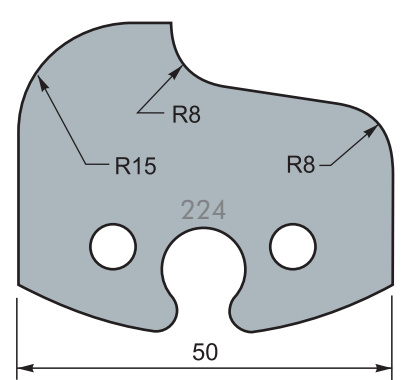

Kn F141224
Li F142224

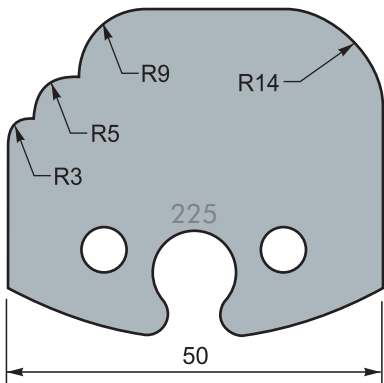

Kn F141225
Li F142225

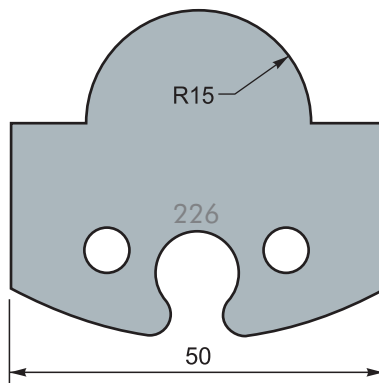

Kn F141226
Li F142226

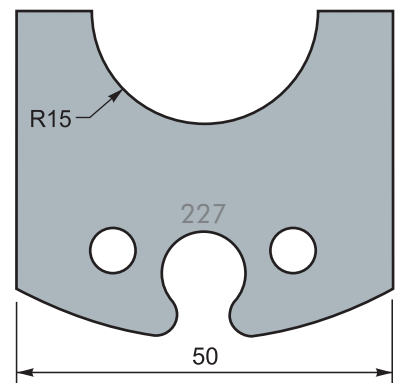

Kn F141227
Li F142227

SPINDLE TOOLING



Quality products - quality service

Alloy steel (SP) profile knives
(50 x 5.5mm)

Profiles are shown full size
from the back of the knife

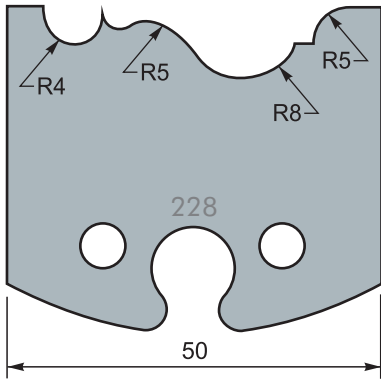

Kn F141228
Li F142228

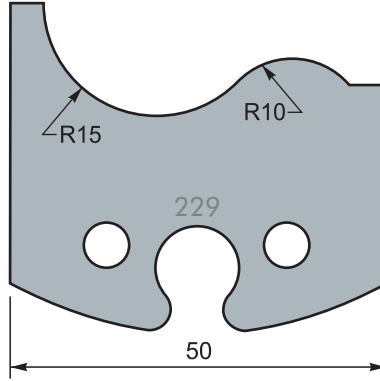

Kn F141229
Li F142229

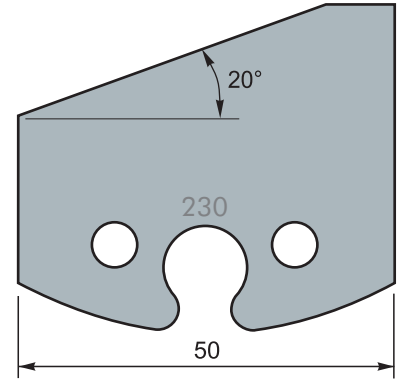

Kn F141230
Li F142230

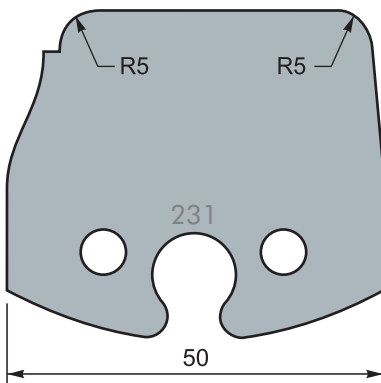

Kn F141231
Li F142231

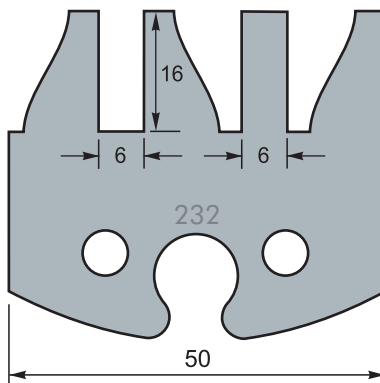

Kn F141232
Li F142232

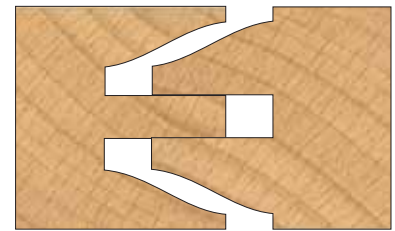

Profile F141232 will produce a matching scribed joint, moulded on both sides, as shown above. A timber thickness of 28-30mm is required.

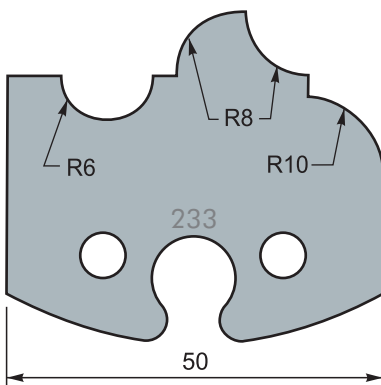

Kn F141233
Li F142233

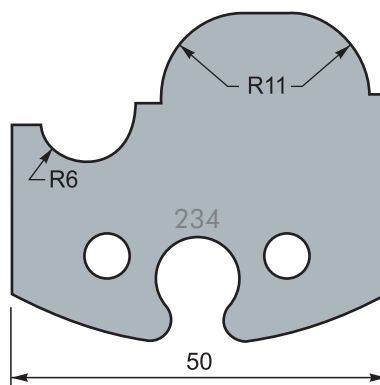

Kn F141234
Li F142234

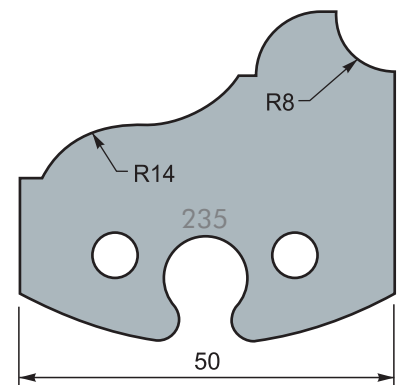

Kn F141235
Li F142235

SPINDLE TOOLING



Quality products - quality service

Alloy steel (SP) profile knives
(50 x 5.5mm)

Profiles are shown full size
from the back of the knife

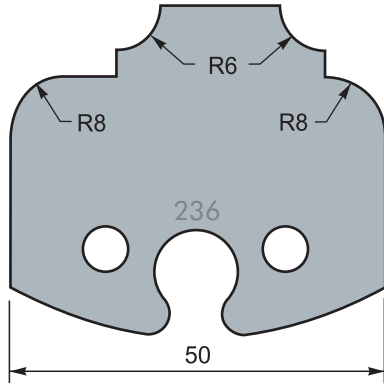

Kn F141236
Li F142236

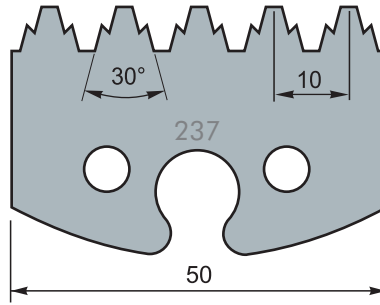

Kn F141237
Li F142237

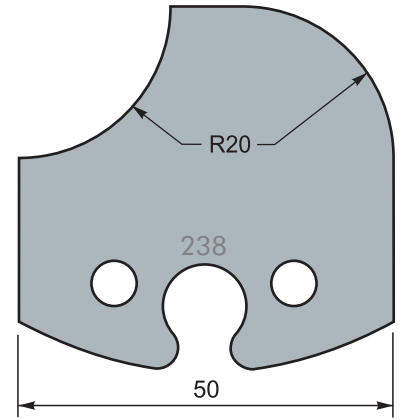

Kn F141238
Li F142238

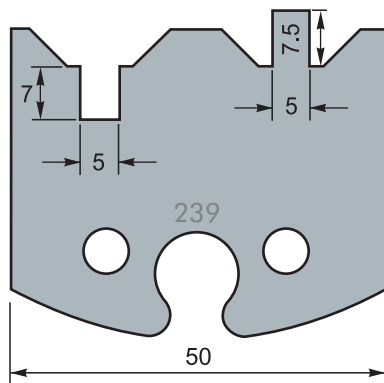

Kn F141239
Li F142239

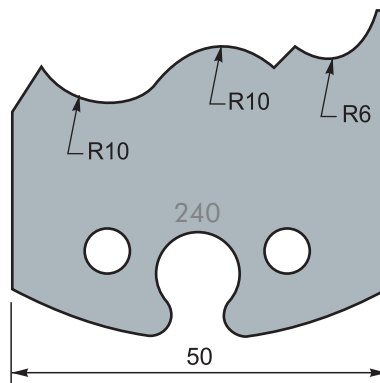

Kn F141240
Li F142240

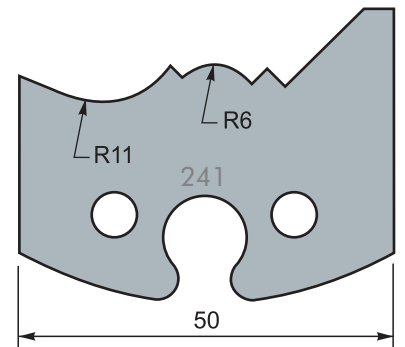

Kn F141241
Li F142241

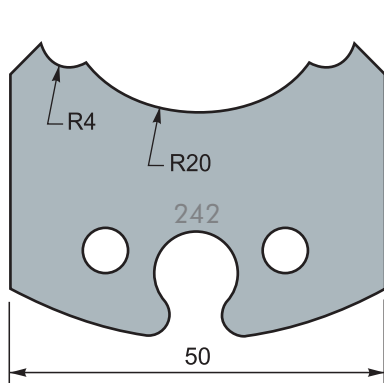

Kn F141242
Li F142242

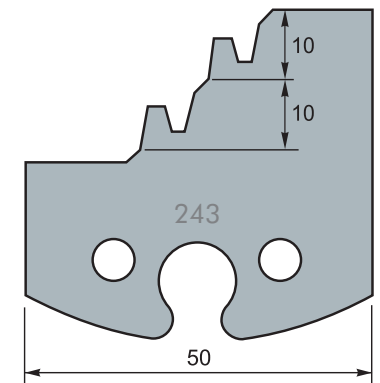

Kn F141243
Li F142243

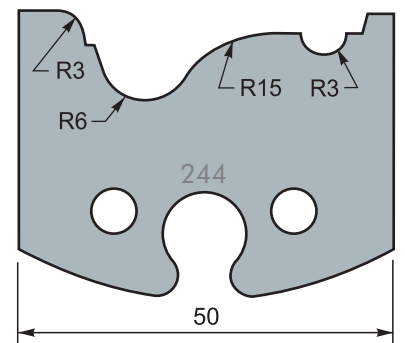

Kn F141244
Li F142244

SPINDLE TOOLING



Quality products - quality service

Alloy steel (SP) profile knives
(50 x 5.5mm)

Profiles are shown full size
from the back of the knife

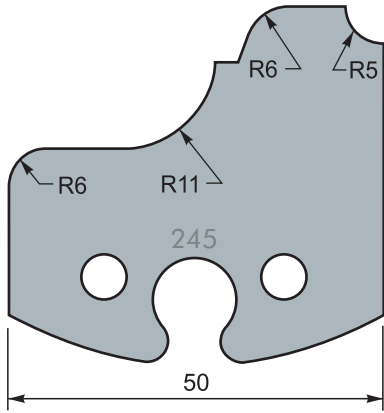

Kn F141245
Li F142245

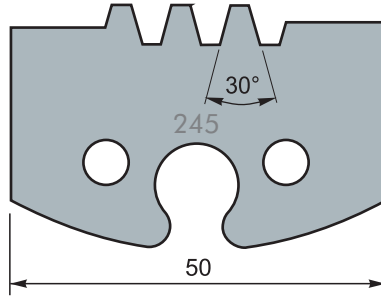

Kn F141246
Li F142246

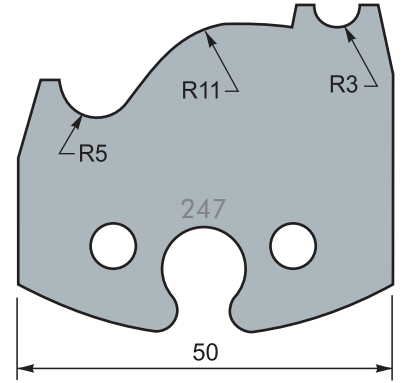

Kn F141247
Li F142247

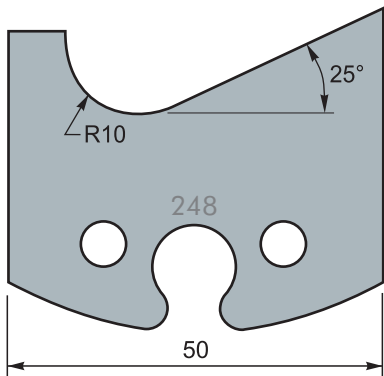

Kn F141248
Li F142248

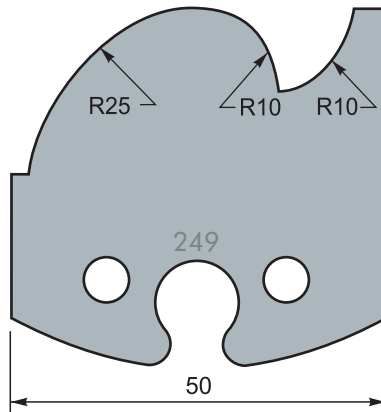

Kn F141249
Li F142249

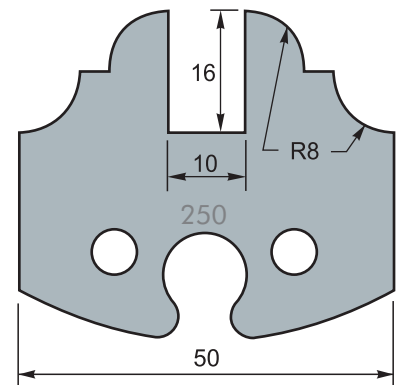

Kn F141250
Li F142250

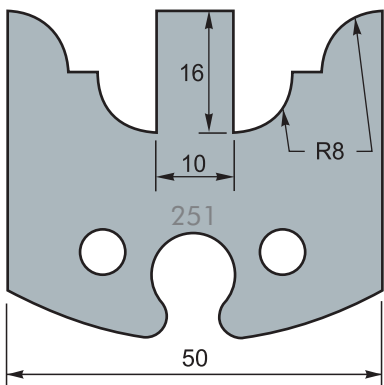

Kn F141251
Li F142251

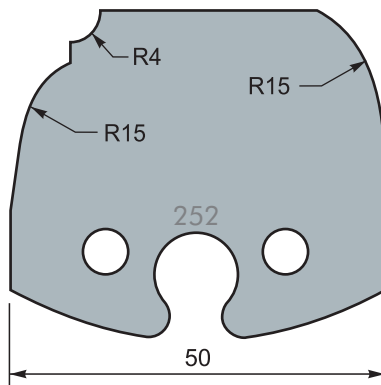

Kn F141252
Li F142252

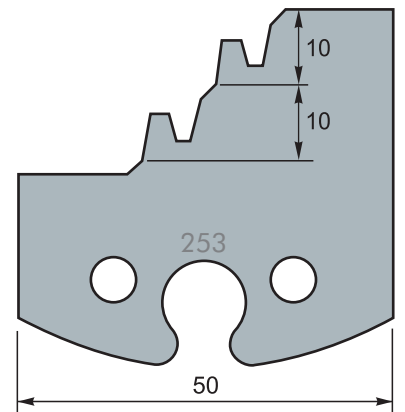

Kn F141253
Li F142253

Alloy steel (SP) profile knives
(50 x 5.5mm)

Profiles are shown full size
from the back of the knife

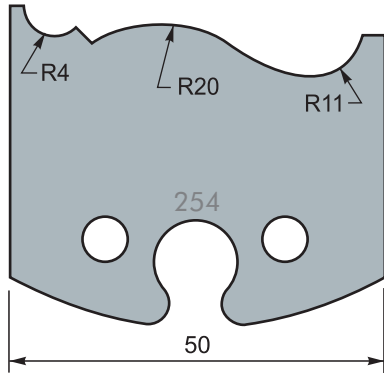

Kn F141254
Li F142254

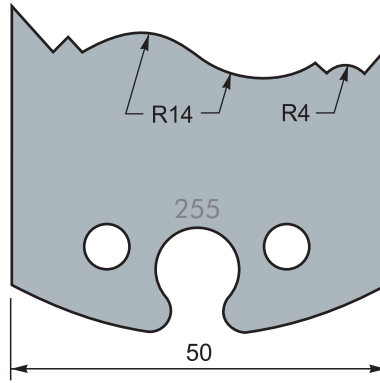

Kn F141255
Li F142255

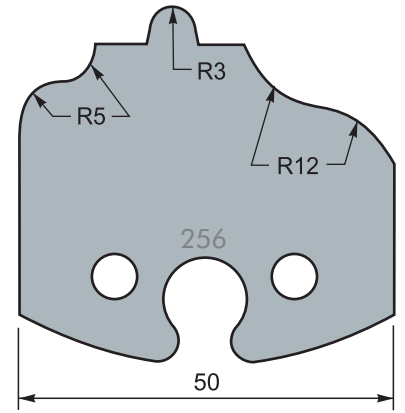

Kn F141256
Li F142256

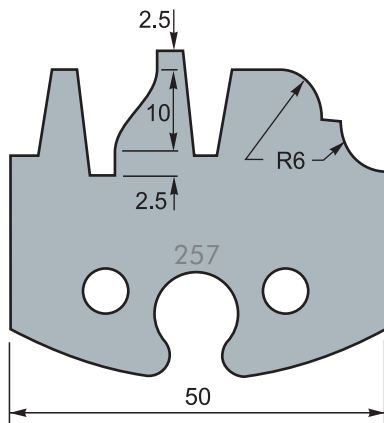

Kn F141257
Li F142257

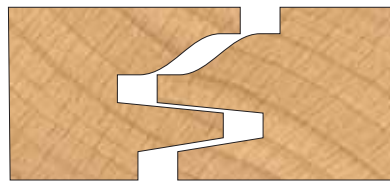

Profile F141257 will produce a matching scribed joint as shown above. One part is cut face down and the other face up. Maximum timber thickness 23mm.

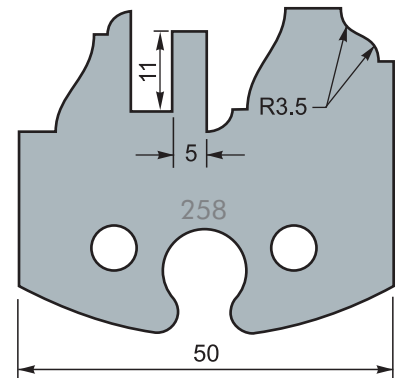

Kn F141258
Li F142258

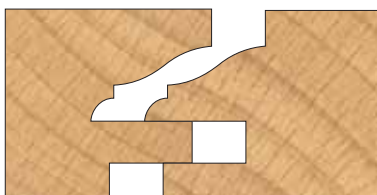

Profile F141258 will produce a matching scribed joint as shown above. One part is cut face down and the other face up. Maximum timber thickness 25mm.

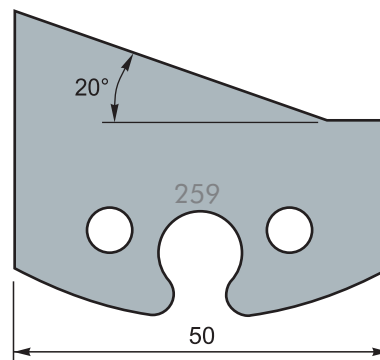

Kn F141259
Li F142259

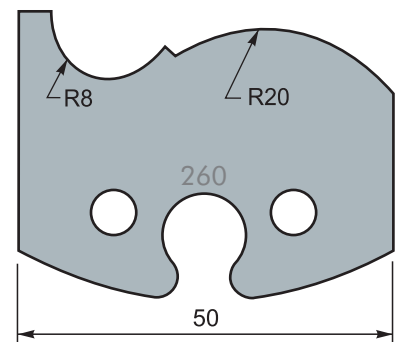

Kn F141260
Li F142260

SPINDLE TOOLING



Quality products - quality service

Alloy steel (SP) profile knives
(50 x 5.5mm)

Profiles are shown full size
from the back of the knife

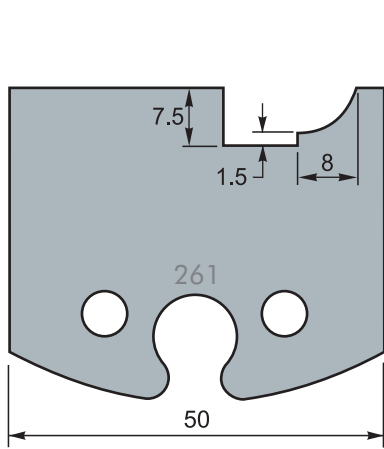

Kn F141261
Li F142261

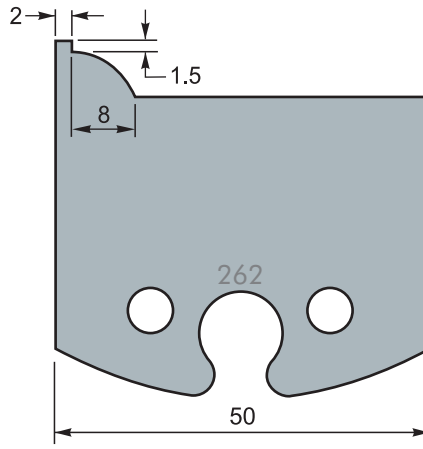

Kn F141262
Li F142262

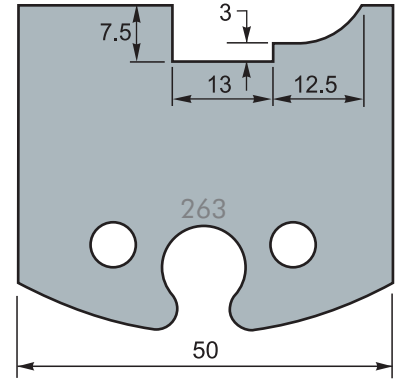

Kn F141263
Li F142263

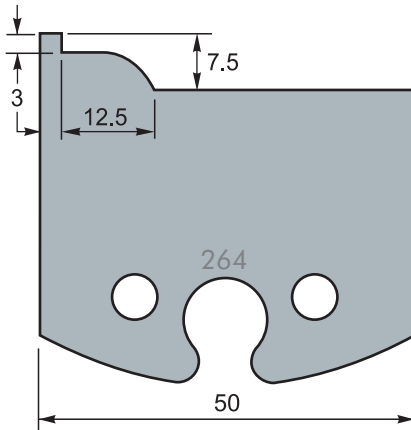

Kn F141264
Li F142264

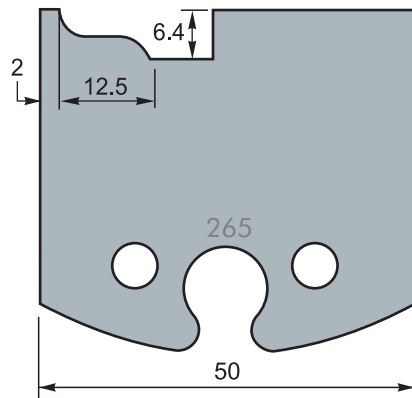

Kn F141265 *
Li F142265

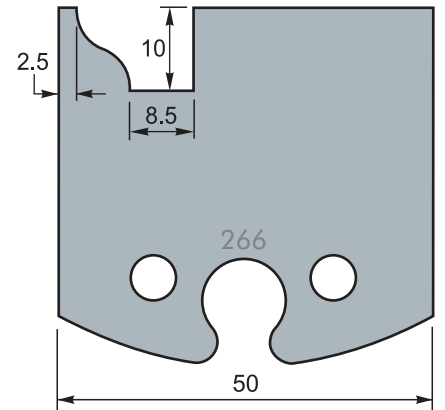

Kn F141266 *
Li F142266

* These knives will cut both the profile and scribe by reversing the work

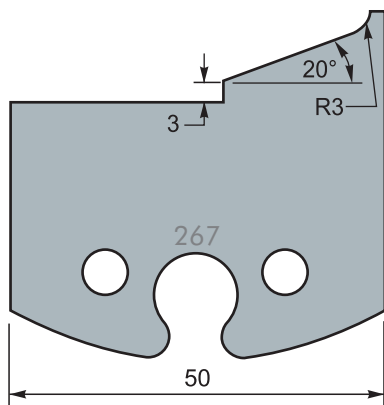

Kn F141267
Li F142267

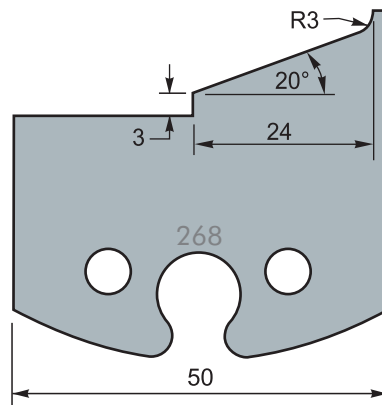

Kn F141268
Li F142268

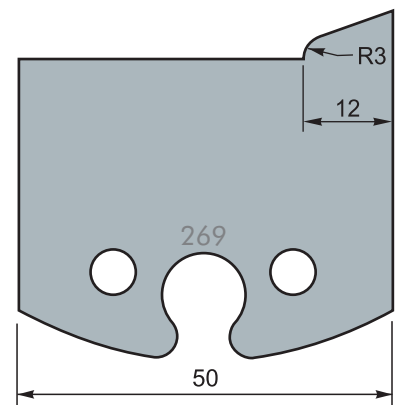

Kn F141269
Li F142269

Rebate blocks with TC disposable inserts

Replaceable tip cutter heads for rebating in softwoods, hardwoods and all man-made boards. Heads are manufactured in steel and all have 2 cutting flutes and 4 scribes. The easily replaceable tips ensure consistent performance and fast set up.



Manufactured to EN847-1/2 - suitable for HAND FEEDING.

Part number	Size			Body material	Maximum rebate depth	Maximum RPM
	dia.	height	bore			
F252100	100	30	30	Steel	20mm	13,300
F252150	100	50	30	Steel	20mm	13,300
F252170	125	50	30	Steel	30mm	13,300
F252173	125	50	1¼"	Steel	30mm	13,300



Shear rebate blocks with TC disposable inserts

Replaceable tip cutter heads for rebating in softwoods, hardwoods and all man-made boards. Heads are available in steel and all have 4 tungsten scribes and 4 tungsten knives. The easily replaceable tips ensure consistent performance and fast set up. Shear angle cutting reduces tear out and improves the quality of cut.



Manufactured to EN847-1/2 - suitable for HAND FEEDING.

Part number	Size			Body material	Maximum rebate depth	Maximum RPM	Knives
	dia.	height	bore				
F253320	125	50	30	Steel	26mm	9,000	4 + 4
F253130	125	60	30	Steel	27mm	10,300	4 + 4
F253350	150	60	30	Steel	40mm	9,000	4 + 4
F253353	150	60	1¼"	Steel	40mm	9,000	4 + 4



F253130

Replacement tungsten carbide knives and scribes

Replacement TC knives and scribes for use with blocks listed on this page.

N.B. All blocks are supplied fitted with one set of knives and scribes. All TC knives are priced and sold singly.

Part number	Knife size (mm)			For use with
F001030	30	12	1.5	F252100
F001050	50	12	1.5	50mm height blocks
F001060	60	12	1.5	60mm height blocks
F001014	14	14	2.0	Scribe for all blocks





Stackable planer cutterheads with TC disposable inserts

Steel cutterhead with TC knives that can be stacked to build up the cutting height required. May be used on power feed spindle and four-head moulders. Suitable for semi finishing work as the tolerance from block to block will be within 0.03 to 0.05mm. The cutters are staggered and the blocks interlock to prevent them spinning against each other.

Manufactured to EN847-1/2 - suitable for HAND FEEDING.

Part number	Size			Knives	Maximum RPM
	dia.	height	bore		
F254030	125	30	30	4	9,000
F254033	125	30	1 1/4"	4	9,000
F254050	125	50	30	4	9,000
F254053	125	50	1 1/4"	4	9,000



Blades and spare parts

Replacement TC knives and spares for the stackable planer heads.

N.B. All blocks are supplied fitted with one set of knives.
All TC knives are priced and sold singly.

Part number	Description
F001030	TC knife 30 x 12 x 1.5mm
F001050	TC knife 50 x 12 x 1.5mm
F003128	Clamp screw M8
F002022	Clamp Wedge 28mm
F002023	Clamp Wedge 48mm

Spiral planer cutterhead with TC disposable inserts

This cutterhead is manufactured from hard wearing light metal alloy and is suitable for planing and jointing in soft woods, hard woods and man-made board, including veneered and laminated material. May be used with a guide bearing or ring fence for planing and shaping curved work with a template. The 62mm diameter block is especially suitable for use on lighter machines. Please note the diameter given is nominal and may vary by ± 0.5 mm.

Manufactured to EN847-1/2 - suitable for HAND FEEDING.

Part number	Size			Knives	Maximum RPM
	dia.	height	bore		
F258080	62	80	30	16	12,000
F258083	62	80	1 1/4"	16	12,000
F258100	80	100	30	30	12,000
F258103	80	100	1 1/4"	30	12,000



Blades and spare parts

Replacement TC knives and spares for the spiral planer heads.

N.B. All TC knives are priced and sold singly.

Part number	Description
F001014	TC knife for all planer heads
F002060	Clamp screw M5 x 8 csk.

Adjustable 50mm chamfer block with TC disposable inserts

A robust adjustable chamfering block suitable for jointing and chamfer cutting in all natural timbers and man made boards. The maximum adjustment is 90 degrees either side of the centre position and the cutting angle indexes in 7.5 degree steps with a reference scale to aid setting.

Manufactured to EN847-1/2 - suitable for HAND FEEDING.



Part number	Size			Body material	Maximum RPM
	dia.	height	bore		
F260140	140	50	30mm	Alloy	6,000
F260143	140	50	1 1/4"	Alloy	6,000



Replacement tungsten carbide knives

N.B. All blocks are supplied fitted with one set of knives and scribes.
All TC knives are priced and sold singly.

Part number	Knife size (mm)			For use with
F001050	50	12	1.5	50mm chamfer block

Adjustable 50mm chamfer block with TC disposable inserts

These heavy duty steel swop-tip® chamfering heads feature 50mm replaceable TC knives with scoring spurs at both ends of the knife.

The chamfer blade holders are adjusted by means of a knurled ring which simultaneously rotates both sides, keeping them synchronised by means of a geared mechanism. The cutting blades can be adjusted from the vertical downwards for 84 degrees or upwards for 48 degrees and are infinitely adjustable within this range. The arrangement of the cutter with spurs also allows the block to cut rebates either square or at an angle.

One rotation of the ring changes the angle by 10 degrees and the ring is marked in 10 graduations of 1 degree.

Manufactured to EN847-1/2 - suitable for HAND FEEDING.



Part number	Size			Body material	Maximum RPM
	dia.	height	bore		
F261960	165	50	30	Steel	8,300
F261963	165	50	1 1/4"	Steel	8,300

Replacement tungsten carbide knives

Replacement TC knives and scribes for use with these blocks.

N.B. All blocks are supplied fitted with one set of knives and scribes.
All TC knives are priced and sold singly.

Part number	Knife size (mm)			For use with
F001050	50	12	1.5	50mm chamfer block
F001014	14	14	2.0	50mm block scorer



Cabinet door profile block 5mm tongue with TC disposable inserts

A two wing cutter block in steel with easily replaceable TC profile inserts. The block will cut the profile and matching counter profile to produce joints for cabinet doors, panelling etc. in all solid timbers and man-made boards. The replaceable tips ensure consistent cutting performance with no sharpening necessary: simply replace the inserts when they become blunt. The block is supplied with a pair of profile knives fitted; additional knives may be purchased to change the profile. N.B. two knives are required which are priced singly.

The block is suitable for jointing material from 24 to 33mm in thickness, has a tongue and groove width of 5mm and a profile width of 15mm.

Manufactured to EN847-1/2 - suitable for HAND FEEDING.

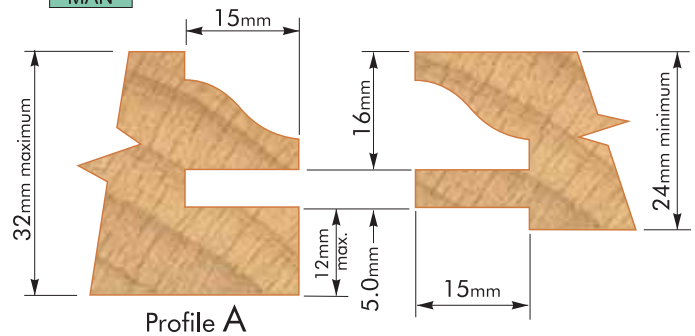

Full size cross sections of profiles

Part number	Size dia.	height	bore	Profile	Maximum RPM
F263510	140	53	30	A	8,000
F263513	140	53	1 1/4"	A	8,000
F263520	140	53	30	B	8,000
F263523	140	53	1 1/4"	B	8,000
F263530	140	53	30	C	8,000
F263533	140	53	1 1/4"	C	8,000
F263540	140	53	30	D	8,000
F263543	140	53	1 1/4"	D	8,000

Replacement TC knives

TC knives are priced and sold singly.

Part number	Profile
F001220	A
F001222	B
F001224	C
F001226	D

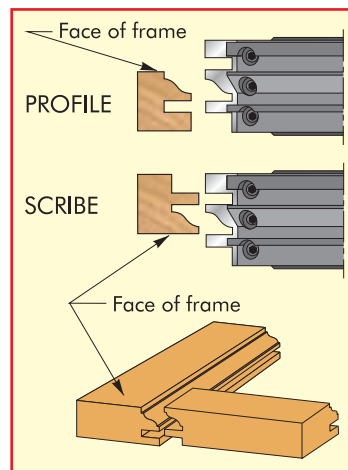

Profile B



Profile C

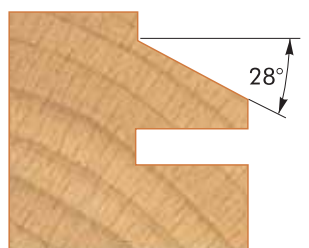

Profile D

Spare parts

Part number	Description
F003116	Wedge 38mm
F003128	Clamp screw M8
F003134	Hex key 4mm



Profile/counter profile block 6.5mm tongue with TC disposable inserts

A two wing steel cutter block with easily replaceable TC profile inserts. The block will cut the profile and matching counter profile to produce joints for cabinet doors, panelling etc. in all solid timbers and man-made boards. The replaceable tips ensure consistent cutting performance with no sharpening necessary: simply replace the inserts when they become blunt. The block is supplied with a pair of profile knives fitted; additional knives may be purchased to change the profile. N.B. two knives are required which are priced singly.

The block is suitable for jointing material from 24 to 32mm in thickness, has a tongue and groove width of **6.5mm** and a profile width of 15mm. A guide ring 110mm diameter is available to match this block - see page 47.

Manufactured to EN847-1/2 - suitable for HAND FEEDING.



Part number	Size dia.	height	bore	Profile	Maximum RPM
F263450	140	50	30	A	8,000
F263453	140	50	1 1/4"	A	8,000
F263460	140	50	30	B	8,000
F263463	140	50	1 1/4"	B	8,000
F263470	140	50	30	C	8,000
F263473	140	50	1 1/4"	C	8,000
F263480	140	50	30	D	8,000
F263483	140	50	1 1/4"	D	8,000

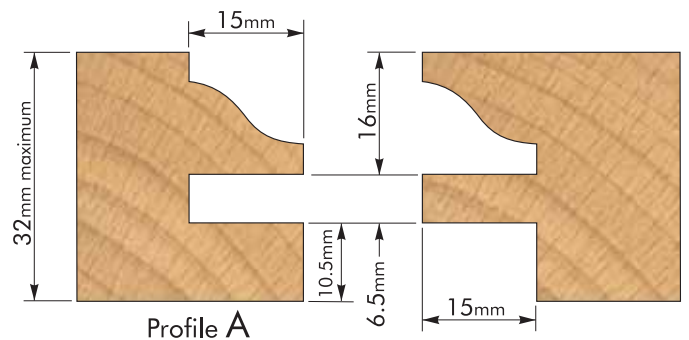

Full size cross sections of profiles

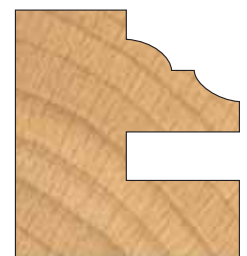

Profile B

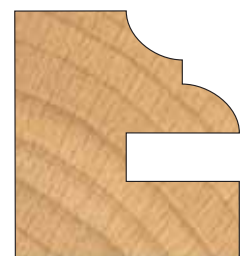

Profile C

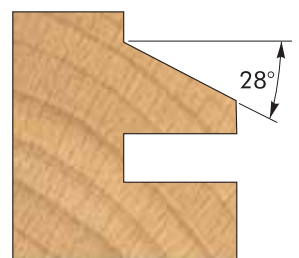

Profile D

Replacement TC knives

TC knives are priced and sold singly.

Part number	Profile
F001206	A
F001207	B
F001208	C
F001209	D

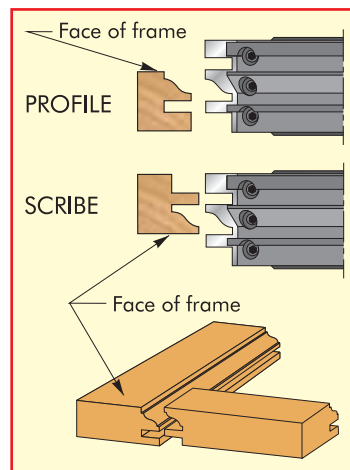

Spare parts

Part number	Description
F003116	Wedge 48mm
F003128	Clamp screw M8
F003134	Hex key 4mm
F002073	Adjusting screw



Panel raising taper block with tungsten carbide disposable inserts

A block with replaceable TC knives for machining traditional tapered raised panels. The body is in high tensile strength alloy and is fitted with two taper and two vertical reversible knives. The block is a top cut version which moulds the raise with the back of the panel flat on the table. This block works **OVER THE TOP OF THE PANEL**. Manufactured to EN847-1/2 - suitable for HAND FEEDING.



Part number	Size dia.	height	bore	Maximum RPM
F268200	200	35	30	6,600

Replacement tungsten carbide knives

TC knives are priced and sold singly.

Part number	Knife size (mm)
F000520	20 12 1.5
F000560	60 12 1.5

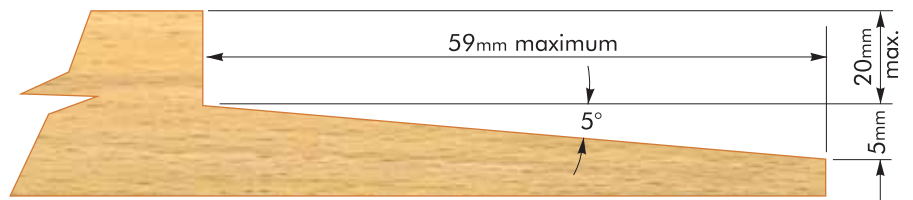

Multi profile panel raising cutter block

This multi profile block is manufactured from a hard wearing alloy and accepts a range of interchangeable knives and limitors. NB: Knives and limitors need to be ordered separately. All of the tool steel knives profiles 700 to 706 can be used on the same block, which will also produce a 45° chamfer with the timber run above the block. The block is supplied without knives. Recommended RPM: 4500-7000. Run this block clockwise for **TIMBER OVER – PANEL RAISING** and anticlockwise for **TIMBER UNDER – PANEL RAISING**.



Manufactured to EN847-1/2 - suitable for HAND FEEDING. Knives and limitors for this block will be found on page 40.

Part number	Size dia.	height	bore	Maximum RPM
F268150	160	48	30	7,000
F268153	160	48	1 1/4"	7,000

Spare parts

Part No.	Description
F003109	Wedge 38mm
F003127	Clamp screw M8

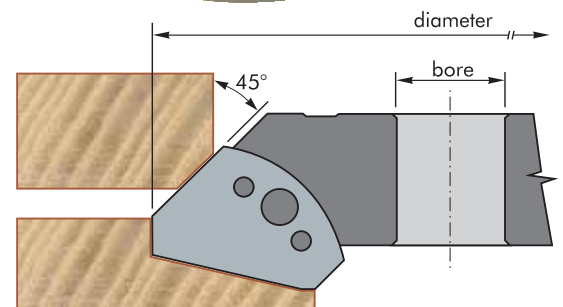

Panel raising tool steel knives and limitors

A range of tool steel knives for use in the multi profile panel raising block suitable for all natural timbers. Knives and limitors are sold in pairs. More profiles can be found on page 40.

Profiles are shown full size from the **FRONT** of the knife.

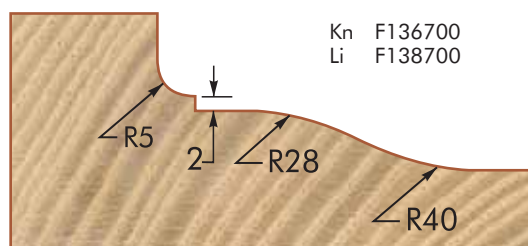

Kn F136700
Li F138700

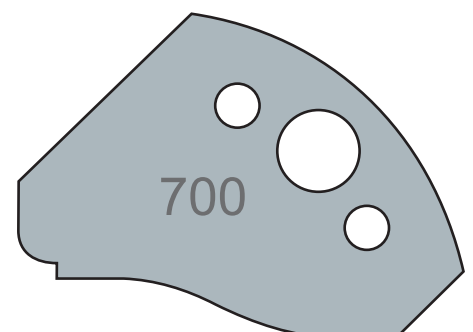

Alloy steel (SP) profile knives
(50 x 4mm)

Profiles are shown full size
from the **FRONT** of the knife

Panel raising tool steel knives and limitors

A range of tool steel knives for use in the multi profile panel raising block on page 39. These are suitable for machining all natural timbers. Knives and limitors are sold in pairs.

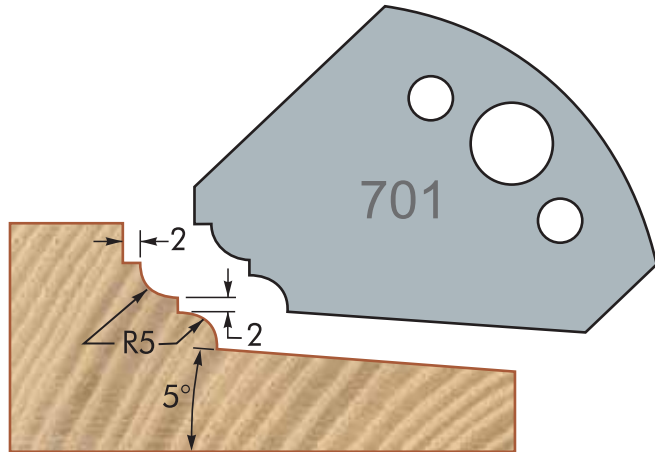

Kn F136701
Li F138701

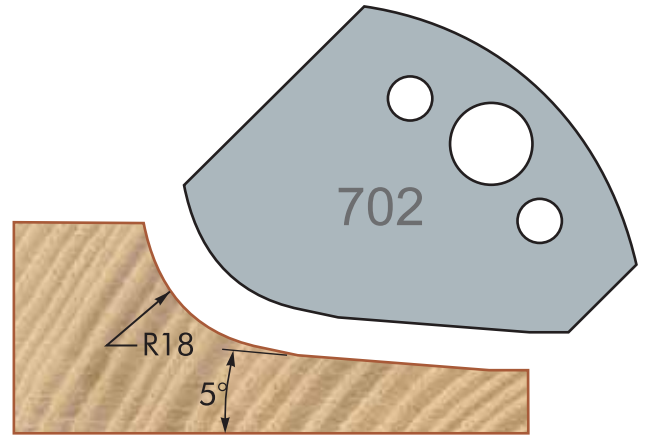

Kn F136702
Li F138702

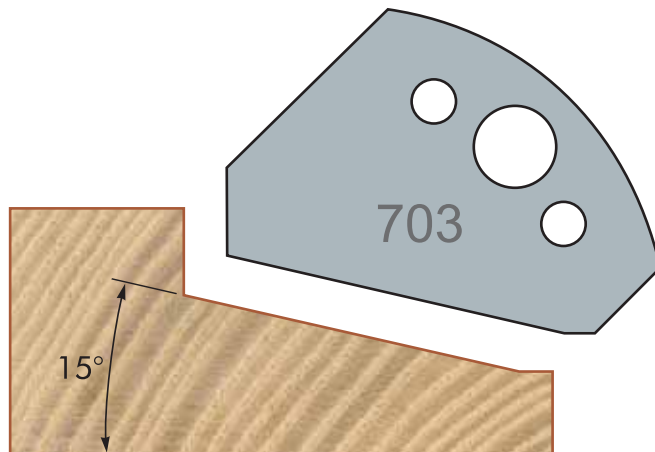

Kn F136703
Li F138703

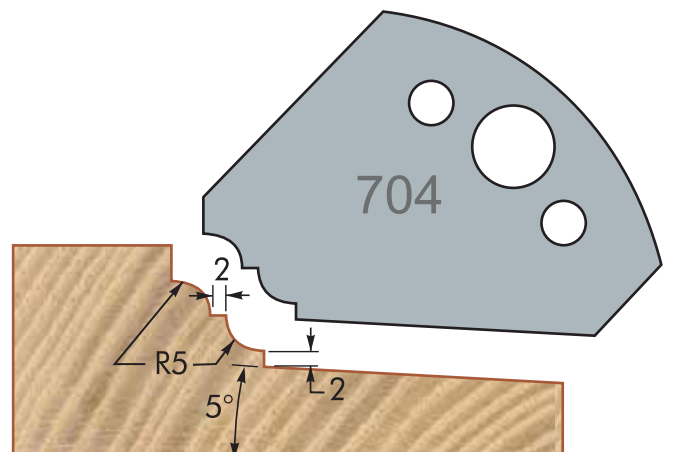

Kn F136704
Li F138704

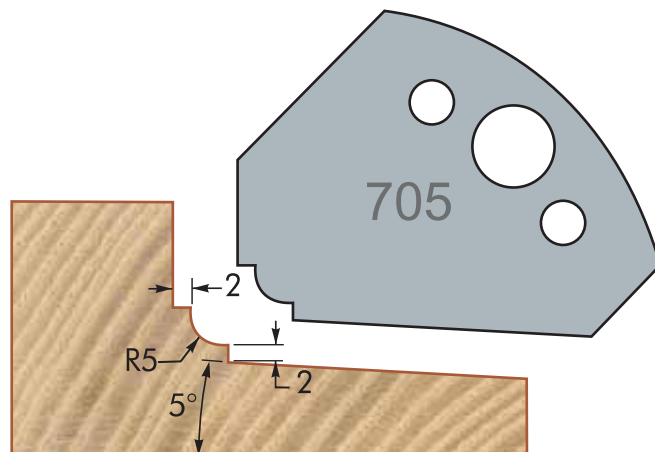

Kn F136705
Li F138705

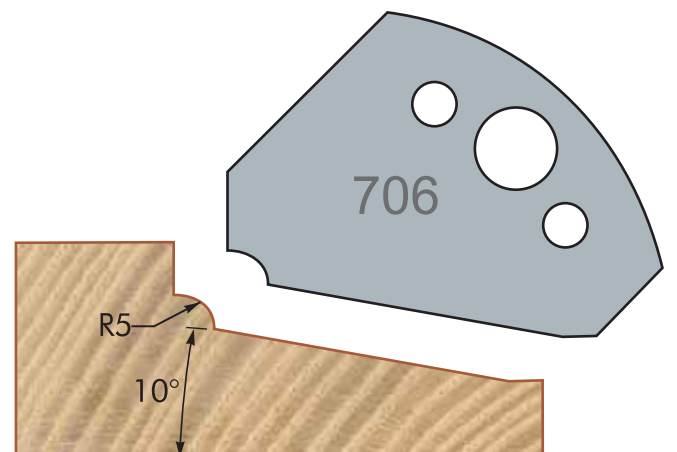

Kn F136706
Li F138706

Glue jointing block with tungsten carbide disposable inserts

A three wing cutter block in steel with easily replaceable TC inserts. The three knife design gives a superior finish to the work with extended blade life and in addition the blades are double sided so may be rotated. Suitable for producing longitudinal joints in soft wood, hard wood, plywood and all man made boards.

Manufactured to EN847-1/2 - suitable for HAND FEEDING.

Part number	Size			Body material	Maximum RPM
	dia.	height	bore		
F272130	125	60	30	Steel	8,800



Replacement tungsten carbide inserts

TC knives are priced and sold singly.

Part number	Knife size (mm)
F001301	50 12 1.5

Spare parts

Part No.	Description
F001310	Wedge 58mm
F003128	Clamp screw M8

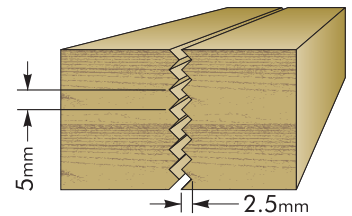

Mitre lock glue jointing block with TC disposable inserts

A two wing cutter block in hard wearing light metal alloy with easily replaceable TC inserts. The block is suitable for machining right angle and parallel joints in solid timber and man-made materials.

Manufactured to EN847-1/2 - suitable for HAND FEEDING.

Part number	Size			Body material	Maximum RPM
	dia.	height	bore		
F274140	140	40	30	Alloy	9,400
F274143	140	40	1-1/4"	Alloy	9,400



Blades and spare parts

TC knives are priced and sold singly.

Part number	Description
F001806	Blade lock mitre
F002044	Wedge 42mm
F003128	Clamp screw M8
F003134	Hex key 4mm

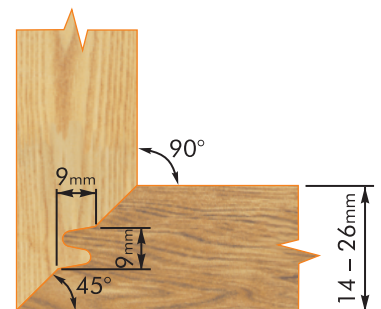
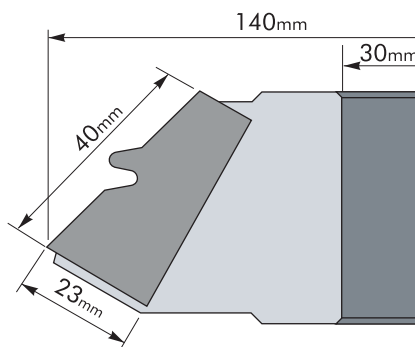

Glue finger jointing blocks with TC disposable inserts



A two wing cutter block with easily replaceable TC inserts. The replaceable tips ensure consistent cutting performance with no sharpening necessary: simply replace the inserts when they become blunt. Suitable for producing "finger style" reversible glue joints in softwood, hardwood, plywood and all man made boards. Supplied with two TC knives.

STOCK THICKNESS RANGE: 28mm – 58mm

Recommended speed range 5,900-9,000 RPM.

Manufactured to EN847-1/2 - suitable for HAND FEEDING.

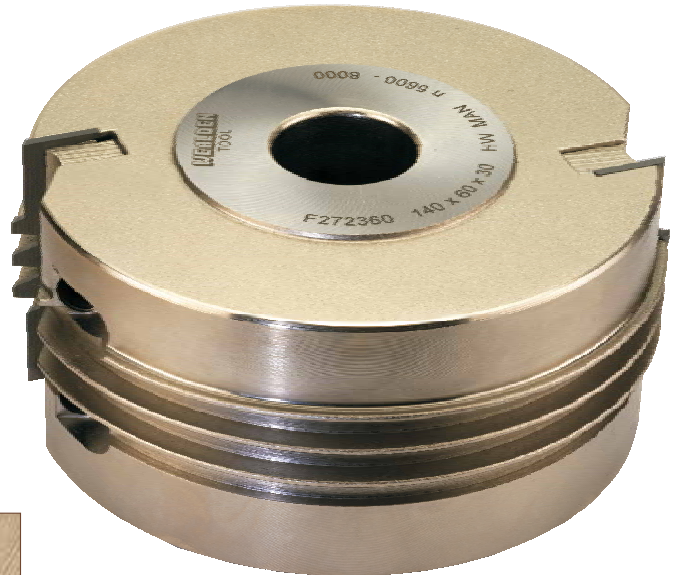

Part number	Size			Body material	Maximum RPM
	dia.	height	bore		
F272360	140	60	30	Steel	9,000

Blades and spare parts

Priced and sold singly.

Part number	Description
F001860	TC blade 60mm - 3 finger
F002055	Clamp screw M6 x 16

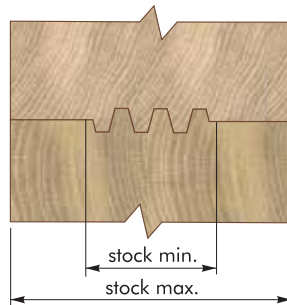

Sanding drum

A compact sanding drum for use on a spindle moulder.

N.B. For right hand (clockwise) rotation only.

These drums use sheet abrasive which is held securely with a firm clamping action. Takes 80mm wide abrasive paper.

Part number	Size			Maximum paper width	Body material	Maximum RPM
	dia.	height	bore			
F259590	45	100	30	80mm	Alloy	4,500
F259600	60	100	30	80mm	Alloy	4,500
F259603	60	100	1 ¼"	80mm	Alloy	4,500
F259800	80	100	30	80mm	Alloy	4,500
F259803	80	100	1 ¼"	80mm	Alloy	4,500



Sanding roll

Part number	Description
JD50080080	50m roll x 80mm wide - 80 grit



Adjustable Tenon/groover set with TC disposable inserts

A set of two Swop-tip® TC replaceable knife blocks with spacer shims to cut both halves of tenon joints. The bodies are in steel and the supplied shim set allows adjustment from 8mm to 15mm. The cutters are fitted with 4 scoring blades and 4 knives. This set enables the production of tenon/slot joints to suit varying panel thicknesses to a high level of precision. Produces a very good quality cut in all timber and boards..

Manufactured to EN847-1/2 - suitable for HAND or MECHANICAL FEED.

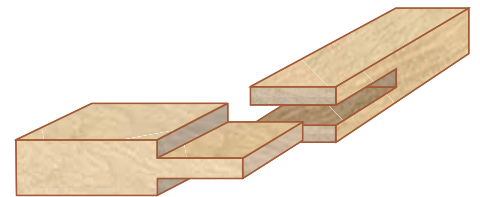
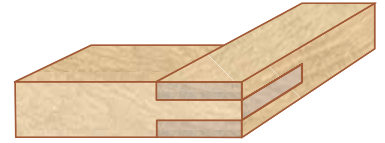

Part number	Size			L1 - max Tenon length	Tenon / groove	RPM range
	D dia.	height	bore			
F253320	200	22-30	30	65mm	8-15mm	3000 - 5200
F253130	250	22-30	30	90mm	8-15mm	3000 - 5200
F253350	250	22-30	1-1/4"	90mm	8-15mm	3000 - 5200

Blades and spare parts

TC knives are priced and sold singly.

Part number	Description
F000451	TC knife 7.65 x 12 x 1.5
F001014	TC scoring knife 14 x 14 x 2
F003102	Clamp wedge 6.8mm
F002062	Clamp wedge M5 x 18 taper
F002066	Knife retaining screw M5 x 7

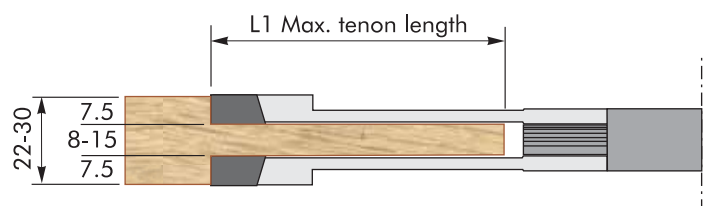
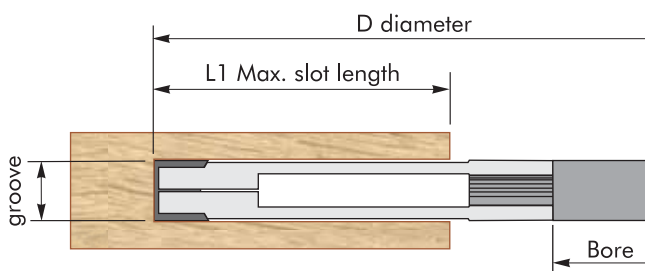



Grooving cutters 120mm

A range of cutters with hard wearing steel bodies with 6 fixed TC tips. The cutter is suitable for grooving in soft and hard woods as well as man-made and bonded boards.

Can be used with spacer rings (see page 52) for comb jointing. Manufactured to EN847-1/2 - suitable for HAND FEEDING.

Part number	Groove width (A)	Size			Maximum groove depth (B)	Speed range RPM
		dia.	height	bore		
F400040	4.0	120	4	30	30	5600 - 8000
F400050	5.0	120	5	30	30	5600 - 8000

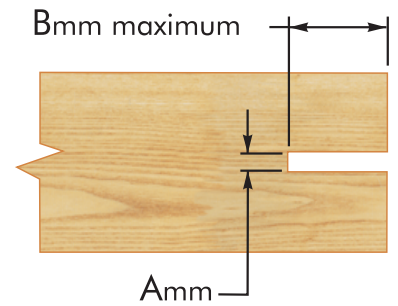

Grooving cutters 140mm

A range of cutters with hard wearing steel bodies with 6 fixed TC tips. The cutter is suitable for grooving in soft and hard woods as well as man-made and bonded boards.

Can be used with spacer rings (see page 52) for comb jointing. Manufactured to EN847-1/2 - suitable for HAND FEEDING.

Part number	Groove width (A)	Size			Maximum groove depth (B)	Speed range RPM
		dia.	height	bore		
F410040	4.0	140	4	30	35	5600 - 8000
F410050	5.0	140	5	30	35	5600 - 8000
F410060	6.0	140	6	30	35	5600 - 8000
F410080	8.0	140	8	30	35	5600 - 8000
F410100	10.0	140	10	30	35	5600 - 8000
F410120	12.0	140	12	30	35	4900 - 8000
F410140	14.0	140	14	30	35	4900 - 8000
F410160	16.0	140	16	30	35	4900 - 8000

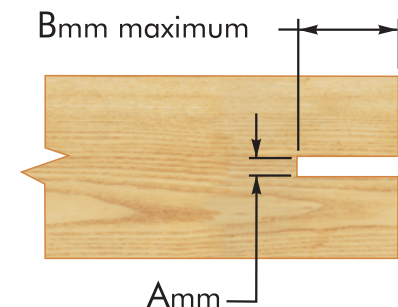

Grooving cutters with disposable TC tips

A range of replaceable tip cutters with hard wearing steel bodies. The groovers are fitted with 4 replaceable TC tips and 4 replaceable scribes. The cutter is suitable for production grooving in soft and hard woods as well as man-made and bonded boards.

The replaceable tips and scribes ensure constant cutting performance and a quality finish on all solid timbers and man-made boards.

Manufactured to EN847-1/2 - suitable for HAND FEEDING.



Part number	Groove width (A)	Size			Maximum groove depth (B)	Speed range RPM
		dia.	height	bore		
F422040	4.0	150	4	30	45	5,200 - 8,900
F422043	4.0	150	4	1¼"	45	5,200 - 8,900
F422050	5.0	150	5	30	45	5,200 - 8,900
F422060	6.0	150	6	30	45	5,200 - 8,900
F422063	6.0	150	6	1¼"	45	5,200 - 8,900
F422080	8.0	150	8	30	45	5,200 - 8,900
F422083	8.0	150	8	1¼"	45	5,200 - 8,900
F422100	10.0	150	10	30	45	5,200 - 8,900
F422103	10.0	150	10	1¼"	45	5,200 - 8,900
F422120	12.0	150	12	30	45	5,200 - 8,900
F422123	12.0	150	12	1¼"	45	5,200 - 8,900
F423040	4.0	180	4	30	55	4,200 - 7,200
F423050	5.0	180	5	30	55	4,200 - 7,200
F423060	6.0	180	6	30	55	4,200 - 72,00
F423080	8.0	180	8	30	55	4,200 - 7,200
F423100	10.0	180	10	30	55	4,200 - 7,200
F423120	12.0	180	12	30	55	4,200 - 7,200

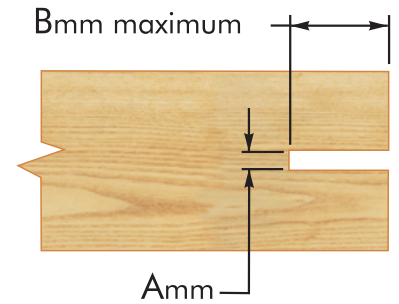

Blades and spare parts

TC knives are priced and sold singly.

Groover width	4mm	5mm	6mm	8mm	10mm	12mm
	Part No.	Part No.	Part No.	Part No.	Part No.	Part No.
TC blade	F000455	F000460	F000461	F000450	F000452	F000454
TC Scribe	F000470	F000470	F000470	F001014	F001014	F001014
Wedge				F002087	F002089	F002091
Clamp screw				F002050	F002050	F002050
Scribe blade screw	F002080	F002093	F002095	F002065	F002065	F002065
Allen key				K25	K25	K25
Torx key	F002085	F002085	F002085	F002090	F002090	F002090



Adjustable grooving cutters with TC disposable inserts

A range of adjustable groovers with replaceable TC tips with either 2 or 3 piece steel bodies. With the spacer rings supplied the heads can be adjusted in 0.1mm steps to produce groove widths in the range shown below. The 3 piece body cutters can also be used without the central cutter in a 2 piece arrangement giving a wide adjustment range. The cutters are suitable for cutting grooves in soft and hard woods as well as man made, bonded, and veneered boards.

Manufactured to EN847-1/2 - suitable for HAND FEEDING.

Part number	Groove width	Size		Max groove depth	Body type	Speed range RPM
		dia.	bore			
F433200	5.0 - 14.5	120	30	28	3 piece	5,000 - 10,000
F431250	4.0 - 14.0	150	30	30	3 piece	5,000 - 8,000
F431253	4.0 - 14.0	150	1 1/4"	30	3 piece	5,000 - 8,000
F431370	12.5 - 23.0	200	30	65	2 piece	4,000 - 6,000
F431380	8.0 - 30.0	180	30	55	3 piece	4,300 - 6,200
F431383	8.0 - 30.0	180	1 1/4"	55	3 piece	4,300 - 6,200



Blades and spare parts

TC knives are priced and sold singly.

Block part number	F433200 Part No.	F431250/3 Part No.	F431370 Part No.	F431380/3 Part No.
TC top & bottom blade	F000461	F000455		F000453
TC centre blade	F000452	F000450	TK12	F000515
TC scribe	F001014	F000470	F001014	F001014
Wedge	F002018	F002021	F002025	F002021
Clamp screw	F002050	F002050	F002050	F002050
Countersunk screw	F002081	F002080	F002060	F002065
Allen key	K25	K25	K25	K25



Micro adjustable grooving cutter with TC disposable inserts

A 2 piece steel cutterhead infinitely adjustable over the range of 4 to 7.5mm by means of a threaded bush. The scale on the bush allows setting to an accuracy of 0.1mm and adjustment may be made without removing the cutter from the spindle. The maximum cutting depth is 45mm. The cutter is suitable for cutting grooves in soft and hard woods as well as man made, bonded and veneered boards. Manufactured to EN847-1/2 - suitable for HAND FEEDING.

Part number	Size			Body material	Maximum RPM
	dia.	height	bore		
F432180	180	4-7.5	30	Steel	7,300
F432183	180	4-7.5	1 1/4"	Steel	7,300



Blades and spare parts

Priced and sold singly.

Part number	Description
F000455	Top and bottom blade
F000470	Scribe
F002080	Countersunk Torx screw
F002085	Torx key T9

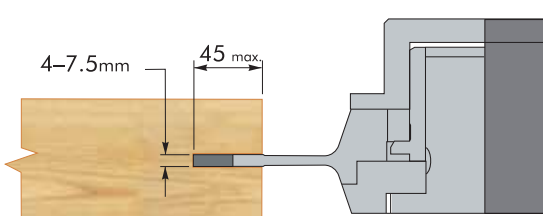

Ball bearing guide rings

A range of guide rings in hard wearing aluminium alloy which are used in conjunction with a ball bearing and security ring to produce ball bearing guide assemblies with diameters from 75mm to 150 mm.

Part number	Size			Description
	dia.	thickness	bore	
F310075	75	16	62	Guide ring
F310080	80	16	62	Guide ring
F310085	85	16	62	Guide ring
F310090	90	16	62	Guide ring
F310095	95	16	62	Guide ring
F310098	98	16	62	Guide ring
F310100	100	16	62	Guide ring
F310105	105	16	62	Guide ring
F310110	110	16	62	Guide ring
F310115	115	16	62	Guide ring
F310120	120	16	62	Guide ring
F310125	125	16	62	Guide ring
F310130	130	16	62	Guide ring
F310135	135	16	62	Guide ring
F310062	62	16	30	Ball bearing
F310063	62	16	1¼"	Ball bearing
F310030	78	16	30	Security ring
F310033	78	16	1¼"	Security ring



A complete bearing assembly is made up of a guide ring (F310075 – F310135), a ball bearing (F310062 or F310063) and a steel security ring (F310030 or F310033), to prevent the guide ring from rising.

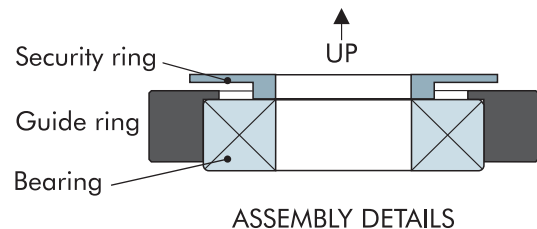

Reducer bushes

Top hat type reducer bushes for converting cutter blocks to fit on smaller spindles. The bushes are priced and sold singly, but you will need two to convert a block: one bush fitted in each end of the block bore. You should ensure that the spindle is suitable for the weight of the block you are mounting.

Part number	A block bore	B spindle dia.	C depth	D flange dia.
FB1003	30mm	0.75"	6mm	50mm
FB1005	30mm	1.00"	6mm	50mm
FB1007	1.250"	30mm	5mm	55mm
FB1009	40mm	35mm	5mm	57mm
FB1011	50mm	30mm	6mm	78mm

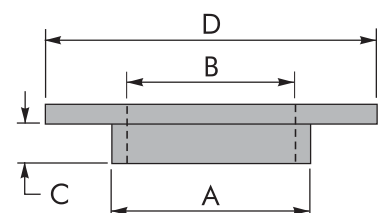

Beading cutter block with TC disposable inserts

A range of Swop-tip® steel blocks with replaceable tungsten carbide knives. These 3 knife blocks offer a superior finish and faster cutting rate when compared to 2 knife blocks. The cutters are suitable for producing beads, bullnose moulds etc. in soft and hard woods as well as man made, bonded, and veneered boards.



Manufactured to EN847-1/2 - suitable for HAND FEEDING.

Part number	Radius (R)	Size			Speed range RPM
		dia.	height	bore	
F288030	3.0	140	15	30	5,600 - 8,000
F288040	4.0	140	30	30	5,600 - 8,000
F288050	5.0	140	30	30	5,600 - 8,000
F288060	6.0	140	25	30	5,600 - 8,000
F288075	7.5	140	25	30	5,600 - 8,000
F288100	10.0	140	30	30	5,600 - 8,000
F288120	12.0	140	30	30	5,600 - 8,000

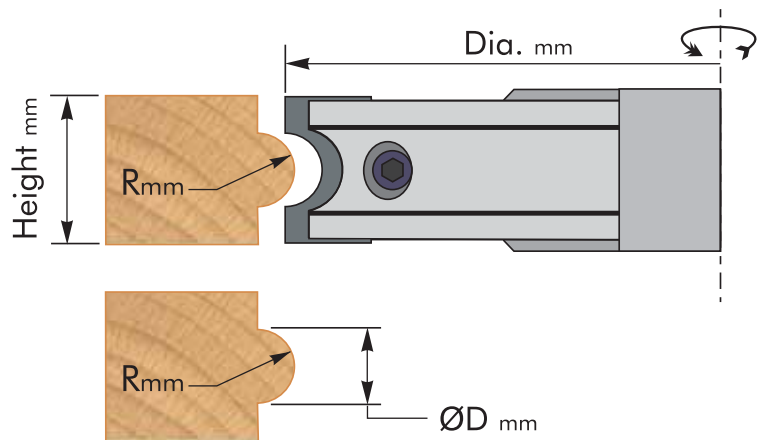

Blades and spare parts

TC knives are priced and sold singly.

Radius (R)	Block part number	TC blade Part No.	Wedge Part No.	Clamp screw Part No.	Allen key Part No.
3.0	F288030	F003360	F003380	F003128	F003134
4.0	F288040	F003362	F003382	F003128	F003134
5.0	F288050	F003364	F003382	F003128	F003134
6.0	F288060	F003366	F003384	F003128	F003134
7.5	F288080	F003367	F003384	F003128	F003134
10.0	F288100	F003369	F003386	F003128	F003134
12.0	F288120	F003370	F003386	F003128	F003134



Radius profile block with TC disposable inserts



A range of Swop-tip® blocks in steel with replaceable STC knives. The 3 knife design gives a superior finish to the work whilst giving an extended blade life. The cutters are suitable for machining radius grooves, coves, drip grooves etc. in soft and hard woods as well as man made, bonded, and veneered boards.

Manufactured to EN847-1/2 - suitable for HAND FEEDING.



Part number	Radius (R)	Size dia.	height	bore	Body material	Maximum groove depth	Speed range RPM
F287060	6.0	140	12	30	Steel	34	5,600 - 8,000
F287075	7.5	140	15	30	Steel	34	5,600 - 8,000
F287100	10.0	140	20	30	Steel	34	5,600 - 8,000

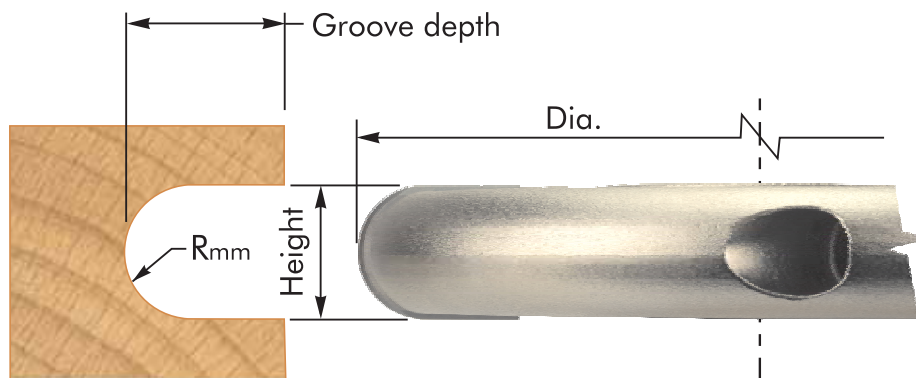

Blades and spare parts

TC knives are priced and sold singly.

Radius (R)	Block part number	TC blade Part No.	Wedge Part No.	Clamp screw Part No.	Allen key Part number
6.0	F287060	F003320	F003350	F003128	F003134
7.5	F287075	F003325	F003353	F003128	F003134
10.0	F287100	F003030	F003356	F003128	F003134



Cove radius block with TC disposable inserts



A range of Swop-tip® steel blocks with replaceable tungsten carbide knives. These 3 knife blocks offer a superior finish and faster cutting rate when compared to 2 knife blocks. The cutters are suitable for producing cove mouldings etc. in soft and hard woods as well as man made, bonded, and veneered boards.

Manufactured to EN847-1/2 - suitable for HAND FEEDING.



Part number	Radius (R)	Size dia.	height	bore	Body material	Speed range RPM
F280120	12.0	140	20	30	Steel	5,600 - 8,000
F280200	20.0	140	30	30	Steel	5,600 - 8,000
F280203	20.0	140	30	1¼"	Steel	5,600 - 8,000

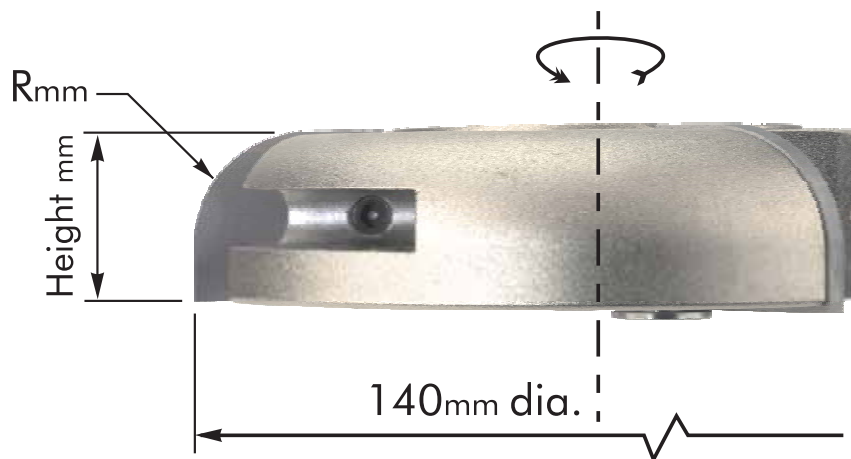
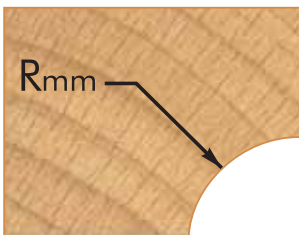

Blades and spare parts

Knives & spares are priced and sold singly.

Radius (R)	Block part number	TC blade Part No.	Wedge Part No.	Clamp screw Part No.	Allen key Part number
12.0	F280120	F003374	F003356	F003128	F003134
20.0	F280200	F003376	F003386	F003128	F003134
20.0	F280203	F003376	F003386	F003128	F003134

Espagnolette lock groove cutter with replaceable TC tips

A heavy duty block in high tensile alloy with replaceable TC knives and scribes. A rebated groove is formed in one pass to enable the fitting of the espagnolette locking bar.

The espagnolette locking system offers many advantages over the traditional latch/lock systems on timber windows and doors. The block is supplied fitted with a set of replaceable knives.

Manufactured to EN847-1/2 - suitable for HAND FEEDING.

Part number	Size dia.	height	bore	Body material	Speed range RPM
F440160	180	16.3	30	Steel	4000 – 7,500
F440163	180	16.3	1¼"	Steel	4000 – 7,500
F440260	180	20.3	Steel	4000 – 7,500	
F440263	180	20.3	1¼"	Steel	4000 – 7,500

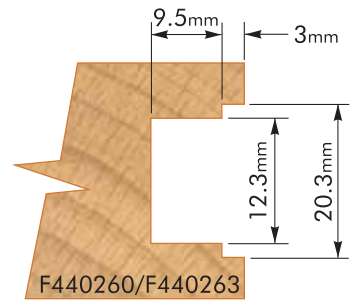
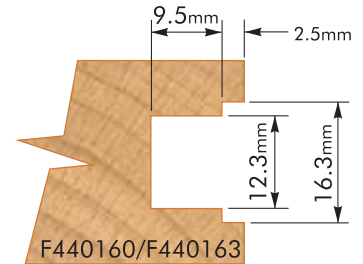

Blades and spare parts

TC knives are priced and sold singly.

Part number	Description
F002801	Blade 16.3mm – single
F002802	Blade 20.3mm – single
F001014	Scribe blade – single
F002028	Wedge 13.5mm
F002015	Wedge 17.5mm
F002055	Clamp screw M6
F002060	Countersunk screw M5
F003133	Hex key 3mm
F002100	Torx key T25



Spacer rings

High quality, steel spacer rings with pin holes. Suitable for use with adjustable cutters. May be used for spacing groovers to achieve intermediate sizes.

Set comprises:	Thickness	Quantity
	2.0mm	2
	1.0mm	2
	0.5mm	1
	0.2mm	2
	0.1mm	1

Part number	Description
F600800	Set of 8 spacers (7mm total)





THE WEALDEN WEBSITE AND ONLINE STORE
 The website has more information on our range of spindle tooling. You will also find online catalogues and ordering for all products, including our range of router cutters and drilling tooling.
www.wealdentool.com

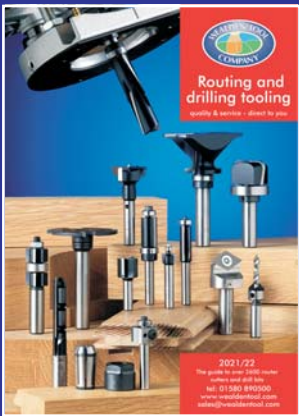

© 2021 Wealden Tool Company Limited. No part of this publication may be transmitted or reproduced by any means without our express permission. All rights reserved. Every effort is made to ensure the accuracy of information contained in this catalogue but specifications and prices may change without notice. E & O E. Wealden Tool Company cannot be held liable for consequential loss. All trademarks acknowledged.



Wealden Tool Company
 2 Clinton Business Centre, Lodge Road
 Staplehurst, Kent TN12 0QF
 Tel : 01580 890500 Fax: 01580 890222
sales@wealdentool.com
www.wealdentool.com